

SURVEYOR'S CERTIFICATE

I HEREBY CERTIFY THAT TO THE BEST OF MY KNOWLEDGE AND BELIEF THAT THIS PLAT WAS PREPARED IN ACCORDANCE WITH THE STANDARDS ESTABLISHED BY THE VIRGINIA BOARD FOR ARCHITECTS, PROFESSIONAL ENGINEERS, LAND SURVEYORS, CERTIFIED INTERIOR DESIGNERS AND LANDSCAPE ARCHITECTS.



1-28-02 DATE, Stephen Rowe NAME

GRANTOR'S CERTIFICATE

THIS PLAT ACCURATELY DEPICTS THE DESIRES OF THE UNDERSIGNED OWNER.

1/15/02 DATE, Powhatan Enterprises, Inc. by Patricia M. Pencei NAME

CERTIFICATE OF NOTARIZATION

STATE OF Virginia, County of James City

I, Patricia M. Pencei, A NOTARY PUBLIC IN AND FOR THE COUNTY AND STATE AFORESAID, DO HEREBY CERTIFY THAT THE PERSON WHOSE NAME IS SIGNED TO THE FOREGOING WRITING HAS ACKNOWLEDGED THE SAME BEFORE ME IN COUNTY AND STATE AFORESAID.

GIVEN UNDER MY HAND THIS 25th DAY OF January, 2002.

NOTARY PUBLIC MY COMMISSION EXPIRES: June 30, 2002

Signature of Patricia M. Pencei

CERTIFICATE OF APPROVAL

IN THE CLERK'S OFFICE OF THE CIRCUIT COURT THE PLAT SHOWN HEREON WAS PRESENTED AND ADMITTED TO RECORD THIS 19th DAY OF March, 2002 AS THE LAW DIRECTS. @ 4:00 PM

CLERK: Betsy B. Woolridge

PLAT BOOK: 85 PAGE: 53

DRAINAGE EASEMENT CONVEYED TO CENTEX HOMES BY POWHATAN ENTERPRISES, INC. BERKELEY DISTRICT JAMES CITY COUNTY, VIRGINIA SCALE: 1"=50' DATE: 1/14/02

SHEET 1 OF 1



Engineers • Planners • Surveyors Landscape Architects • Environmental Consultants 4029 Ironbound Road, Suite 100 Williamsburg, VA 23188 Tel. (757) 253-2975 Fax (757) 229-0049 Email: lmdg@landmarkdgb.com

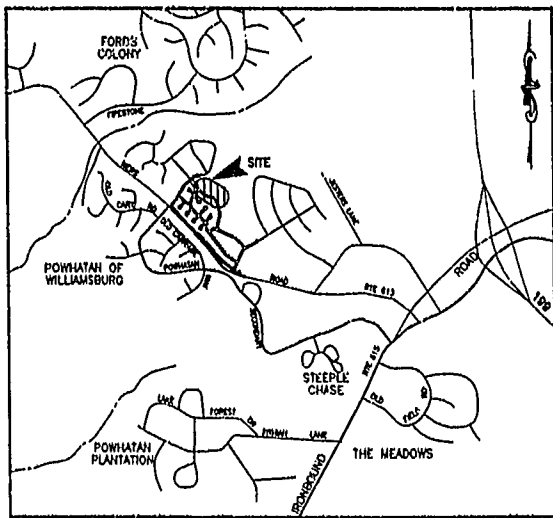
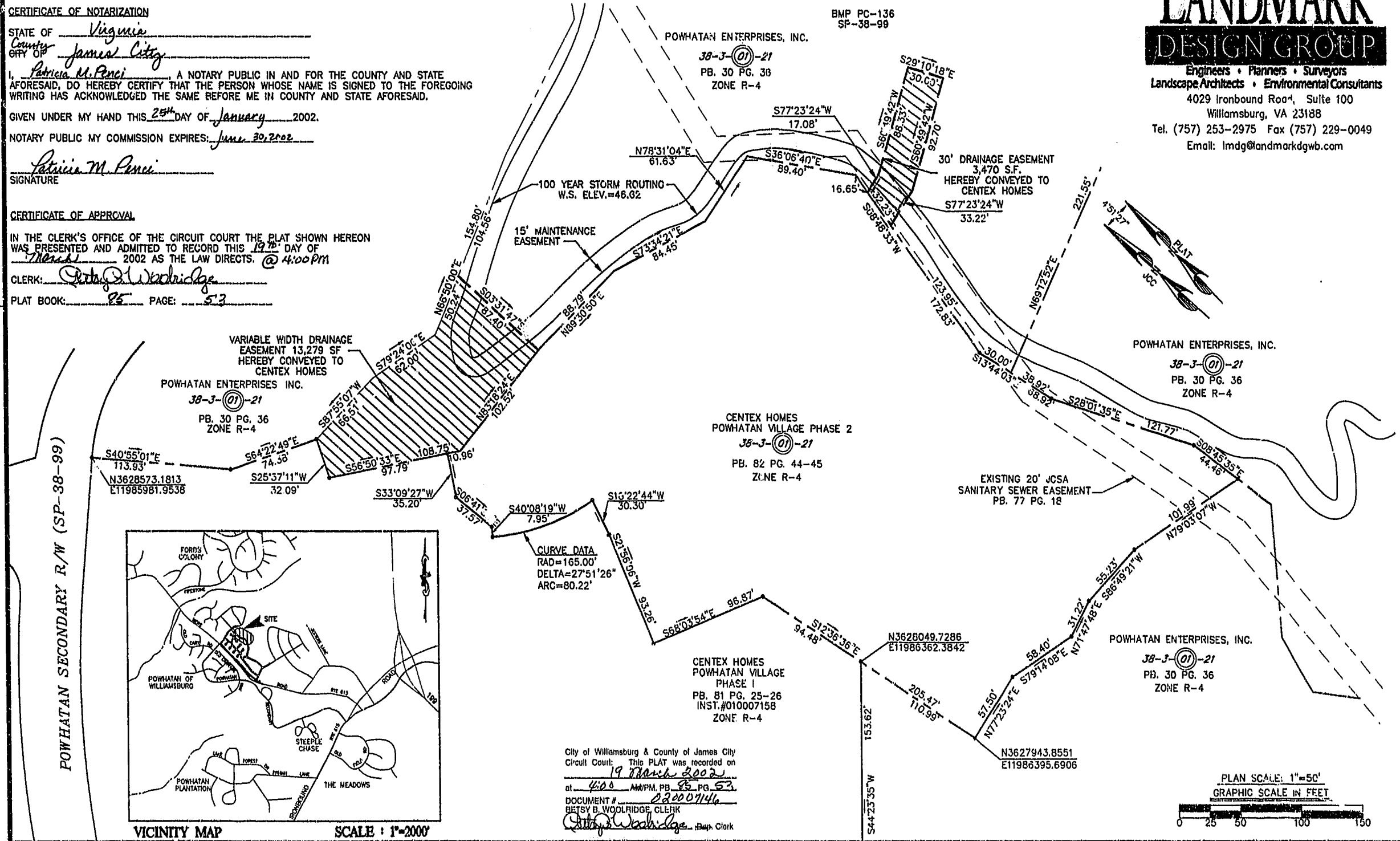

VICINITY MAP SCALE: 1"=2000'

CURVE DATA RAD=165.00' DELTA=27°51'26" ARC=80.22'

City of Williamsburg & County of James City Circuit Court: This PLAT was recorded on 19 March 2002 at 4:00 AM/PM, PB. 85, PG. 53. DOCUMENT # 020007146 BETSY B. WOOLRIDGE, Clerk