

(FIRST FLOOR) (SECOND FLOOR)

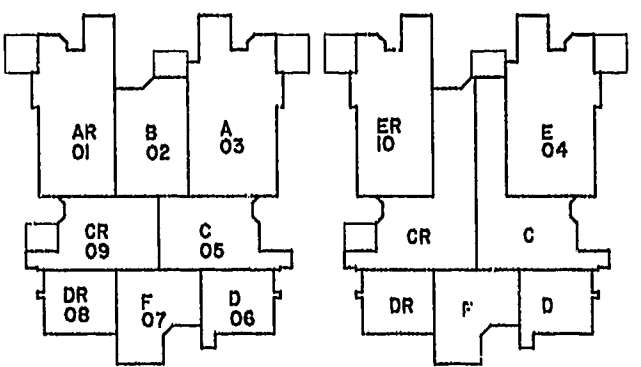

TYPICAL CONDOMINIUM LAYOUT

T.P. 372-(04)-00-00-A2
 NOW OR FORMERLY
 CITY OF WILLIAMSBURG
 (D.B. 121, PG. 321)
 (M.B. 36, PG. 77)

City of Williamsburg & County of James City
 Circuit Court: This PLAT was recorded on
30 Aug 2001
 at *2:53* PM, PB *83 PG 14-17*
 DOCUMENT # *211341*
 BETSY B. WOOLRIDGE, CLERK
Betsy Woolridge Dep. Clerk



BRISTOL COMMONS
 A CONDOMINIUM COMMUNITY
 PHASE TWELVE
 FOR
 KEY GROUP, LLC
 CITY OF WILLIAMSBURG, VIRGINIA

Hassell & Polkes, P.C. Engineers Surveyors Planners Chesapeake, VA 23320 (757)547-9831	SIZE C	CONTRACT NO 90062	DISK/BOX 123J/15	FILENAME BRISTOL12.DWG	REV.
	SCALE: 1" = 50'		DATE: 08/20/01	SHEET 3 of 4	