

LINE TABLE

LINE	BEARING	LENGTH
L1	N88°44'33"E	191.53
L2	N36°19'42"W	71.14
L3	S53°40'18"W	54.88
L4	N80°42'01"W	40.53
L5	S18°38'42"W	45.22
L6	S64°18'38"E	84.46
L7	S68°36'37"W	55.30
L8	S45°27'26"W	90.90
L9	S70°52'56"W	31.46
L10	S58°35'28"W	61.19
L11	S27°10'56"W	57.01
L12	N75°43'23"W	55.53
L13	S58°08'14"W	94.10
L14	N39°39'10"W	37.48
L15	S50°20'50"W	93.66
L16	N39°39'10"W	86.67
L17	N50°20'50"E	138.79
L18	N71°51'42"E	22.97
L19	N53°40'18"E	306.18
L20	N36°19'42"W	52.74
L21	N68°44'33"E	177.95

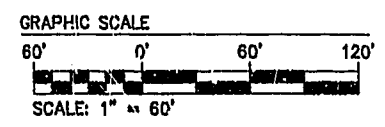

NOTE:
 JAMES CITY COUNTY COORDINATES REFERENCED ON THIS PLAT ARE BASED UPON JAMES CITY COUNTY CONTROL MONUMENT #302.

NOTE:
 A FIVE FOOT LANDSCAPE EASEMENT IS HEREBY DEDICATED TO THE HOMEOWNER'S ASSOCIATION ALONG THE RIGHT OF WAY OF ALL ROADS IN SECTION ONE EXCEPT IN THOSE AREAS SHOWN TO BE EASEMENTS DEDICATED TO THE JCSA IN WHICH CASE THE SAID FIVE FOOT IS TO BE ADJACENT TO THE JCSA EASEMENT.

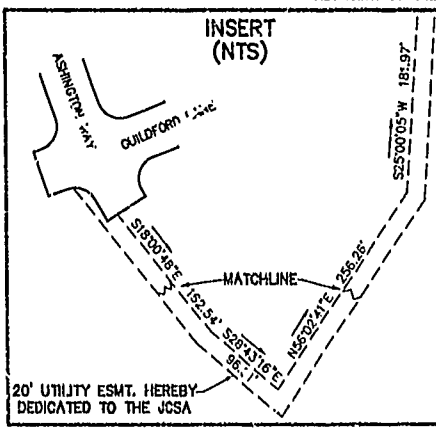

R/W CURVE TABLE

NO.	DELTA	RADIUS	LENGTH	TANGENT	CHORD	CH. BEARING
C1	90°00'00"	25.00	39.27	25.00	35.36	S37°34'19"E
C2	60°00'00"	50.00	52.36	28.87	50.00	N68°25'41"E
C3	240°00'00"	50.00	209.44	85.60	36.60	N71°34'19"W
C4	82°47'14"	300.00	433.47	264.43	396.74	N19°49'18"E
C5	50°54'22"	300.00	266.54	142.79	257.86	S65°45'44"W
C6	9°28'19"	650.00	107.46	53.85	107.34	S03°41'32"W
C7	182°47'14"	250.00	361.22	220.35	330.61	N49°49'18"E

LOT CURVE TABLE

LOT NO.	DELTA	RADIUS	LENGTH	TANGENT	CHORD	CH. BEARING
10	67°40'06"	50.00	59.05	33.52	55.68	N23°43'44"E
11	40°51'54"	50.00	35.66	18.63	34.91	N77°59'44"E
12	90°00'00"	25.00	39.27	23.00	35.36	N53°25'41"E
13	31°52'52"	300.00	106.93	85.69	164.78	N24°22'07"E
19	19°32'12"	250.00	85.24	43.04	84.63	S18°11'47"W
20	35°08'50"	250.00	153.36	79.18	150.97	S45°32'18"W
21A	28°06'12"	250.00	122.62	62.57	121.40	S77°09'49"W
21B	87°44'27"	25.00	38.28	24.03	34.65	N44°54'52"W
21C	9°28'19"	650.00	107.46	53.85	107.34	N03°41'32"E

NOTE:
 THE PROPERTY IS SUBJECT TO THE DECLARATION OF COVENANTS, CODES, AND RESTRICTIONS MADE ON FEBRUARY 28, 2000

NOTE:
 ASHINGTON WAY AND GUILDFORD LANE ARE THROUGH STREETS THAT SHALL BE EXTENDED TO PROVIDE ACCESS TO AND FROM FUTURE DEVELOPMENT

SEE SHEET NO. 3

THIS SHEET ADDRESSES LOTS 10-13 AND 17-25.

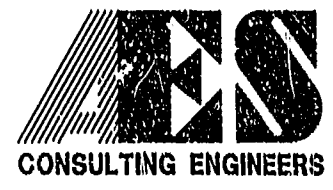

5248 Olde Towne Road, Suite 1
 Williamsburg, Virginia 23188
 (757) 253-0040
 Fax (757) 220-8994

PLAT OF SUBDIVISION AND LOT LINE EXTINGUISHMENT
WELLINGTON SECTION ONE
 LOTS 1-48
 BEING THE PROPERTY OF WELLINGTON, L.L.C.
 STONEHOUSE DISTRICT JAMES CITY COUNTY VIRGINIA



City of Williamsburg & County of James City Circuit Court: This PLAT was recorded on October 4, 2001 at 1:55 AM PM PB#3 PG#15-219 DOCUMENT # 010018136 Betsy B. Woolridge, Clerk

No.	DATE	REVISION / COMMENT / NOTE	BY
2	10/11/01	REVISED PER COUNTY COMMENTS	JFS
1	4/11/01	REVISED PER COUNTY COMMENTS	JFS

Designed HWP	Drawn JFS
Scale 1"=10'	Date 3/9/01
Project No. 8223-2	
Drawing No. 4 OF 5	