

3220100094

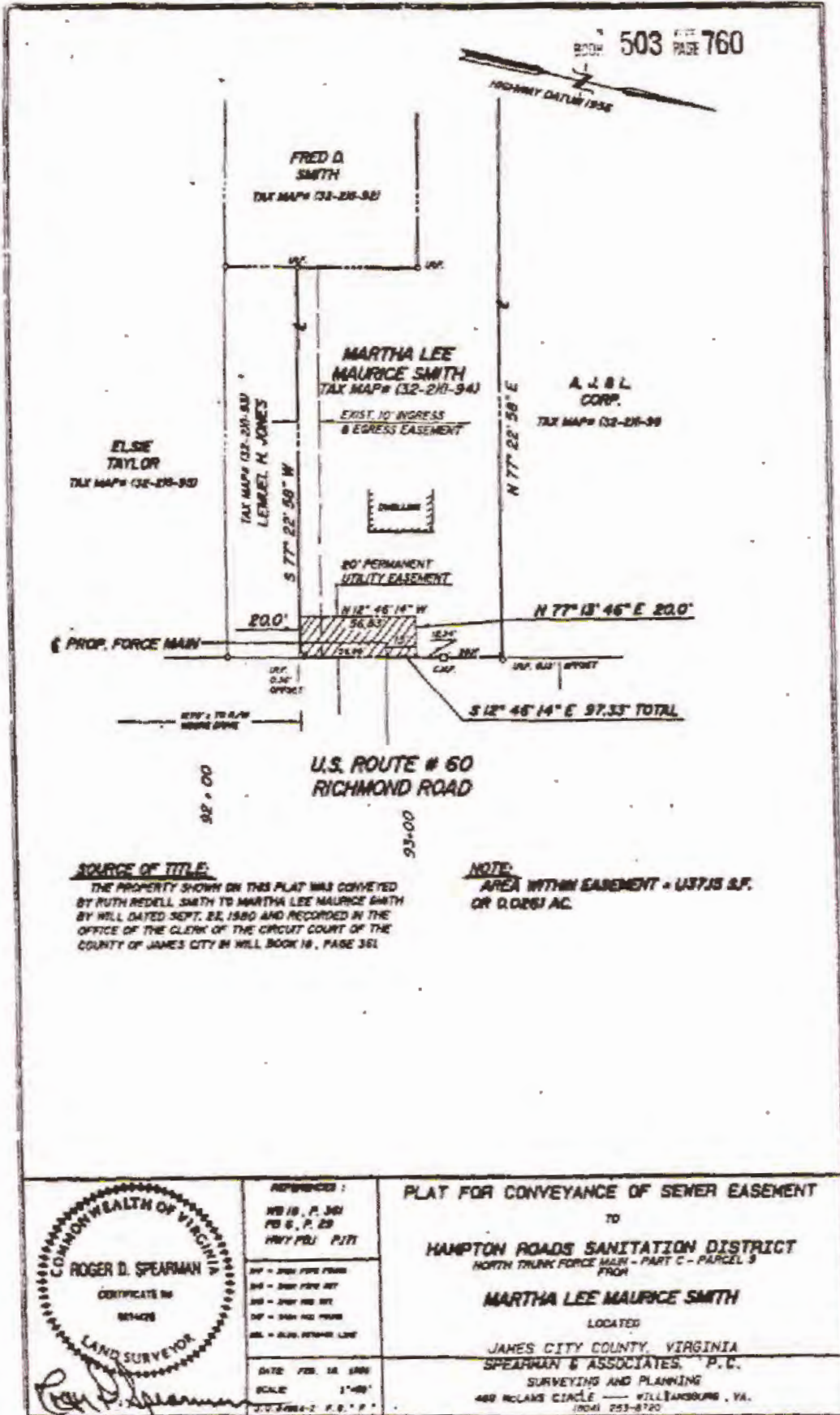

2/14/91

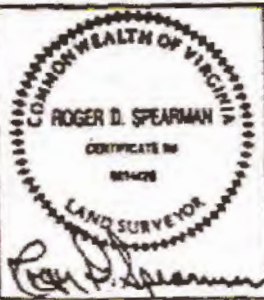

REFERENCES:  
 WB 18, P. 361  
 PB 2, P. 29  
 HWY PBL P. 171

BY - 2001 FIVE FEET  
 BY - 2001 FIVE FEET  
 BY - 2001 FIVE FEET  
 BY - 2001 FIVE FEET  
 BY - 2001 FIVE FEET

DATE: FEB. 14, 1990  
 SCALE: 1"=40'  
 J.V. Spearman & Associates, P.C.

PLAT FOR CONVEYANCE OF SEWER EASEMENT  
 TO  
 HAMPTON ROADS SANITATION DISTRICT  
 NORTH TRUNK FORCE MAIN - PART C - PARCEL 3  
 FROM  
 MARTHA LEE MAURICE SMITH  
 LOCATED  
 JAMES CITY COUNTY, VIRGINIA  
 SPEARMAN & ASSOCIATES, P.C.  
 SURVEYING AND PLANNING  
 489 HOLMES CIRCLE - WILLIAMSBURG, VA.  
 (804) 253-8720