

EASTERN STATE
HOSPITAL MERIDIAN

JAMES H. JOHNS &
STEVE E. MINOR

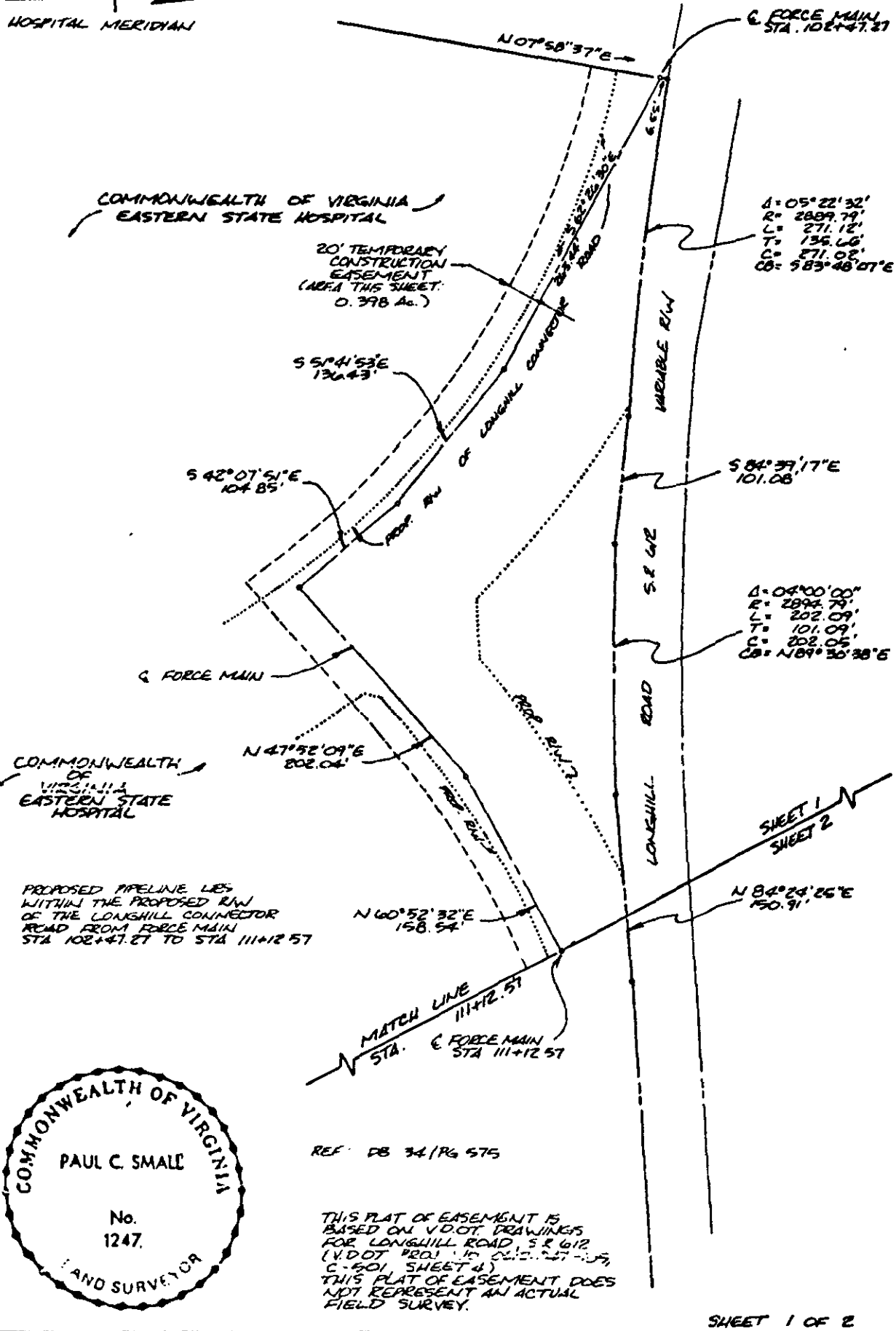

COMMONWEALTH OF VIRGINIA
PAUL C. SMALL
No. 1247
LAND SURVEYOR

REF. DB 34/RG 575

THIS PLAT OF EASEMENT IS
BASED ON V.D.O.T. DRAWINGS
FOR LONGHILL ROAD, S.E. 612
(V.D.O.T. PROJ. 10 0212-07-05,
C-601, SHEET 4).
THIS PLAT OF EASEMENT DOES
NOT REPRESENT AN ACTUAL
FIELD SURVEY.

SHEET 1 OF 2

AES, a professional corporation engineers, surveyors, planners Williamsburg, Virginia

PLAT SHOWING EASEMENT FOR
HAMPTON ROADS SANITATION DISTRICT
LONGHILL ROAD INTERCEPTOR FORCE MAIN
FROM
COMMONWEALTH OF VIRGINIA
EASTERN STATE HOSPITAL

JAMES CITY COUNTY VIRGINIA

Scale: 1" = 100' Ref.: Date: 6/10/87 Job No. 8818