

NOR F GURLEY WALTRIP

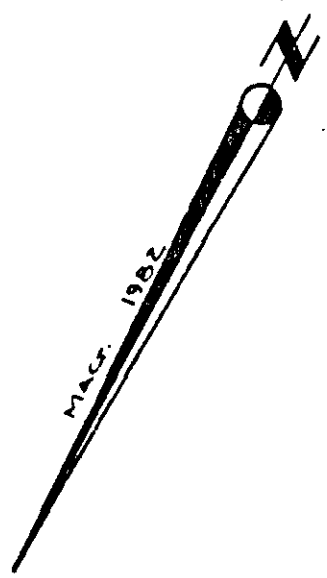

S64°00'48"W  
106.99'

ALONG LITH OF OLD ROAD

IPF

TO METAL POST

**AREA**  
1.0843 ± ACRES  
TAX MAP REF. #  
(48-4) (1-4)

LIMITS OF GARDEN AREA

NOR F  
HAZEL WALTRIP

448.78'

N28°57'41"W

LIMITS OF GARDEN AREA

NOR F  
GURLEY WALTRIP

NOTE:  
DWELLING SHOWN  
IS A 1 STORY FRAME  
STRUCTURE.

S28°56'10"E

442.86'

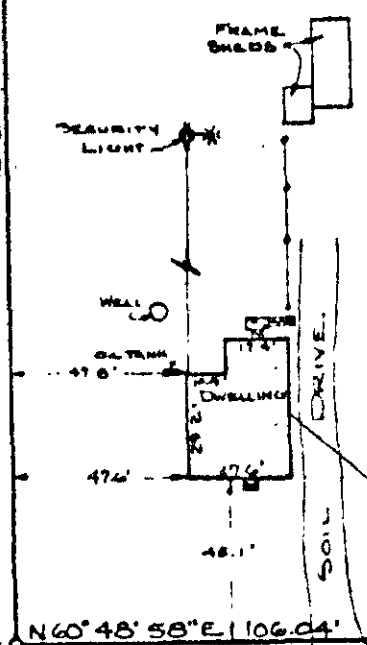

OVERHEAD  
VE.P.CO.  
LINES

TO CLOSED  
GENERAL FID

N60°48'58"E 106.04'

1400' ± TO LAKE POWELL ROAD

DIRT TRAVEL LANE

D.C. WALTRIP



*Roger R. Spearman*

Reference:  
DB 49, P 138  
DB 136, P 46

IPF = Iron Pipe Fd.  
IP3 = Iron Pipe Set  
BSL = Building  
Set-back Line

Date: MAY 6, 1982  
Scale: 1" = 50'  
J.O. 1926, R.B. "E"

PHYSICAL SURVEY  
OF PROPERTY TO BE DIVIDED TO  
KERMIT A. WALTRIP, SR. AND  
MARCIA LUCILE WALTRIP  
FINING  
1.0843 ± ACRES  
JAMES CITY COUNTY, VIRGINIA

Spearman & Associates, Inc., Land Surveying  
706 Richmond Road Williamsburg, Virginia  
804 - 229 - 3069