

OK JWU (NL)

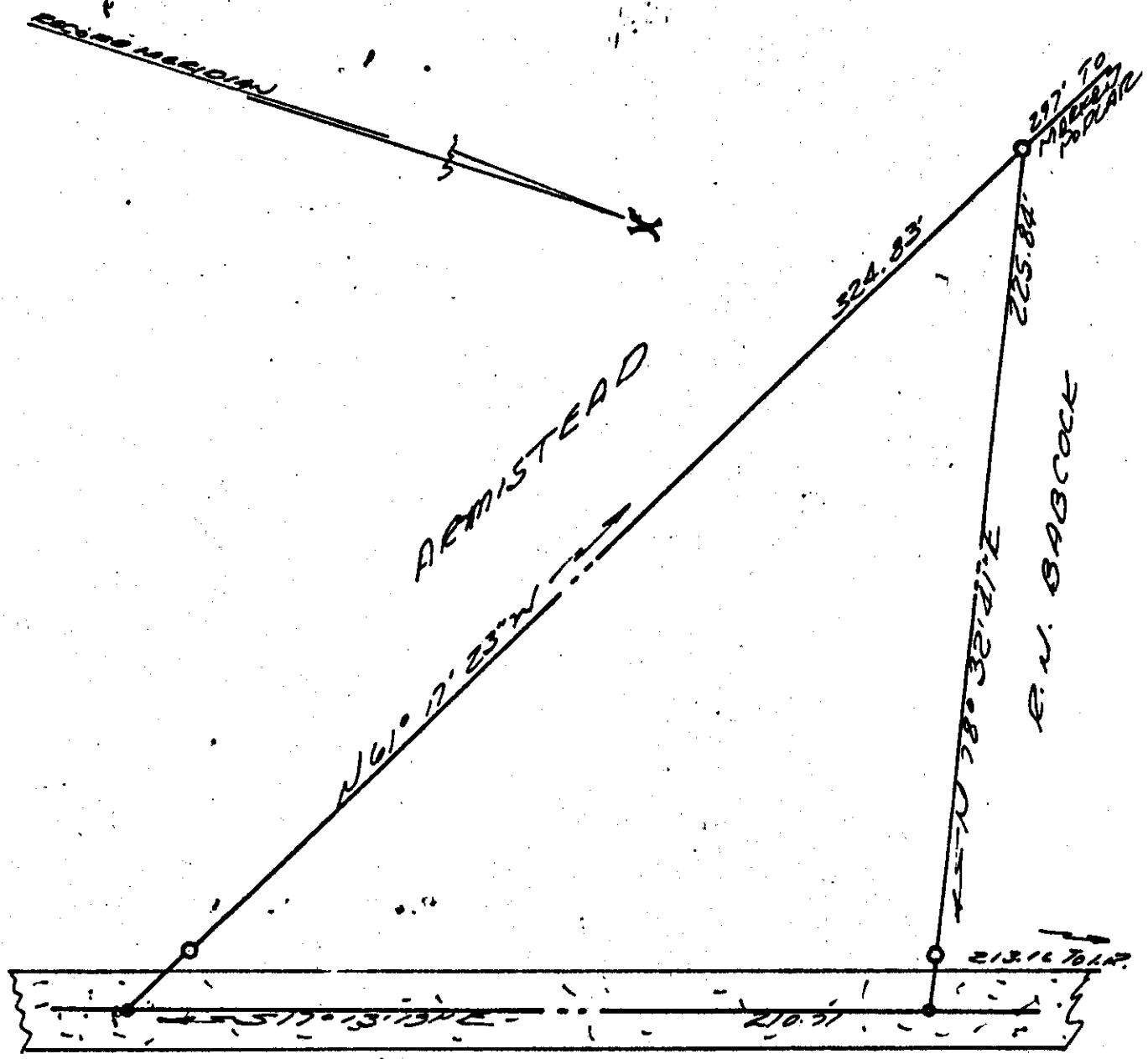

JAMESTOWN 100N BOUND RD. EXT. FIVE FORKS VA. ST. ROUTE NO. 615

PLAT SHOWING BOUNDARY SURVEY OF A PARCEL OF LAND TO BE CONVEYED BY

ROBERT N. BABCOCK ETUX.

BERKELEY DIST JAMES CITY COUNTY VIRGINIA

24 JAN. 1974

SCALE 1" = 40'

TOTAL AREA - 23661.62 SQ.
PUBLIC USE AREA - 3050.88 SQ.



VINCENT D. WILLIAMS JR. ASSOC
WILLIAMSBURG, VIRGINIA
LAND SURVEYING