

EXHIBIT B-18  
 SUPPLEMENTAL CONDOMINIUM PLAN  
 OF  
 WYNDHAM PLANTATION  
 CONDOMINIUM  
 WILLIAMSBURG, VIRGINIA  
 SCALE: 1"=10' JUNE 18, 2003  
 JOHN E. SIRINE AND ASSOCIATES, LTD.  
 SURVEYORS • ENGINEERS • PLANNERS  
 VIRGINIA BEACH, VIRGINIA  
 (757) 486-4910

NOTES:

1. BUILDING DIMENSIONS SHOWN HEREON ARE INTERIOR DIMENSIONS. THESE DIMENSIONS ARE IN FEET AND WERE TAKEN FROM PLANS SUPPLIED ENTITLED "WYNDHAM PLANTATION AT WILLIAMSBURG, FLOOR PLANS" BY PROGRESSIVE DESIGNS DATED 11/19/98.
2. INTERIOR UNIT CONFIGURATIONS AND PARTITIONS AS DEPICTED HEREON ARE FOR THE PURPOSE OF ILLUSTRATION ONLY AND MAY NOT REPRESENT THE INTERIOR OF A UNIT AS ACTUALLY CONSTRUCTED.

SECOND FLOOR - BUILDING 1

SCALE: 1"=10'

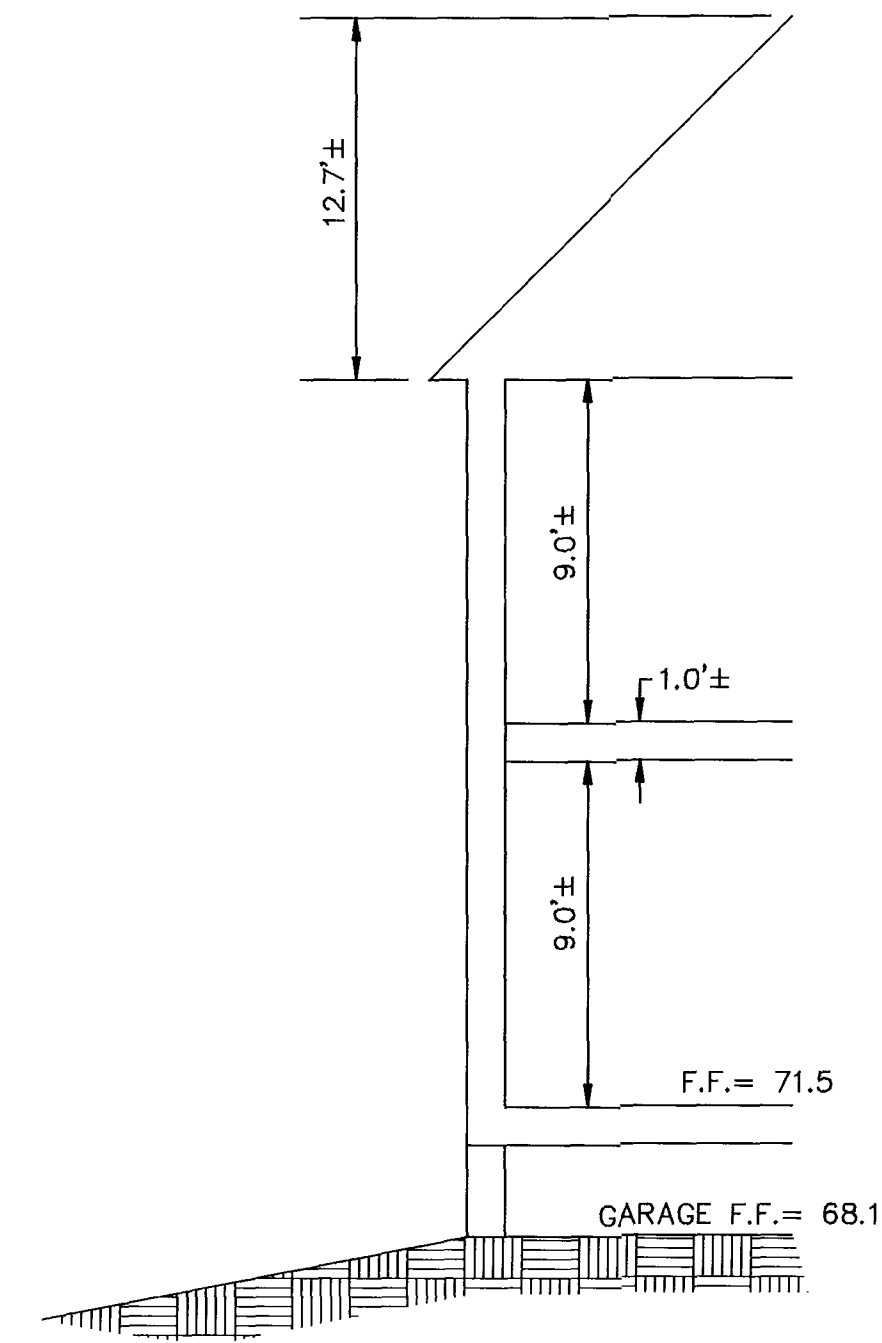
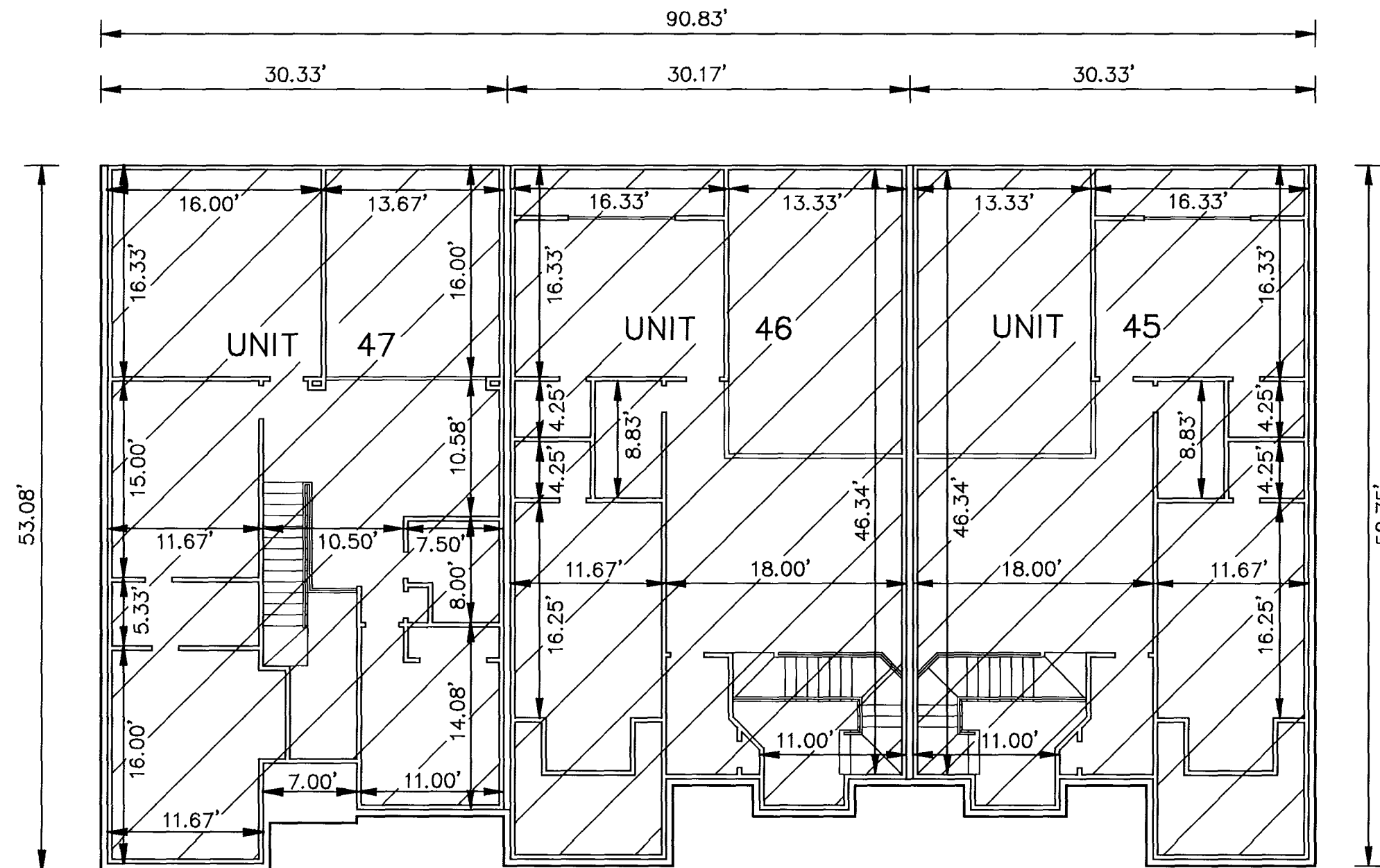

SCALE: 1"=5'

UNIT AREA

| PHASE | UNIT No. | UNIT ADDRESS     | UNIT AREA  |
|-------|----------|------------------|------------|
| 20    | 45       | 100 ZELKOVA ROAD | 2,101 S.F. |
| 20    | 46       | 104 ZELKOVA ROAD | 1,957 S.F. |
| 20    | 47       | 108 ZELKOVA ROAD | 1,853 S.F. |

THE UNDERSIGNED CERTIFIES THAT THESE PLANS ARE ACCURATE AND COMPLY WITH THE PROVISIONS OF CODE OF VIRGINIA, SECTION 55-79.58.B AND THAT ALL UNITS OR PORTIONS THEREOF DEPICTED HEREON AND ALL COMMON ELEMENTS HAVE BEEN SUBSTANTIALLY COMPLETED.

SIGNED: Jeffrey D. Williams  
 JEFFREY D. WILLIAMS, L.S.

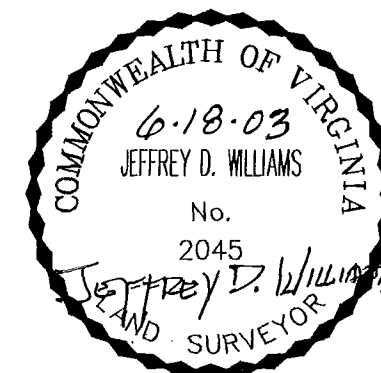

City of Williamsburg & County of James City  
 Circuit Court: This PLAT was recorded on  
 at 3:41 AM/PM, PB 20 PG 22-25  
 DOCUMENT # 031476  
 BETSY B. WOOLRIDGE, CLERK  
Betsy B. Woolridge Clerk

