

Contact " Miss Utility " prior to start of construction

LITTLE CREEK DAM ROAD RT. 665

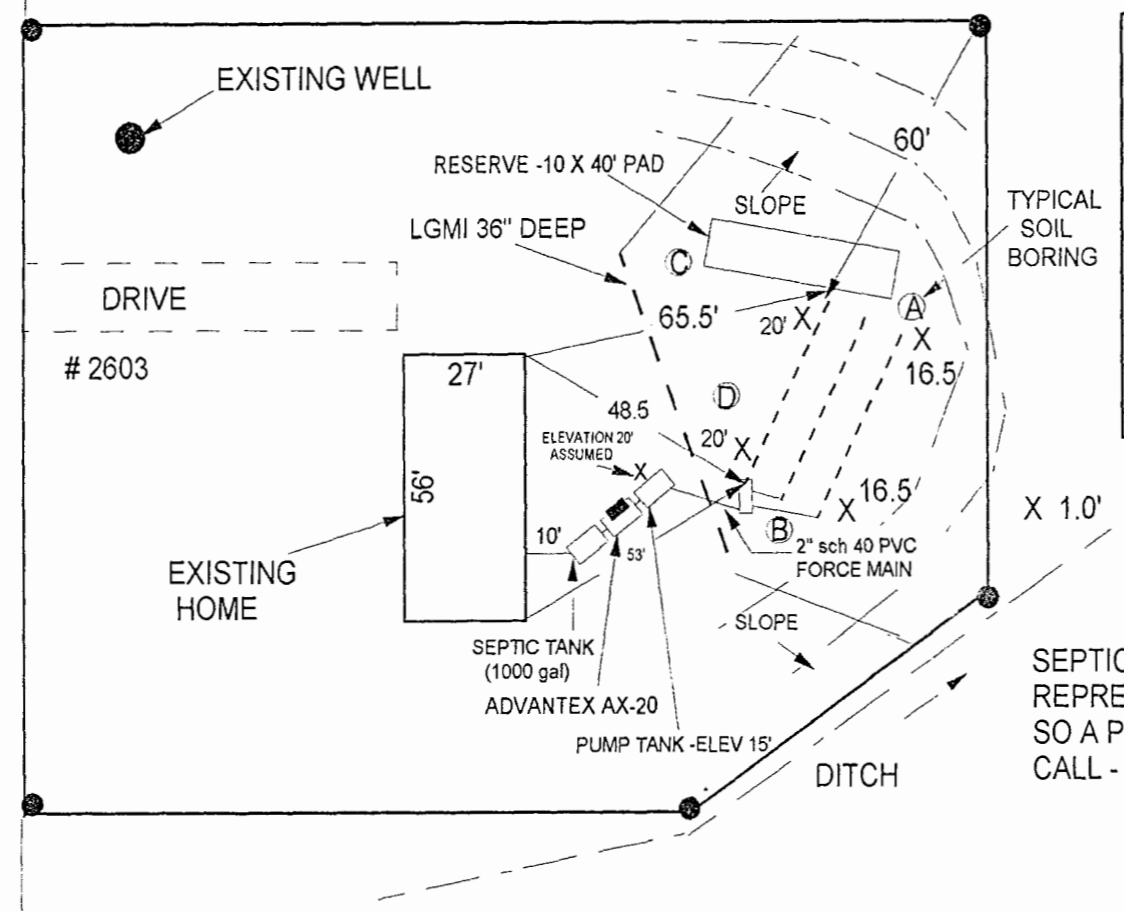

INSTALL 3- 43.75' DRAINLINES
 INSTALL TRENCH BOTTOM - 116"
 USE INFILTRATOR TRENCH SECTIONS ON
 9'CENTERS WITH 3' WIDE TRENCH
 GRADE SURFACE TO DRAIN

X 1.0' ELEVATION

SEPTIC CONTRACTOR MUST NOTIFY THE ENGINEER'S
 REPRESENTATIVE 72 Hrs IN ADVANCE OF INSTALLATION
 SO A PRECONSTRUCTION MEETING CAN BE ARRANGED.
 CALL - 804-725-7348 TO CONTACT REPRESENTATIVE.

City of Williamsburg & County of James City
 Circuit Court: This PLAT was recorded on
10 July 2003
 at 11:32 AM/PM. PB 90 PG 81-84
 DOCUMENT # 030020508
 BETSY B. WOOLRIDGE, CLERK
Betsy B. Woolridge Clerk

SYSTEM INSTALLATION SHALL BE PERFORMED
 DURING DRY SOIL CONDITIONS ONLY. THERE
 IS TO BE NO DISTURBANCE TO THE SOIL IN THE
 PROPOSED DRAINFIELD AREA.

THIS IS A DEEP DRAINFIELD TRENCH BOTTOM TO
 BE INSTALLED AT 116" DEEP.

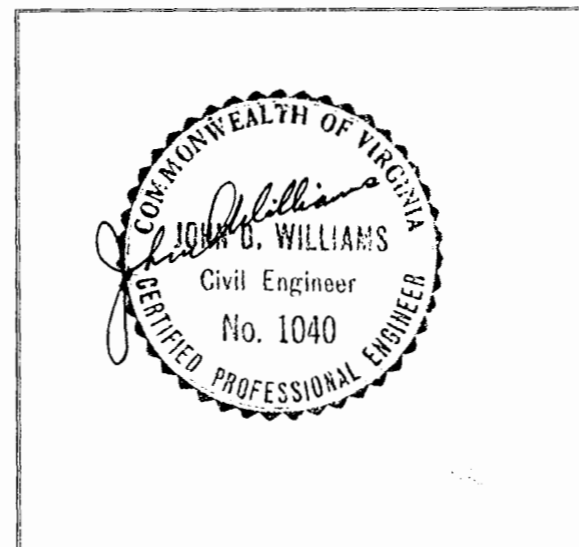

PROPOSED SEWAGE DISPOSAL SYSTEM
 FOR
OAKWOOD HOMES

TAX MAP #— 21-4 (2-15)
 COUNTY— JAMES CITY COUNTY
 Scale 1" = 40'
 DATE- May 22, 2003
 PAGE 1 OF 4
 DRAWING NUMBER 03-W61

prepared by:
 William J. Meagher, C.P.S.S.
 Post Office Box 950
 Main Street
 Mathews, Virginia 23109

under the direction of:
 John D. Williams, P.E.
 4307 Coventry Road
 Richmond, Virginia 23221

804-725-7348