

#030439

89 PAGE 68

EXHIBIT B-16
SUPPLEMENTAL CONDOMINIUM PLAT
OF
WYNDHAM PLANTATION
CONDOMINIUM

WILLIAMSBURG, VIRGINIA
SCALE: 1"=20' FEBRUARY 25, 2003
JOHN E. SIRINE AND ASSOCIATES, LTD.
SURVEYORS • ENGINEERS • PLANNERS
VIRGINIA BEACH, VIRGINIA
(757) 488-4910

THE UNDERSIGNED CERTIFIES THAT THESE PLATS ARE ACCURATE AND COMPLY WITH THE PROVISIONS OF CODE OF VIRGINIA, SECTION 55-79.5B.A AND THAT ALL UNITS OR PORTIONS THEREOF DEPICTED HEREON AND ALL COMMON ELEMENTS HAVE BEEN SUBSTANTIALLY COMPLETED.

SIGNED: JEFFREY D. WILLIAMS
JEFFREY D. WILLIAMS, L.S.

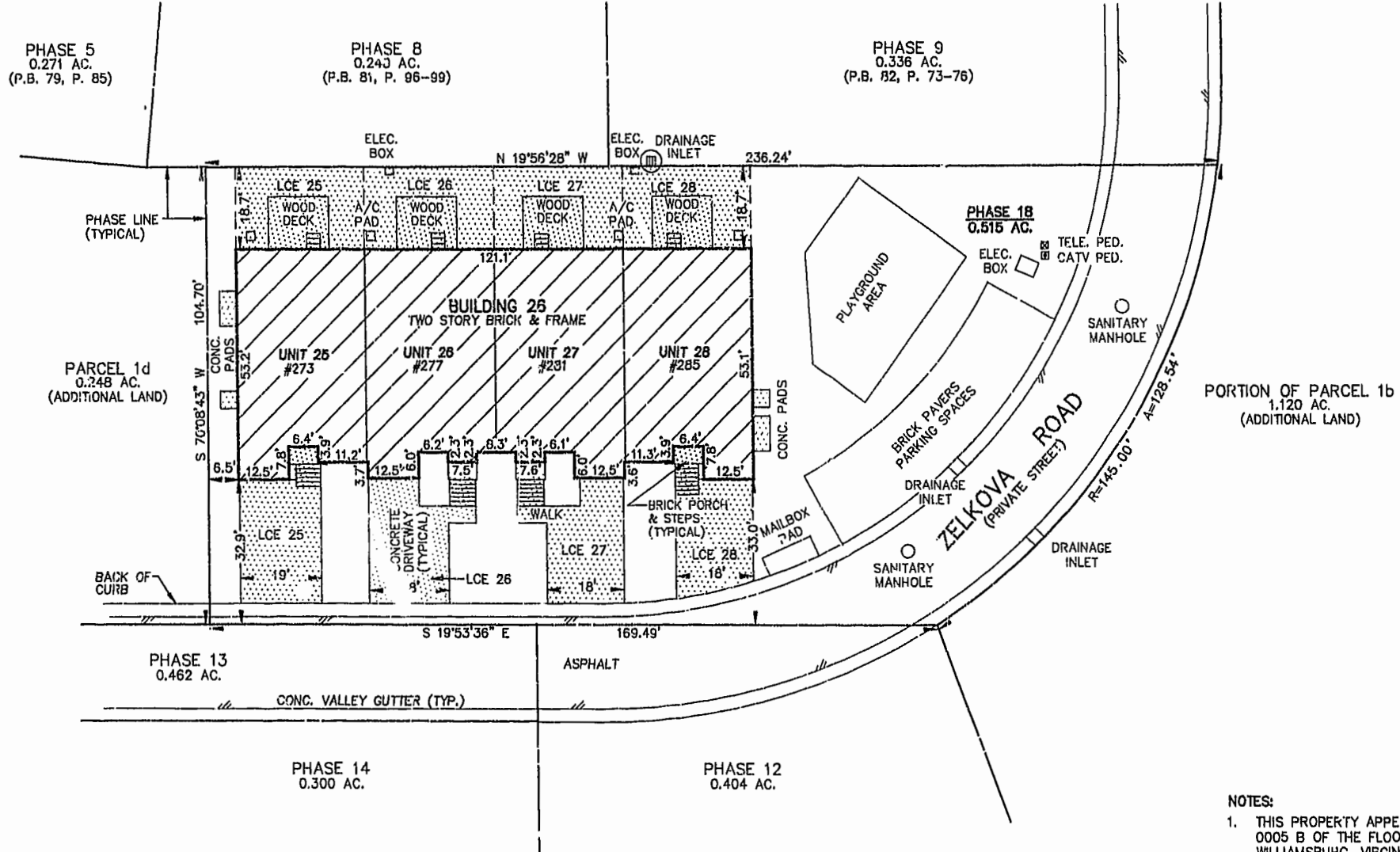
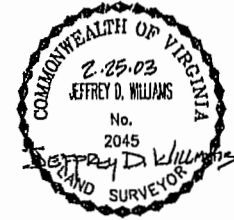

PORTION OF PARCEL 1b
1.120 AC.
(ADDITIONAL LAND)

LEGEND

- UNIT AREA
- LIMITED COMMON ELEMENT TO THE UNIT INDICATED (LCE)
- COMMON ELEMENT
- ADDRESS

City of Williamsburg & County of James City
Circuit Court: This PLAT was recorded on
MAR 3 2003
at 2:12 PM PB 89 P. 62-20
DOCUMENT # 030439
BETSY B. WOOLRIDGE, CLERK
Jeffrey D. Williams Clerk

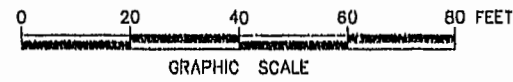

- NOTES:
1. THIS PROPERTY APPEARS TO FALL IN ZONE "X" AS SHOWN ON PANEL 0005 B OF THE FLOOD INSURANCE RATE MAPS FOR THE CITY OF WILLIAMSBURG, VIRGINIA, COMMUNITY PANEL NO. 510294, DATED MARCH 2, 1994.
 2. THIS SURVEY WAS PREPARED WITHOUT THE BENEFIT OF A TITLE REPORT.
 3. THE DESIGNATION OF "COMMON ELEMENT" IS NOT INTENDED TO IMPLY THAT ADDITIONAL LAND IS COMMON ELEMENT.
 4. THE DESIGNATION OF UNIT IS SUPERSEDED BY THE DEFINITION OF UNIT IN THE DECLARATION AND IS NOT INTENDED TO IMPLY THAT COMMON ELEMENTS ARE UNIT AREA.
 5. ALL BUILDING DIMENSIONS AS SHOWN ON THIS SHEET ARE EXTERIOR DIMENSIONS AND WERE OBTAINED BY A FIELD SURVEY ON 2/25/03.
 6. THIS PROPERTY IS SUBJECT TO A NON-EXCLUSIVE EASEMENT FOR INGRESS AND EGRESS TO AND THE RIGHT TO THE USE AND ENJOYMENT OF SEWER, WATER AND STORMWATER FACILITIES AS OUTLINED IN DEED RECORDED BY INSTRUMENT NO. 990092 (CITY OF WILLIAMSBURG, JAMES CITY COUNTY, VIRGINIA).
 7. PROPERTY IS SUBJECT TO THE FOLLOWING EASEMENTS:
A.) VARIABLE WIDTH VIRGINIA ELECTRIC AND POWER COMPANY EASEMENT (INSTR. # 990544)
B.) 10' BELL ATLANTIC EASEMENT (INSTR. # 9801390)