

#020028120

88 PAGE 62

EXIST. 80' JAMES CITY COUNTY SERVICE
AUTHORITY SAN. SEWER EASEMENT AS
SHOWN IN AS-BUILT LOCATION. D.B. 141 - PG. 388

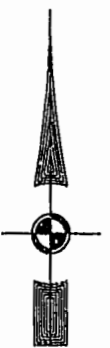

MATCH LINE - SEE SHEET 5

MATCH LINE - SEE SHEET 2

46-1-01-0-0001
"GREENSPRINGS PLANTATION"
(DB 322, PG 254)

City of Williamsburg & County of James City
Circuit Court: This PLAT was recorded on
Nov. 25, 2002
at 10:32 AM, P.M., PG. 59-61
DOCUMENT # 020028120
BETSY B. WOOLRIDGE, CLERK
C. Newell, Dep. Clerk

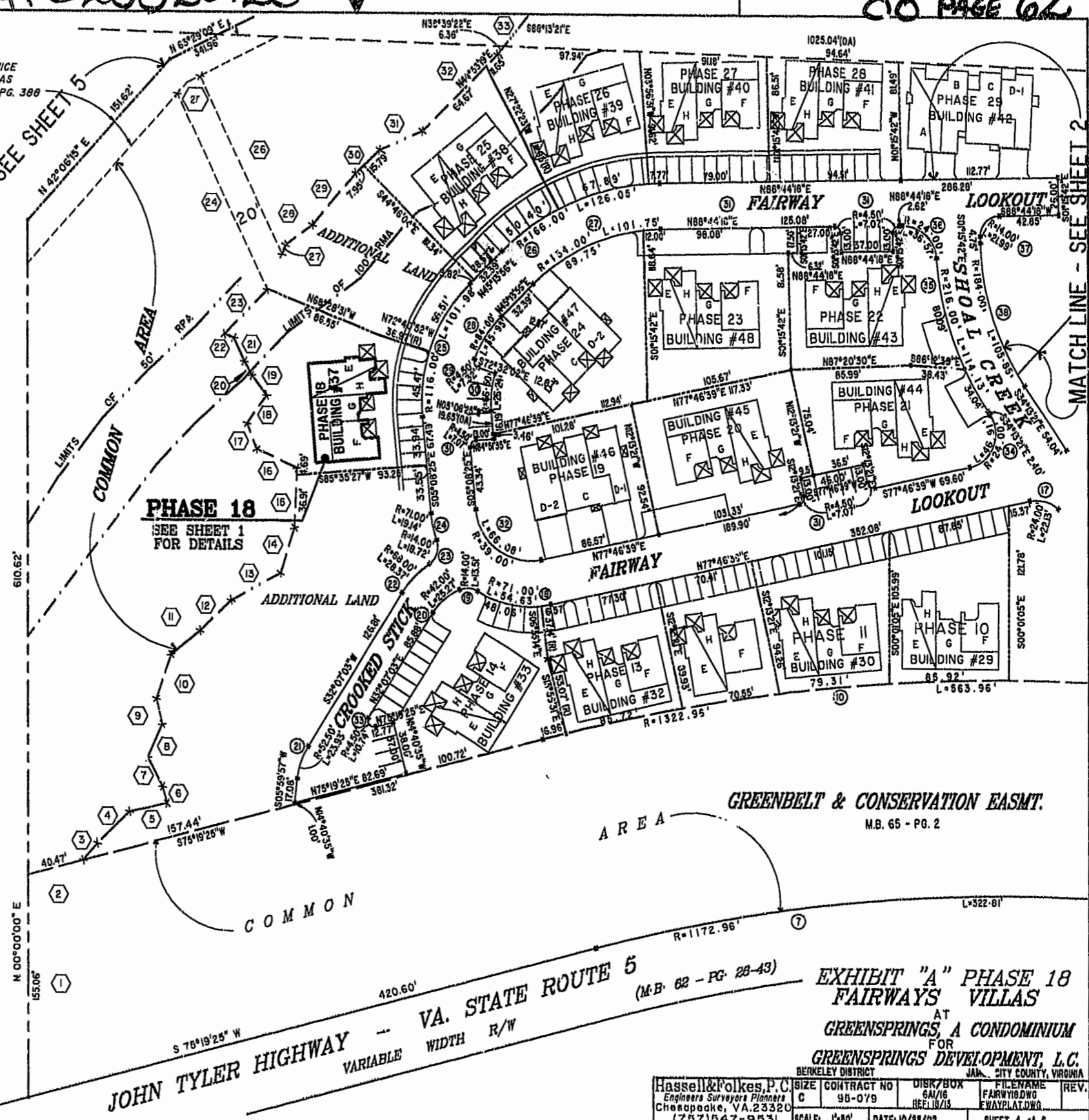

JOHN TYLER HIGHWAY - VA. STATE ROUTE 5
VARIABLE WIDTH R/W

GREENBELT & CONSERVATION EASMT.
M.B. 65 - PG. 2

EXHIBIT "A" PHASE 18
FAIRWAYS VILLAS
AT
GREENSPRINGS, A CONDOMINIUM
FOR
GREENSPRINGS DEVELOPMENT, L.C.
BERKELEY DISTRICT JAMES CITY COUNTY, VIRGINIA

Hassell & Polkes, P.C. Engineers Surveyors Planners Charlottesville, VA 22902 (757) 547-9531	SIZE: C CONTRACT NO: 95-079 DISK/BOX: 6A/16 REEL: 18/13	FILE NAME: FAIRWAY.DWG DRAWN BY: WJL	REV.:
SCALE: 1"=80'	DATE: 10/22/02	SHEET 4 of 6	