

WE HEREBY CERTIFY THAT WE HAVE SURVEYED ALL OF THE UNITS OR PORTIONS THEREOF AND DO FURTHER CERTIFY THAT THESE PLANS ARE ACCURATE AND THEY COMPLY WITH SECTION 55-79.55(B) OF THE CODE OF VIRGINIA, AS AMENDED. ALL STRUCTURED ARE SUBSTANTIALLY COMPLETE.

AES CONSULTING ENGINEERS

BY: *G. T. Wilson, Jr.*
G. T. WILSON, JR., C.L.S.

(C.E.) = COMMON ELEMENT

AREA TABULATION - 2ND LEVEL

| | |
|---|-------------------------|
| SUITE 2-A | 2670.33 SQ. FT.± |
| SUITE 2-B | 1037.51 SQ. FT.± |
| SUITE 2-C | 2573.96 SQ. FT.± |
| COMMON ELEMENTS (C.E.) - WALLS, LOBBY, STAIRS, JANITORS CLOSET, ELEVATOR, CHIMNEY | 1223.75 SQ. FT.± |
| TOTAL AREA 2ND LEVEL | 7805.55 SQ. FT.± |

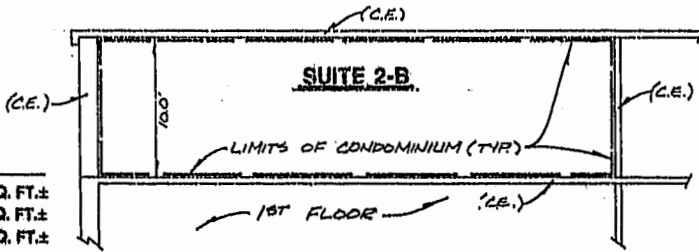

SECTION 5
SCALE: 1" = 8'

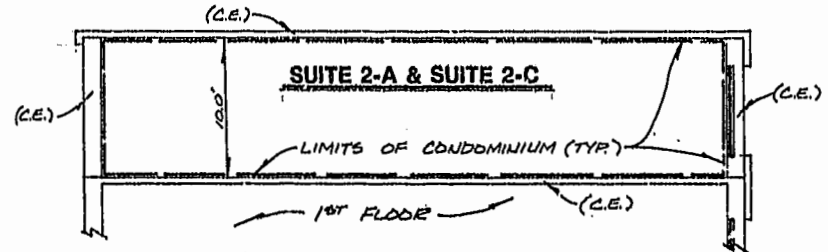

SECTION 6
SCALE: 1" = 8'

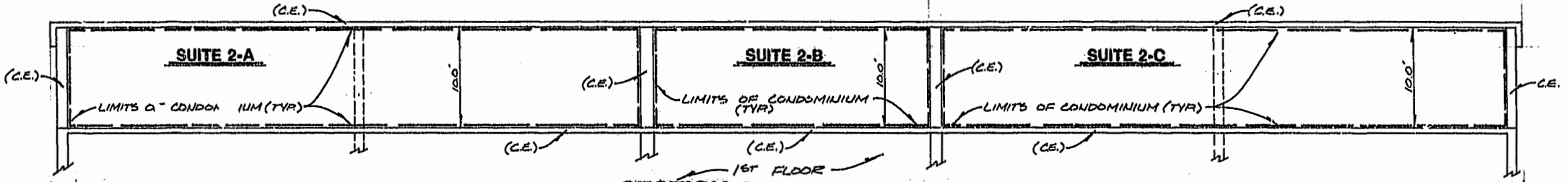

SECTION 4
SCALE: 1" = 8'

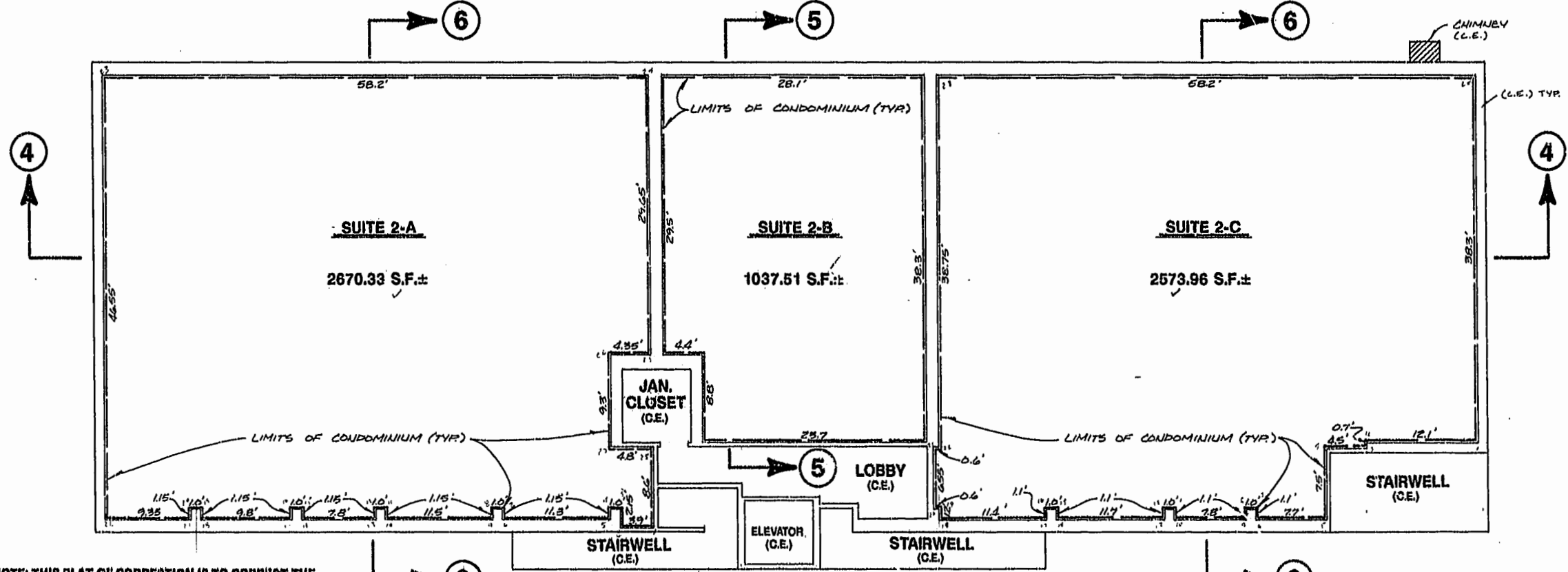

PLAN VIEW-2ND FLOOR
SCALE: 1" = 8'

NOTE: THIS PLAT OF CORRECTION IS TO CORRECT THE AREA OF SUITE 1-B. THIS IS THE ONLY CORRECTION MADE TO THE PLAT AS RECORDED IN PLAT BOOK 58, PAGE 18-22.

022004

88 PAGE 38



5248 Olde Towne Road, Suite 1
Williamsburg, Virginia 23188
(804) 253-0040
Fax (804) 220-8994

PLAT OF CORRECTION
EXHIBIT B
WILLIAMSBURG PROFESSIONAL CENTRE CONDOMINIUMS
OWNER/ DEVELOPER: ALVIN P. ANDERSON, TRUSTEE
CITY OF WILLIAMSBURG VIRGINIA



| | | | |
|-----|------|---------------------------|----|
| No. | DATE | REVISION / COMMENT / NOTE | BY |
| | | | |

City of Williamsburg & County of James City
Circuit Court: This PLAT was recorded on
8/20/02 at 10:23 AM PM-PB-88 PG 36-39
DOCUMENT # 022004
BETSY B. WOODRIDGE, CLERK
Betsy B. Woodridge Sup. Clerk

| | |
|-----------------------|------------------|
| Designed AES | Drawn RWE |
| Scale NOTED | Date 10/10/02 |
| Project No. 7240 | |
| Drawing No. 3 OF 4 | |