

EXHIBIT B-13  
SUPPLEMENTAL CONDOMINIUM PLAN  
OF  
WYNDHAM PLANTATION  
CONDOMINIUM

WILLIAMSBURG, VIRGINIA  
SCALE: 1"=10' AUGUST 14, 2002

JOHN E. SIRINE AND ASSOCIATES, LTD.  
SURVEYORS • ENGINEERS • PLANNERS  
VIRGINIA BEACH, VIRGINIA  
(757) 486-4910

NOTES:

- BUILDING DIMENSIONS SHOWN HEREON ARE INTERIOR DIMENSIONS. THESE DIMENSIONS ARE IN FEET AND WERE TAKEN FROM PLANS SUPPLIED ENTITLED "WYNDHAM PLANTATION AT WILLIAMSBURG, FLOOR PLANS" BY PROGRESSIVE DESIGNS DATED 11/19/98.
- INTERIOR UNIT CONFIGURATIONS AND PARTITIONS AS DEPICTED HEREON ARE FOR THE PURPOSE OF ILLUSTRATION ONLY AND MAY NOT REPRESENT THE INTERIOR OF A UNIT AS ACTUALLY CONSTRUCTED.

FIRST FLOOR - BUILDING 9

SCALE: 1"=10'

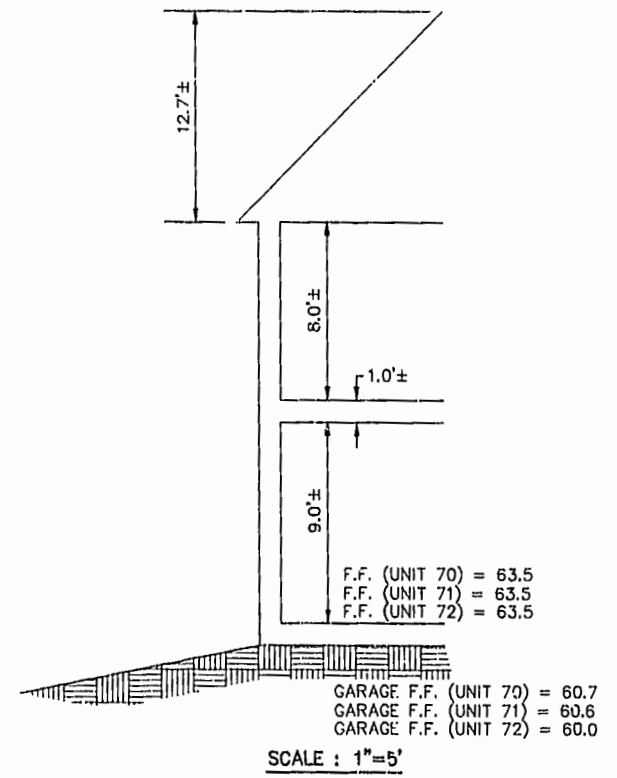
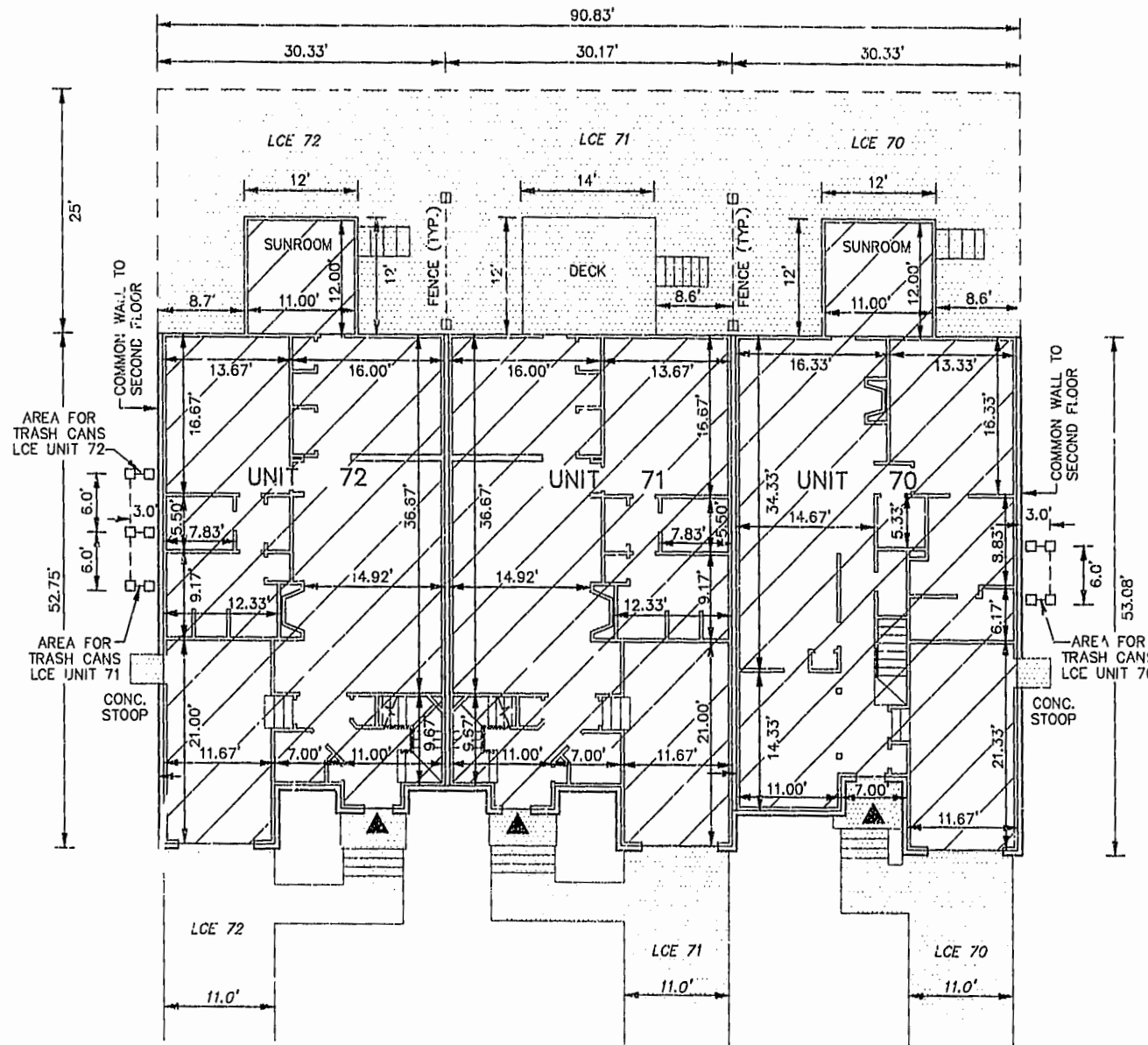

UNIT AREA  
LIMITED COMMON ELEMENT TO THE UNIT INDICATED (LCE)  
INDICATES FRONT ENTRANCE TO UNIT

PHASE	UNIT No.	UNIT ADDRESS	UNIT AREA
15	70	260 ZELKOVA ROAD	1,997 S.F.
15	71	264 ZELKOVA ROAD	1,957 S.F.
15	72	268 ZELKOVA ROAD	2,101 S.F.

THE UNDERSIGNED CERTIFIES THAT THESE PLANS ARE ACCURATE AND COMPLY WITH THE PROVISIONS OF CODE OF VIRGINIA, SECTION 55-79.5B.B AND THAT ALL UNITS OR PORTIONS THEREOF DEPICTED HEREON AND ALL COMMON ELEMENTS HAVE BEEN SUBSTANTIALLY COMPLETED, UNLESS OTHERWISE NOTED.

SIGNED: Jeffrey D. Williams  
JEFFREY D. WILLIAMS, L.S.

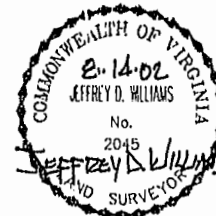

City of Williamsburg & County of James City  
Circuit Court: This PLAT was recorded on  
20 Aug 2002  
at 8:55 AM in PB 87, PG 49-54  
DOCUMENT # 021580  
Patsy B. Woodridge, Clerk

