

BUILDING NUMBER	UNIT NUMBER	STREET ADDRESS
25	2501	2501 WESTGATE CIRCLE
25	2502	2502 WESTGATE CIRCLE
25	2503	2503 WESTGATE CIRCLE
25	2504	2504 WESTGATE CIRCLE

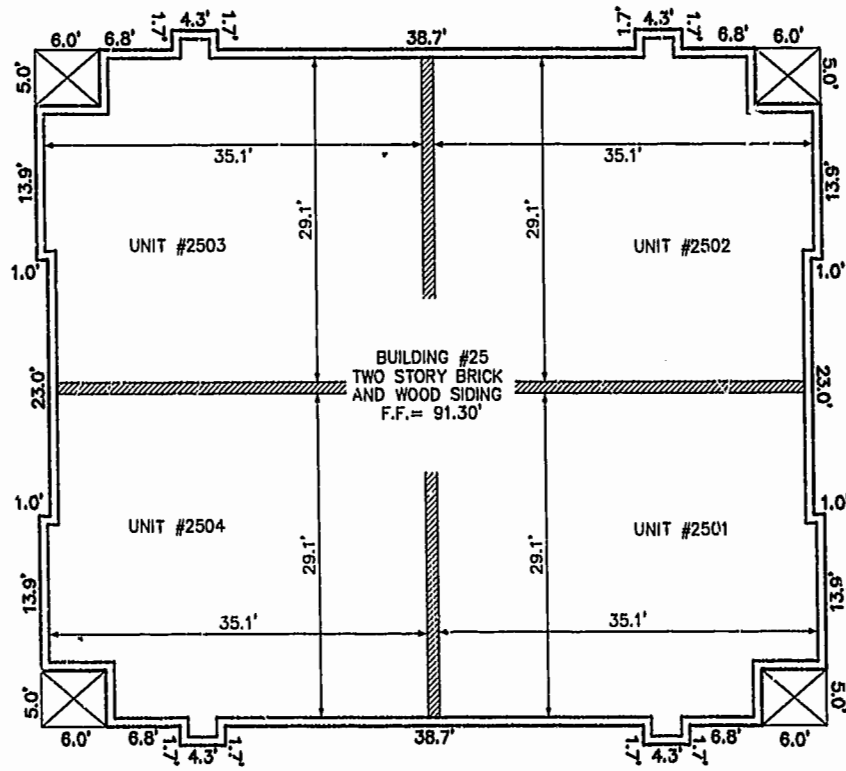

FRONT OF BUILDING  
FIRST FLOOR

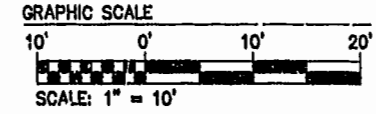
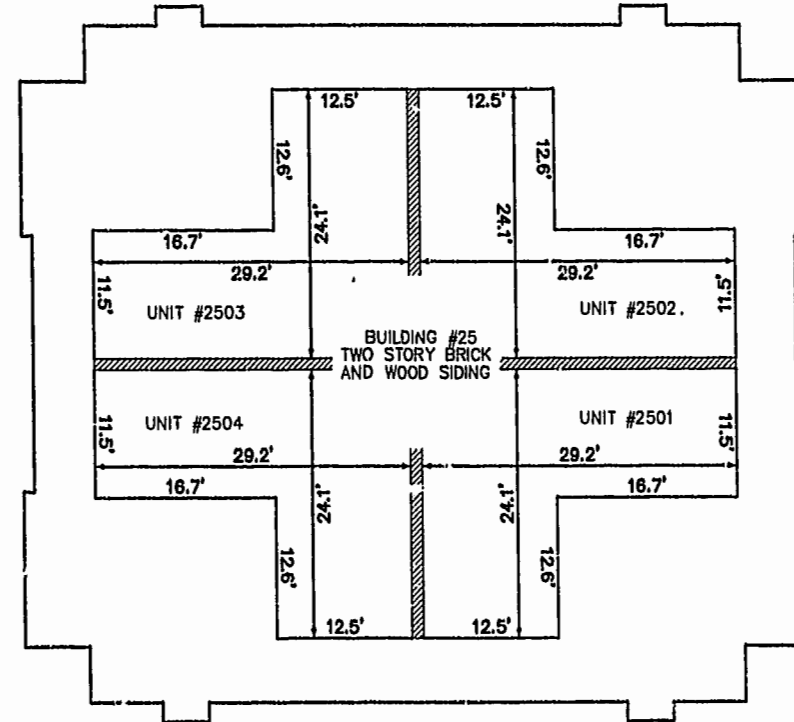

FRONT OF BUILDING  
SECOND FLOOR

05.31.02-08:42 8395p254.dwg JFS

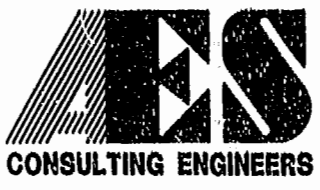

5248 Old Towne Road, Suite 1  
Williamsburg, Virginia 23188  
(757) 253-0040  
Fax (757) 220-8994

**PLAT OF CONDOMINIUM  
WESTGATE AT WILLIAMSBURG,  
A CONDOMINIUM  
PHASE TWENTY-FIVE  
OWNED BY: 752 L.L.C.,  
A VIRGINIA LIMITED LIABILITY COMPANY  
CITY OF WILLIAMSBURG VIRGINIA**



No.	DATE	REVISION / COMMENT / NOTE	BY

City of Williamsburg & County of James City  
Circuit Court: This PLAT was recorded on  
14 June 2002  
at 2:46 AM/PM, PB 86, PG 44-46  
DOCUMENT # 021063  
BETSY B. WOOLRIDGE, CLERK  
Betsy B. Woolridge, Dep. Clerk

Designed GTW/ADS	Drawn JFS
Scale 1" = 10'	Date 5/30/02
Project No. 8395-6	
Drawing No. 4 OF 6	