

NOW OR FORMERLY  
COLLEGE OF WILLIAM & MARY

IRONBOUND

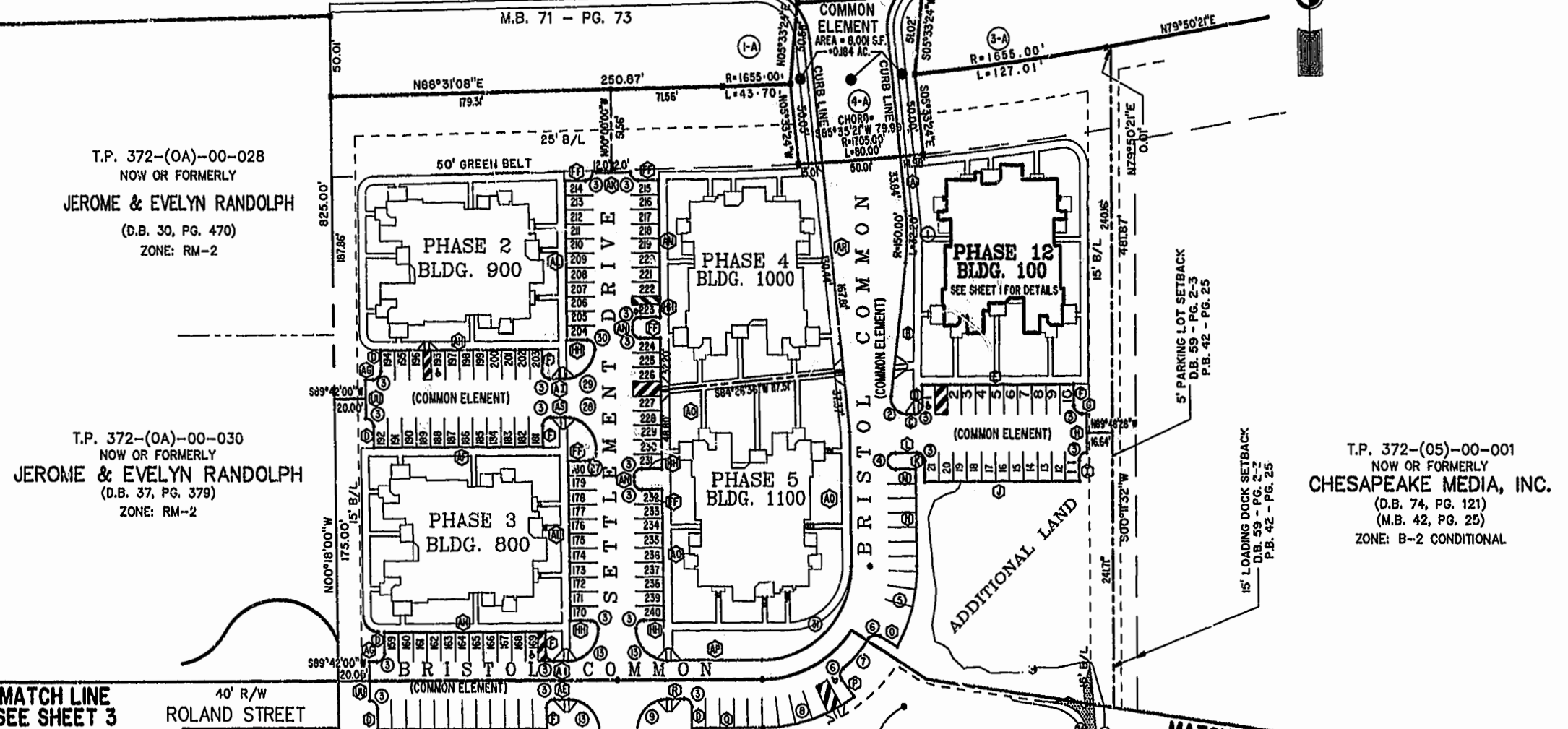
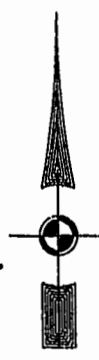
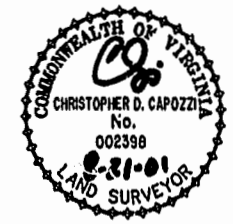

T.P. 372-(OA)-00-028  
NOW OR FORMERLY  
JEROME & EVELYN RANDOLPH  
(D.B. 30, PG. 470)  
ZONE: RM-2

T.P. 372-(OA)-00-030  
NOW OR FORMERLY  
JEROME & EVELYN RANDOLPH  
(D.B. 37, PG. 379)  
ZONE: RM-2

T.P. 372-(05)-00-001  
NOW OR FORMERLY  
CHESAPEAKE MEDIA, INC.  
(D.B. 74, PG. 121)  
(M.B. 42, PG. 25)  
ZONE: B-2 CONDITIONAL

MATCH LINE  
SEE SHEET 3  
40' R/W  
ROLAND STREET

MATCH LINE  
SEE SHEET 3

PHASE 6  
SEE SHEET 3

BRISTOL COMMONS  
A CONDOMINIUM COMMUNITY  
PHASE TWELVE  
FOR  
KEY GROUP, LLC

City of Williamsburg & County of James City  
Circuit Court: This PLAT was recorded on  
90 Aug 2001  
at 2:53 PM, PB 23, PG 14-17  
DOCUMENT # 011341  
BETSY B. WOOLRIDGE, CLERK  
*Betsy Woolridge*, Dep. Clerk

Hassell & Folkes, P.C. Engineers Surveyors Planners Chesapeake, VA. 23320 (757)547-9531	SIZE	CONTRACT NO	DISK/BOX	FILENAME	REV.
	C	98062	123J/15	BRISTOL12.DWG	
SCALE: 1"=50'		DATE: 08/20/01	SHEET 2 of 4		