

46-1-01-0-0001
"GREENSPRINGS PLANTATION"
(DB 322, PG 254)

EXIST. 20' JAMES CITY COUNTY SERVICE
AUTHORITY SAN. SEWER EASEMENT AS
SHOWN IN AS-BUILT LOCATION. D.B. 141 - PG. 388

EXIST. 20' DRAINAGE EASMT.
M.B. 65 - PG. 2

EXIST. 20' DRAINAGE EASEMENT
M.B. 65 - PG. 2

Williamsburg/James City County
3:51 PM
Recorded 25 day of July 2001
DOCUMENT # 010013018
By *Christopher D. Capozzi*
BETSY B. WOOLRIDGE, CLERK

MATCH LINE
SEE SHEET 4

MATCH LINE - SEE SHEET 3

EX. 50' COLONIAL PIPELINE EASEMENT (D.B. 90 PG. 1)
COMMON AREA

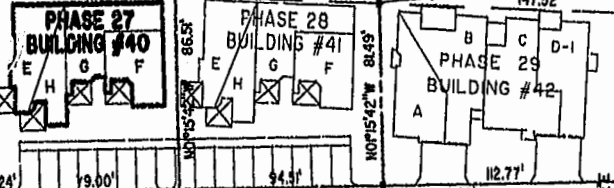

COMMON AREA
BMP LAKE # 1
AREA = 38,052 SQ. FT. =
0.8735 AC.
SEE SHEET 3 FOR DETAIL

MATCH LINE
SEE SHEET 4

SEE SHEETS 4 FOR
LOCATION AND DETAILS
OF PHASE 22, BLDG. #43

EXHIBIT "A" PHASE 27
FAIRWAYS VILLAS
AT
GREENSPRINGS, A CONDOMINIUM
FOR
GREENSPRINGS DEVELOPMENT, L.C.
BERKELEY DISTRICT JAMES CITY COUNTY, VIRGINIA



Hassell & Tolkes, P.C. Engineers Surveyors Planners Chesapeake, VA 23320 (757) 547-9631	SCALE: 1" = 50'	DATE: 06/29/01	DISK 7 BOX 6A/16 REF 10/13	FILENAME: FAIRWAY27.DWG F.WAYPL AT.DWG	REV.
--	-----------------	----------------	-------------------------------	---	------