

COLLEGE OF WILLIAM & MARY

NOW OR FORMERLY

IRON BOUND

(APPROX R/W)

ROAD



M.B. 71 - PG. 73

T.P. 372-(OA)-00-028
 NOW OR FORMERLY
JEROME & EVELYN RANDOLPH
 (D.B. 30, PG. 470)
 ZONE: RM-2

T.P. 372-(OA)-00-030
 NOW OR FORMERLY
JEROME & EVELYN RANDOLPH
 (D.B. 37, PG. 379)
 ZONE: RM-2

T.P. 372-(05)-00-001
 NOW OR FORMERLY
CHESAPEAKE MEDIA, INC.
 (D.B. 74, PG. 121)
 (M.B. 42, PG. 25)
 ZONE: B-2 CONDITIONAL

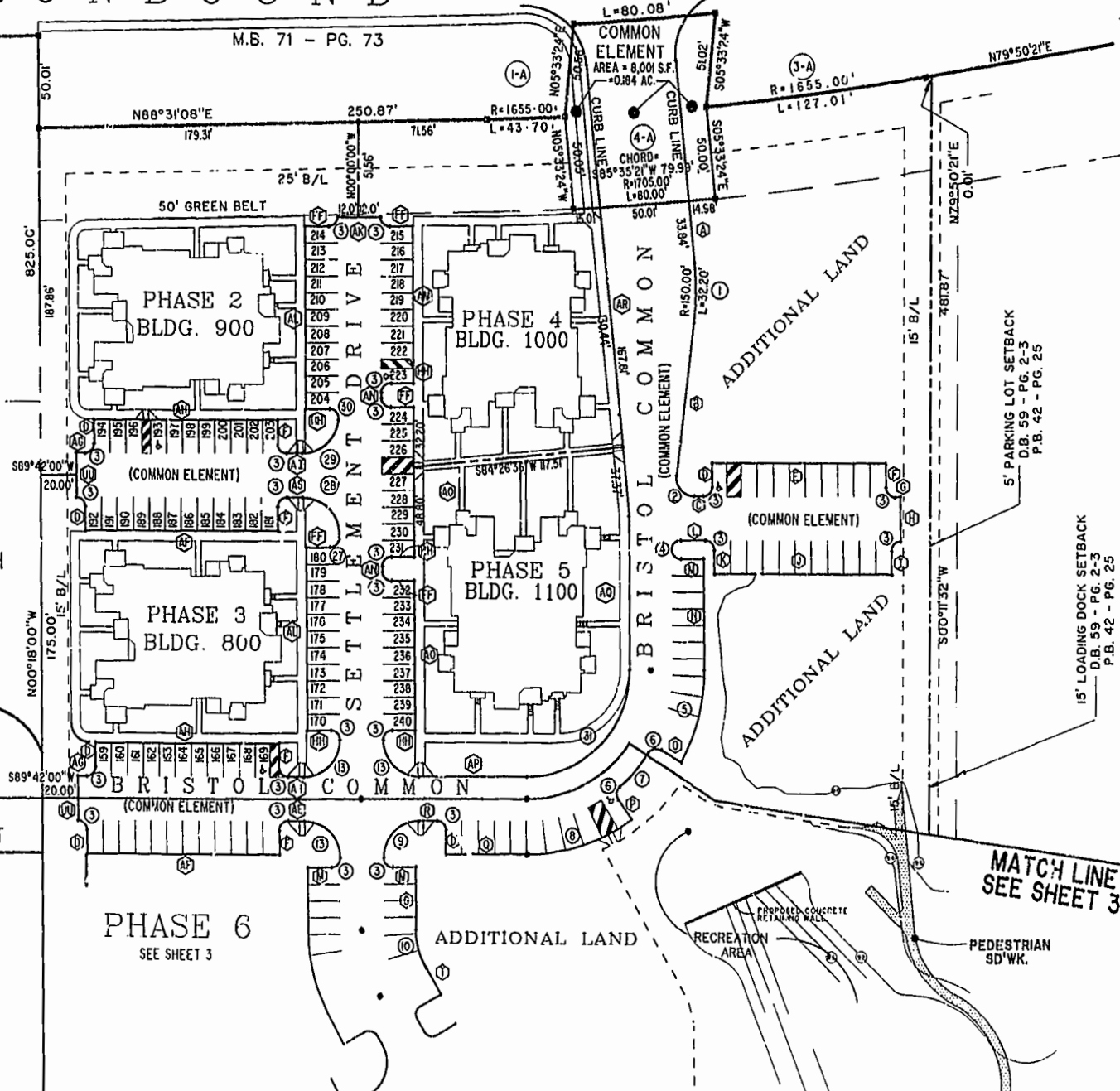

MATCH LINE SEE SHEET 3

40' R/W ROLAND STREET

MATCH LINE SEE SHEET 3

PHASE 6 SEE SHEET 3

Williamsburg/James City County
 3:54 PM
 Recorded 23 day of May, 2001
 DOCUMENT # 010720
Robby A. ...
 BETSY B. WOULDRIDGE, CLERK OF CIRCUIT COURT

PLAT R. COMBINED IN
 P.D. NO. 81 PAGE 27-80

BRISTOL COMMONS
 A CONDOMINIUM COMMUNITY
 PHASE SEVEN
 FOR
KEY GROUP, LLC

Hassell & Polkes, P.C. Engineers Surveyors Planners Chesapeake, VA 23320 (57)547-9531		SIZE C	CONTRACT NO 90062	DISK/BOX 123H/15	FILENAME BRISTOL7.DWG	REV.
SCALE: 1"=50'		DATE: 05/11/01	SHEET 2 of 4			