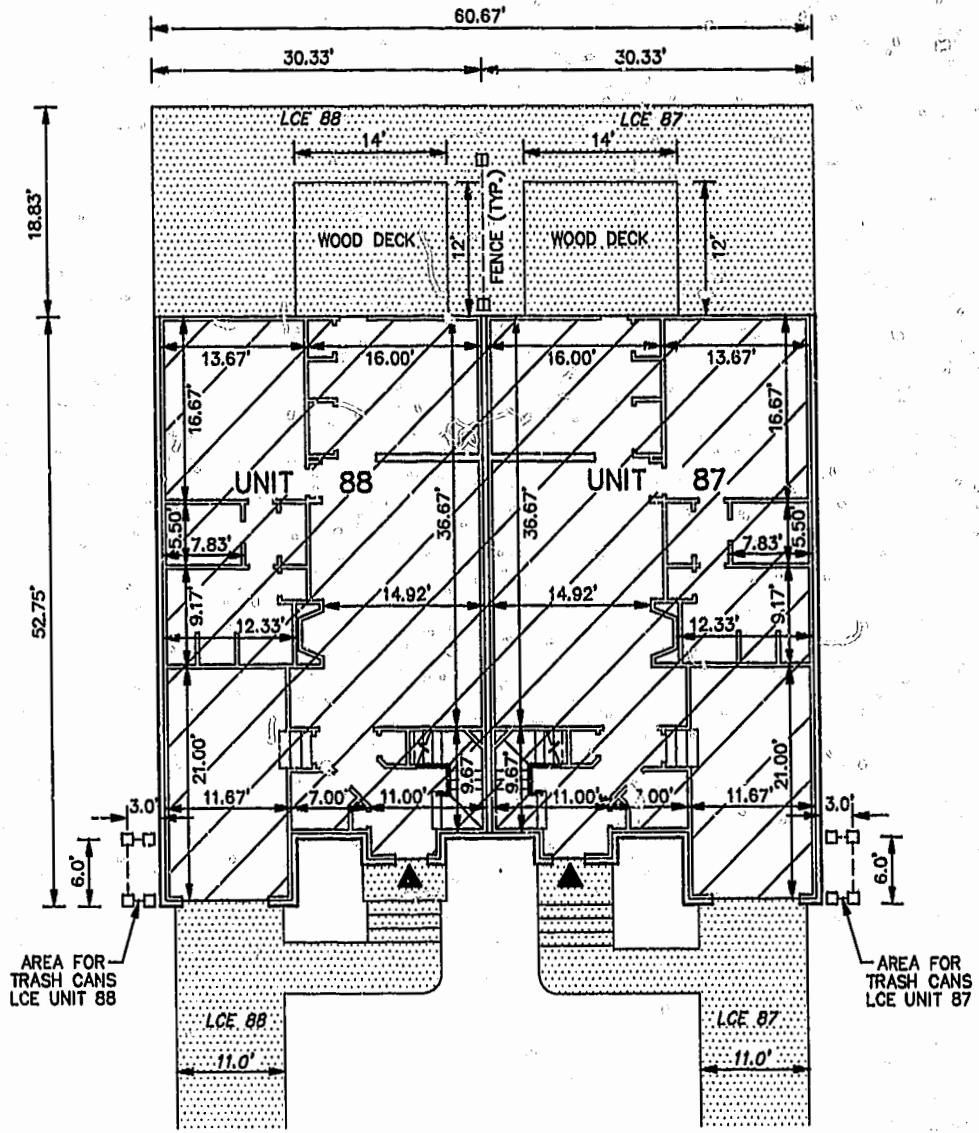

EXHIBIT B-5
 SUPPLEMENTAL CONDOMINIUM PLAN
 OF
 WYNDHAM PLANTATION
 CONDOMINIUM

WILLIAMSBURG, VIRGINIA
 SCALE: 1"=10' JANUARY 23, 2001

JOHN E. SIRINE AND ASSOCIATES, LTD.
 SURVEYORS • ENGINEERS • PLANNERS
 VIRGINIA BEACH, VIRGINIA
 (757) 486-4910

FIRST FLOOR - BUILDING 14
 SCALE: 1"=10'



NOTES:

1. BUILDING DIMENSIONS SHOWN HEREON ARE INTERIOR DIMENSIONS. THESE DIMENSIONS ARE IN FEET AND WERE TAKEN FROM PLANS SUPPLIED ENTITLED "WYNDHAM PLANTATION AT WILLIAMSBURG, FLOOR PLANS" BY PROGRESSIVE DESIGNS DATED 11/19/98.
2. INTERIOR UNIT CONFIGURATIONS AND PARTITIONS AS DEPICTED HEREON ARE FOR THE PURPOSE OF ILLUSTRATION ONLY AND MAY NOT REPRESENT THE INTERIOR OF A UNIT AS ACTUALLY CONSTRUCTED.

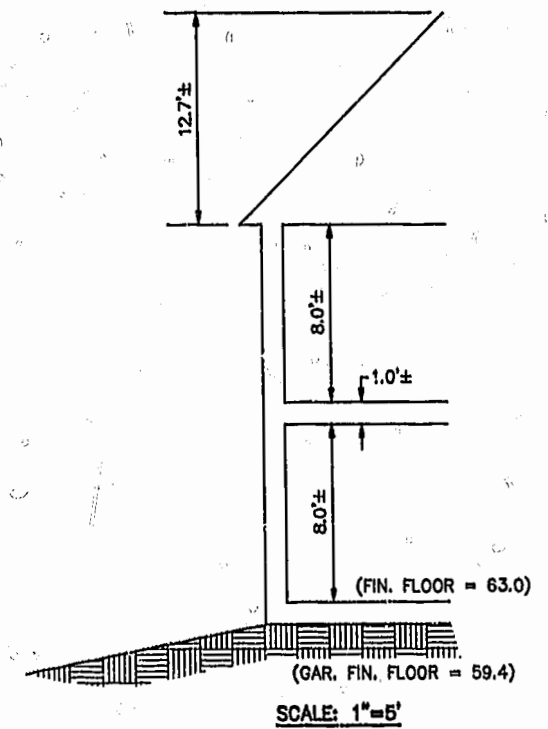

UNIT AREA
 LIMITED COMMON ELEMENT TO THE UNIT INDICATED (LCE)
 INDICATES FRONT ENTRANCE TO UNIT

| PHASE | UNIT No. | UNIT ADDRESS | UNIT AREA |
|-------|----------|------------------|------------|
| 6 | 87 | 341 ZELKOVA ROAD | 1,957 S.F. |
| 6 | 88 | 345 ZELKOVA ROAD | 1,957 S.F. |

THE UNDERSIGNED CERTIFIES THAT THESE PLANS ARE ACCURATE AND COMPLY WITH THE PROVISIONS OF CODE OF VIRGINIA, SECTION 55-79.58.B AND THAT ALL UNITS OR PORTIONS THEREOF DEPICTED HEREON AND ALL COMMON ELEMENTS HAVE BEEN SUBSTANTIALLY COMPLETED.

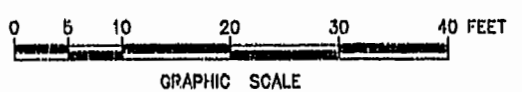

PLAT RECORDED IN
 P.D. NO. 80 PAGE 6-11

SIGNED: JEFFREY D. WILLIAMS
 WILLIAMSBURG/JAMES CITY COUNTY
 JEFFREY D. WILLIAMS, L.S.

