

T.P. 372-(0A)-00-030
NOW OR FORMERLY
JEROME & EVELYN RANDOLPH
(D.B. 37, PG. 379)
ZONE: RM-2

PHASE 3
BLDG. 800
SEE SHEET 2

ADDITIONAL LAND

ADDITIONAL LAND

MATCH LINE
SEE SHEET 2
ROLAND STREET
40' R/W

T.P. 372-(0A)-00-004
NOW OR FORMERLY
CECIL AND ALICE M. CROPPER
(D.B. 48, PG. 546)
ZONE: RM-2

ADDITIONAL LAND

ADDITIONAL LAND

MATCH LINE
SEE SHEET 2

T.P. 372-(0A)-00-003
NOW OR FORMERLY
LEONARD & BEATRICE LEGUM
(D.B. 55, PG. 114)
ZONE: RM-2

(COMMON ELEMENT)

COMMON

T.P. 372-(05)-00-001
NOW OR FORMERLY
CHESAPEAKE MEDIA, INC.
(D.B. 74, PG. 121)
(M.B. 42, PG. 25)
ZONE: B-2 CONDITIONAL

T.P. 402-01-00A
NOW OR FORMERLY
LULA LORAIN OLIVER
(D.B. 83, PG. 360)
ZONE: RM-2

ADDITIONAL LAND

ADDITIONAL LAND

T.P. 372-(04)-00-00-A2
NOW OR FORMERLY
CITY OF WILLIAMSBURG
(D.B. 121, PG. 321)
(M.B. 36, PG. 77)

(FIRST FLOOR) (SECOND FLOOR)

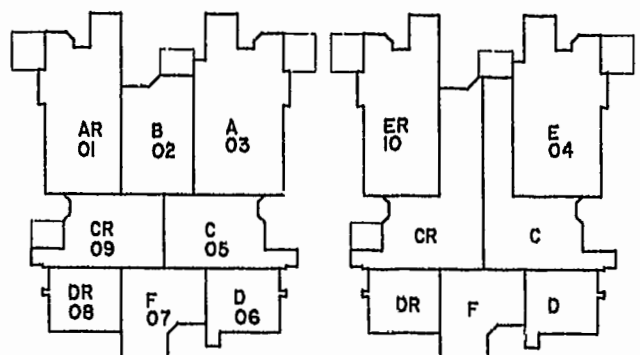

TYPICAL CONDOMINIUM LAYOUT

PLAT RECORDED IN
P.B. NO. 79 PAGE 62-65

Williamsburg/James City County
10:27 AM
14 day of Dec. 2000
DOCUMENT # AD 1346
Christopher D. Capozzi, Clerk



BRISTOL COMMONS
A CONDOMINIUM COMMUNITY
PHASE THREE
FOR
KEY GROUP, LLC
CITY OF WILLIAMSBURG, VIRGINIA

Hassell & Polkes, P.C. Engineers Surveyors Planners Chesapeake, VA 23320 (757) 547-9531	SIZE: C	CONTRACT NO: 98062	DISK/BOX: 123C/15	FILENAME: BRISTOL3.DWG	REV.
SCALE: 1" = 50'		DATE: 11/16/00		SHEET 3 of 4	

