

LINE	RADIUS	ARC	CHORD BEARING	CHORD	DELTA	TANGENT
C1	330.00'	134.44'	N67°09'30"E	133.52'	23°20'34"	68.17'

50-2-⑨-22  
 PARCEL 22  
 P.B. 35 PG. 61

50-2-①-77  
 PARCEL 60  
 P.B. 33 PG. 72  
 4.6814 AC.  
 203923 S.F.

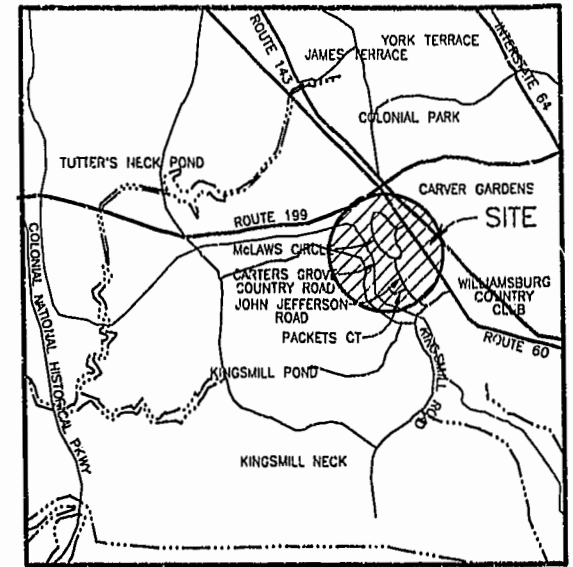

VICINITY MAP SCALE: 1" = 2000'

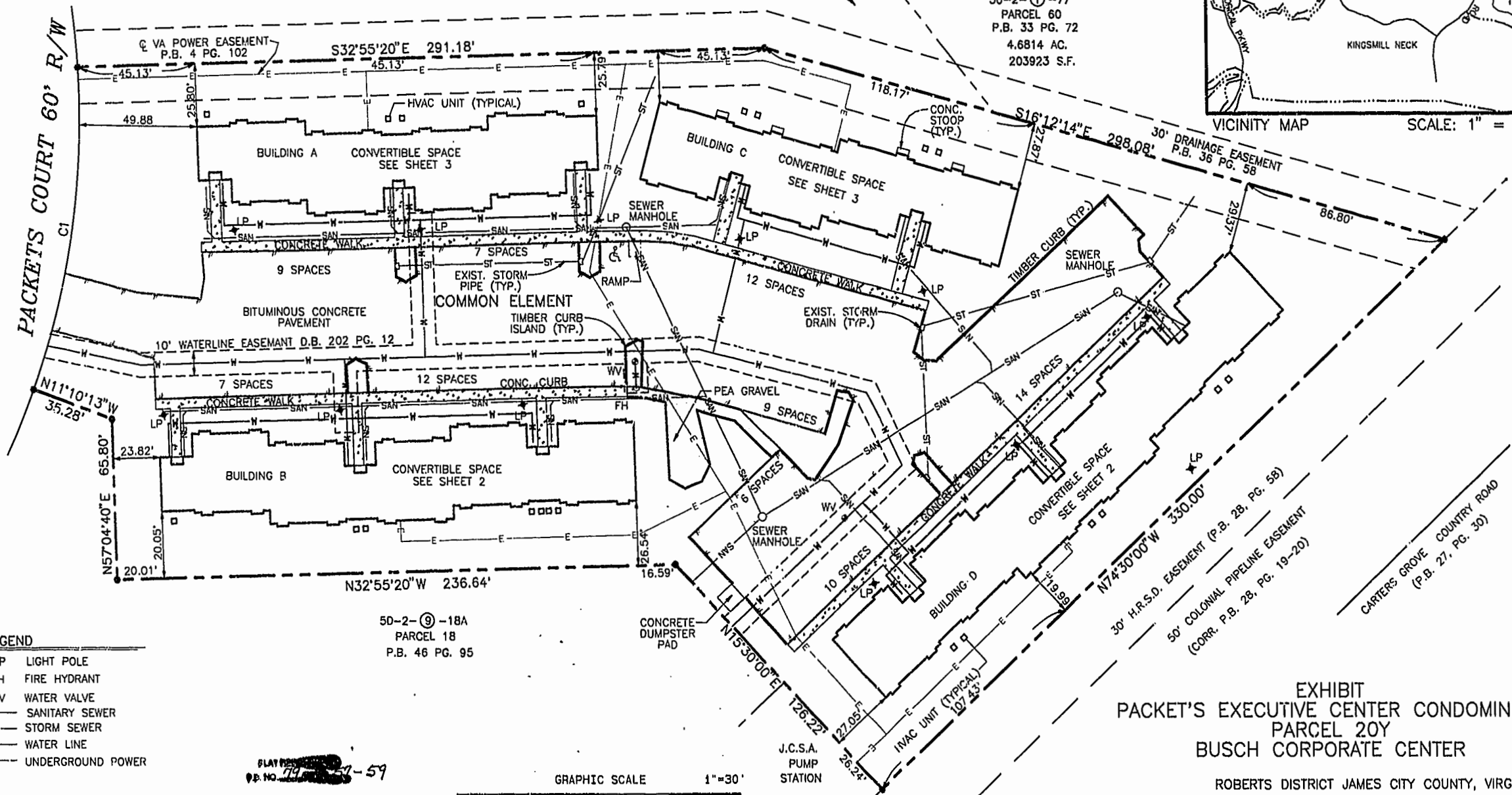

50-2-⑨-18A  
 PARCEL 18  
 P.B. 46 PG. 95

- LEGEND**
- ✕ LP LIGHT POLE
  - ⊕ FH FIRE HYDRANT
  - ⊙ WV WATER VALVE
  - SW SANITARY SEWER
  - ST STORM SEWER
  - W WATER LINE
  - E UNDERGROUND POWER

- NOTES:**
1. ORIGINAL FIELD SURVEY 11/21/80. AUGMENTED BY FIELD SURVEY 10/22/00
  2. THIS DOCUMENT WAS PREPARED WITHOUT A TITLE REPORT AND MAY NOT REFLECT ALL EASEMENTS OR ENCUMBRANCES AFFECTING THE SUBJECT PROPERTY.
  3. THE PROPERTY SHOWN HEREON IS LOCATED IN FLOOD ZONE X (AREAS OUTSIDE OF 500 YEAR FLOOD PLAIN), FLOOD DESIGNATION AND INFORMATION ARE TAKEN FROM FEMA MAP NO. 510201-0050B, DATED FEBRUARY 6, 1991.
  4. THIS PROPERTY IS SUBJECT TO RESTRICTIVE COVENANTS AND EASEMENTS OF RECORD.

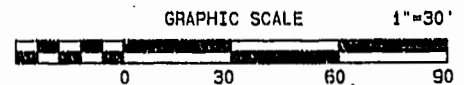

**SURVEYORS CERTIFICATE:**

I HEREBY CERTIFY THAT TO THE BEST OF MY KNOWLEDGE AND BELIEF, THIS PLAT COMPLIES WITH THE PROCEDURES AND STANDARDS ESTABLISHED BY THE BOARD FOR ARCHITECTS, PROFESSIONAL ENGINEERS, LAND SURVEYORS, CERTIFIED INTERIOR DESIGNERS, AND LANDSCAPE ARCHITECTS IN THE COMMONWEALTH OF VIRGINIA.

DATE: 11-28-00

STEPHEN A. ROMEO L.S.



EXHIBIT  
 PACKET'S EXECUTIVE CENTER CONDOMINIUM  
 PARCEL 20Y  
 BUSCH CORPORATE CENTER  
 ROBERTS DISTRICT JAMES CITY COUNTY, VIRGINIA  
 SCALE: 1" = 30' DATE: 11/28/00  
 SHEET 1 OF 3

**LANDMARK DESIGN GROUP**

Engineers • Planners • Surveyors  
 Landscape Architects • Environmental Consultants

4029 Ironbound Road  
 Suite 100  
 Williamsburg, VA 23188  
 Tel: (757) 253-2975  
 Fax: (757) 229-0049  
 Email: lmdg@landmarkdgb.com

5544 Greenwich Road  
 Suite 200  
 Virginia Beach, VA 23462  
 Tel: (757) 473-2000  
 Fax: (757) 497-7933  
 Email: lmdg@landmarkdgb.com