

T.P. 372-(0A)-00-030  
NOW OR FORMERLY  
**JEROME & EVELYN RANDOLPH**  
(D.B. 37, PG. 379)  
ZONE: RM-2

ADDITIONAL LAND

ADDITIONAL LAND

ADDITIONAL LAND

**MATCH LINE** ROLAND STREET  
SEE SHEET 2  
40' R/W

**MATCH LINE**  
SEE SHEET 2

T.P. 372-(0A)-00-004  
NOW OR FORMERLY  
**CECIL AND ALICE M. CROPPER**  
(D.B. 48, PG. 546)  
ZONE: RM-2

ADDITIONAL LAND

ADDITIONAL LAND

T.P. 372-(05)-00-001  
NOW OR FORMERLY  
**CHESAPEAKE MEDIA, INC.**  
(D.B. 74, PG. 121)  
(M.B. 42, PG. 25)  
ZONE: B-2 CONDITIONAL

T.P. 372-(0A)-00-003  
NOW OR FORMERLY  
**LEONARD & BEATRICE LEGUM**  
(D.B. 55, PG. 114)  
ZONE: RM-2

ADDITIONAL LAND

ADDITIONAL LAND

T.P. 402-01-00A  
NOW OR FORMERLY  
**LULA LORAIN OLIVER**  
(D.B. 83, PG. 360)  
ZONE: RM-2

T.P. 372-(04)-00-00-A2  
NOW OR FORMERLY  
**CITY OF WILLIAMSBURG**  
(D.B. 121, PG. 321)  
(M.B. 36, PG. 77)

(FIRST FLOOR)

(SECOND FLOOR)

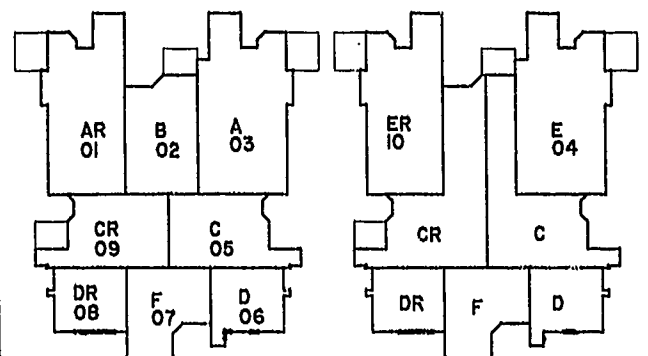

**TYPICAL CONDOMINIUM LAYOUT**

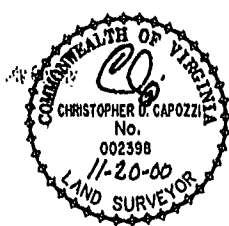

Williamsburg/James City County  
2:54 PM  
Recorded 4 day of Dec 2000  
DOCUMENT # 501310  
Clerk

**AMENDED  
BRISTOL COMMONS  
A CONDOMINIUM COMMUNITY  
PHASE TWO**

FOR  
**KEY GROUP, LLC**  
CITY OF WILLIAMSBURG, VIRGINIA

Hassell & Polkes, P.C. Engineers Surveyors Planners Chesapeake, VA 23320 (757) 547-9531	SIZE C	CONTRACT NO 98062	DISK/BOX 123B/15	FILENAME BRISTOL-2-REV.DWG	REV.
SCALE: 1" = 50'		DATE: 10/26/00		SHEET 3 of 6	