

NOW OR FORMERLY COLLEGE OF WILLIAM & MARY

IRONBOUND

(M.B. 71, PG. 73)



T.P. 372-(OA)-00-028
NOW OR FORMERLY
JEROME & EVELYN RANDOLPH
(D.B. 30, PG. 470)
ZONE: RM-2

T.P. 372-(DA)-00-030
NOW OR FORMERLY
JEROME & EVELYN RANDOLPH
(D.B. 37, PG. 379)
ZONE: RM-2

T.P. 372-(05)-00-001
NOW OR FORMERLY
CHESAPEAKE MEDIA, INC.
(D.B. 74, PG. 121)
(M.B. 42, PG. 25)
ZONE: B-2 CONDITIONAL

**MATCH LINE
SEE SHEET 3**

**MATCH LINE
SEE SHEET 3**

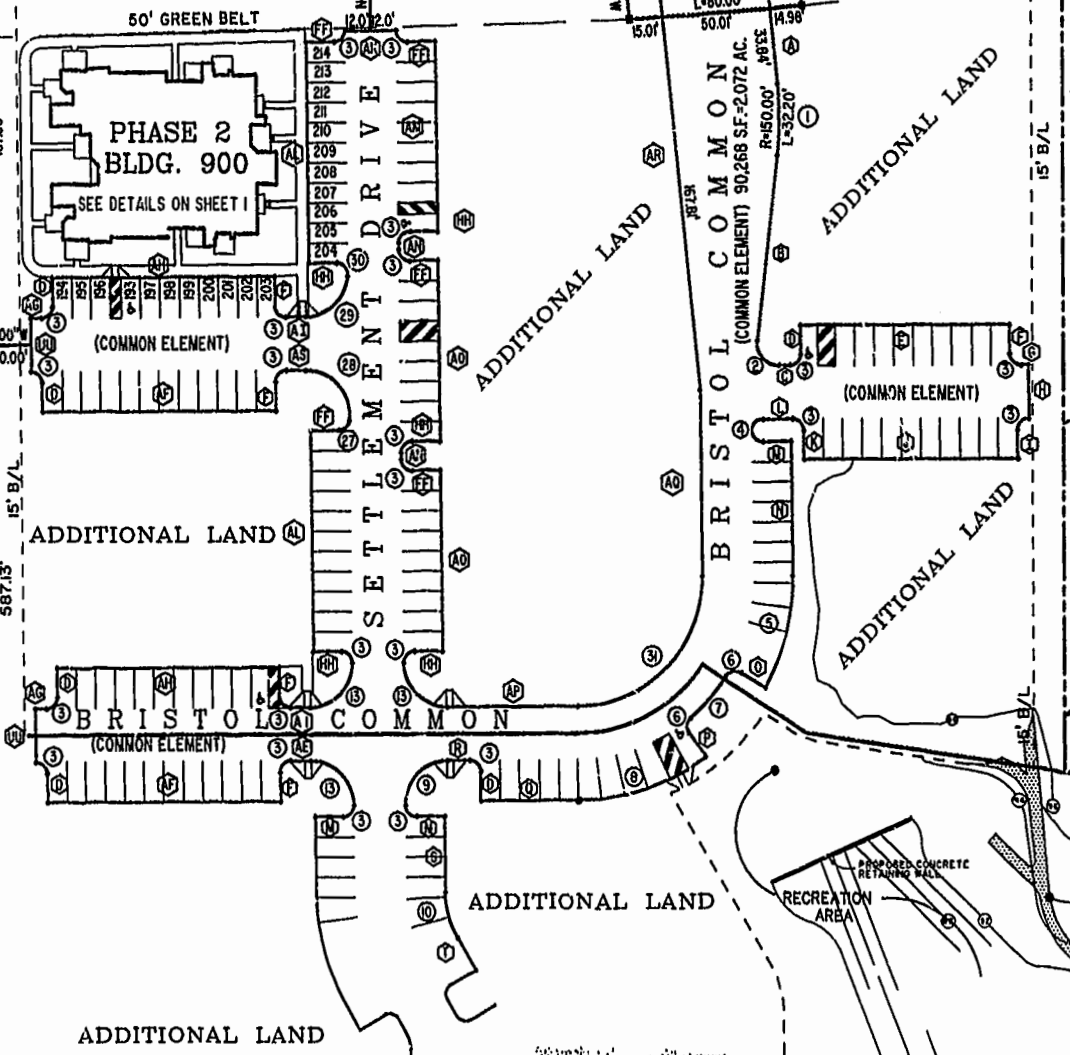

ROLAND STREET
40' R/W

(APPROX. R/W)
ROAD

Recorded
2:54 PM
4/10/00
DOCUMENT # 001310
Clark

PLAT RECORDED IN
P.L. NO. 79 PAGE 52-55

AMENDED
BRISTOL COMMONS
A CONDOMINIUM COMMUNITY
PHASE TWO
FOR
KEY GROUP, LLC
CITY OF WILLIAMSBURG, VIRGINIA

Hassell & Polkes, P.C. Engineers Surveyors Planners Chesapeake, VA 23320 (757) 547-9531	SIZE C	CONTRACT NO 98062	DISK/BOX 123B/15	FILENAME BRISTOL-2-REV.DWG	REV.
	SCALE: 1"=50'	DATE: 10/26/00	SHEET 2 of 6		