

CURVE TABLE					
CURVE	LENGTH	RADIUS	TANGENT	CHORD DIRECTION	CHORD DELTA
C1	93.47'	30.00'	2311.73'	N61°34'23"E	55.94°
C2	74.92'	115.00'	36.04'	S94°19'26"W	73.60°

COMMONWEALTH OF VIRGINIA
 KONGAS E. WHITE
 NO. 1035
Kongas E. White
 LAND SURVEYOR
 9-27-00

CONDOMINIUM PLAT
 OF
 SECTION 1A
 (A PORTION OF PHASE 2)
 BRANDON WOODS
 JAMES CITY COUNTY, VIRGINIA
 SCALE: 1"=20' DATE: 9/17/00
 SHEET 3 OF 4

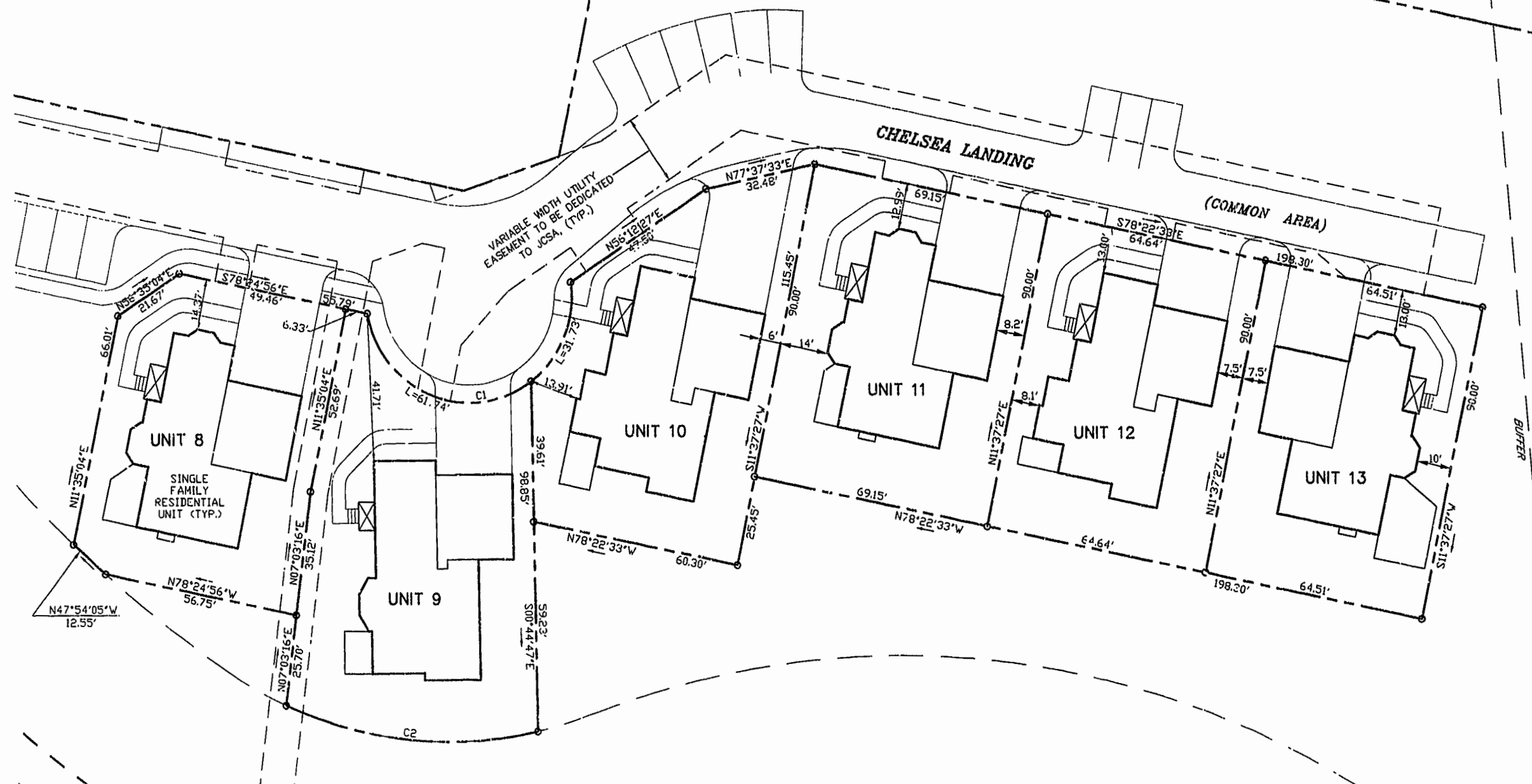

Williamsburg/James City County

11:25 AM
 Recorded on 4 day of Oct. 2000
 DOCUMENT # 000019238
 Moxa Brown, Dip. Clerk
 BETSY B. WOODRIDGE, CLERK

PLAT RECORDED
 P.B. NO. 78-92



Engineers • Planners • Surveyors
 Landscape Architects • Environmental Consultants
 4029 IRONBOUND ROAD SUITE 100
 WILLIAMSBURG, VA 23188
 TEL (757) 253-2975 FAX(757) 229-0049

DRAWN BY: LFV
 CHKD. BY: DEW
 PROJ. NO.: 1980074
 DWG. NO.: 11841