

FIRST FLOOR BUILDING 22

(NOT YET COMPLETE)
SCALE: 1" = 10'

EXHIBIT B-1 SUPPLEMENTAL CONDOMINIUM PLANS OF

WYNDHAM PLANTATION CONDOMINIUM

WILLIAMSBURG, VIRGINIA

DATE: JUNE 20, 2000 SCALE: 1"=10'

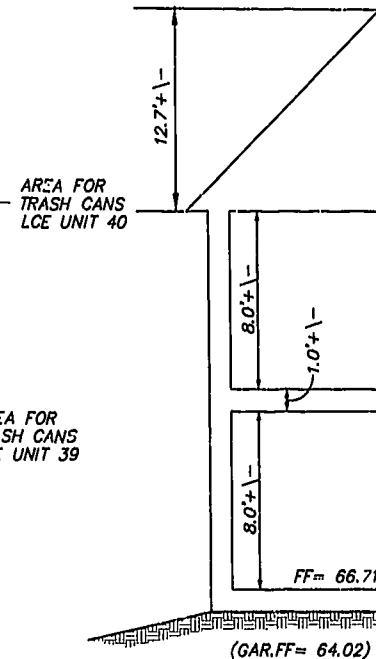
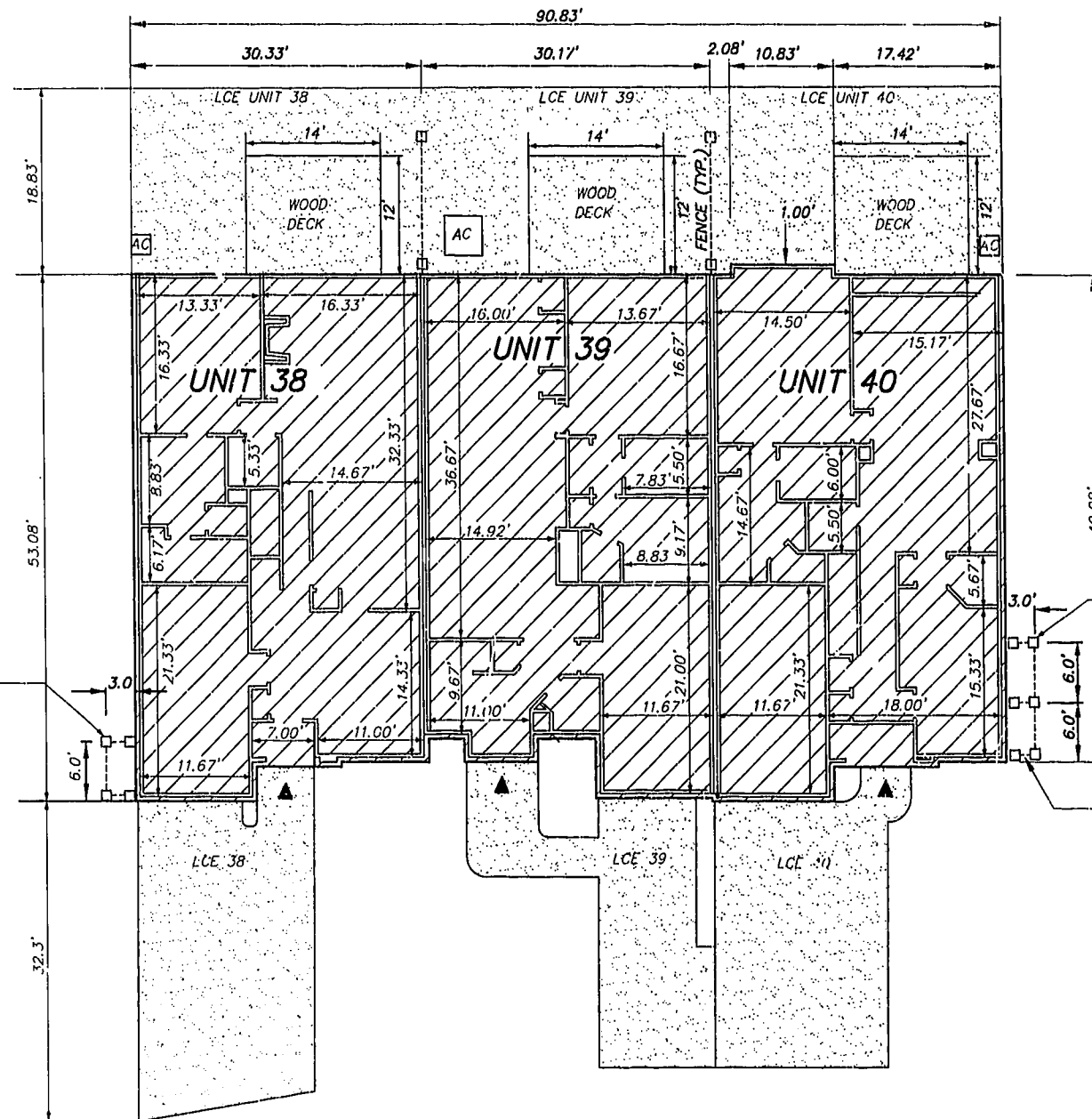

NOTES:

- 1) BUILDING DIMENSIONS SHOWN HEREON ARE INTERIOR DIMENSIONS. THESE DIMENSIONS ARE IN FEET AND WERE TAKEN FROM PLANS SUPPLIED ENTITLED "WYNDHAM PLANTATION AT WILLIAMSBURG, FLOOR PLANS" BY PROGRESSIVE DESIGNS DATED 11/19/98
- 2) INTERIOR UNIT CONFIGURATIONS AND PARTITIONS AS DEPICTED HEREON ARE FOR THE PURPOSE OF ILLUSTRATION ONLY AND MAY NOT REPRESENT THE INTERIOR OF A UNIT AS ACTUALLY CONSTRUCTED.

PHASE	UNIT No.	UNIT ADDRESS	UNIT AREA
1	38	437 ZELKOVA DRIVE	1,799 S.F.
1	39	441 ZELKOVA DRIVE	1,957 S.F.
1	40	445 ZELKOVA DRIVE	1,853 S.F.

I HEREBY CERTIFY THAT THIS PLAN IS ACCURATE AND THAT IT COMPLIES WITH SECTION 55-79.58(B) OF THE VIRGINIA CONDOMINIUM ACT AS AMENDED AND THAT ALL UNITS OR PORTION THEREOF DEPICTED HEREON HAVE BEEN SUBSTANTIALLY COMPLETED EXCEPT AS OTHERWISE NOTED.

SIGNED: _____

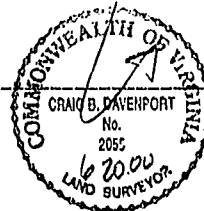

DATE: 6/20/00

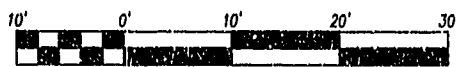

SCALE 1"=10'

UNIT AREA
 LIMITED COMMON ELEMENT TO THE UNIT INDICATED (LCE)

INDICATES FRONT ENTRANCE TO UNIT

2:52 PM
day of June 2000
DOCUMENT # 200 678
By *Brian B. Nicolais* Clerk
By *Christina H. Brinkley* Dep. Clerk

Rickmond Engineering, Inc.

1643 Merrimac Trail
Williamsburg VA 23185
Voice: (757) 229-1776
Fax No. (757) 229-4683

Engineering
Surveying
Land Planning
www.rickmond.com

PLAT RECORDED IN
P.L. NO. 48 PAGE 6-9