

CERTIFICATION OF SOURCE OF TITLE

THIS IS TO CERTIFY THAT THE LAND EMBRACED IN THIS PROPERTY LINE ADJUSTMENT IS IN THE NAME OF JAMES L. & MARLENE J. SIMMONS AND WAS ACQUIRED FROM FRED J. III & NETTIE W. HELFRICH BY DEED DATED DECEMBER 09, 1965 AND DULY RECORDED IN THE CLERK'S OFFICE OF THE CIRCUIT COURT OF THE CITY OF WILLIAMSBURG AND THE COUNTY OF JAMES CITY, VIRGINIA IN D.B.104, PG.97-99.

OWNER'S CONSENT AND DEDICATION

THE SUBDIVISION OF LAND SHOWN ON THIS PLAT IS WITH THE FREE CONSENT AND IN ACCORDANCE WITH THE DESIRES OF THE UNDERSIGNED OWNERS.

James L. Simmons 5/5/2000 DATE
MARLENE J. SIMMONS 5/5/2000 DATE

NOTARY

STATE OF VIRGINIA, CITY/COUNTY OF JAMES CITY, TO-WIT:

I, THOMAS C. SUBLETT A NOTARY PUBLIC IN AND FOR THE CITY/COUNTY AND STATE AFORESAID, DO HEREBY CERTIFY THAT THE ABOVE PERSON WHOSE NAME IS SIGNED TO THE FOREGOING WRITING HAS ACKNOWLEDGED THE SAME BEFORE ME IN MY CITY/COUNTY AND STATE AFORESAID.

GIVEN UNTO MY HAND THIS 5th DAY OF MAY, 2000.

MY COMMISSION EXPIRES DEC 31, 2002.

Thomas C. Sublett NOTARY PUBLIC

SURVEYOR'S CERTIFICATE

I HEREBY CERTIFY THAT TO THE BEST OF MY KNOWLEDGE AND BELIEF, THIS PLAT COMPLIES WITH ALL OF THE REQUIREMENTS OF THE BOARD OF SUPERVISORS AND ORDINANCES OF THE COUNTY OF JAMES CITY, VIRGINIA, REGARDING THE PLATTING OF SUBDIVISIONS WITHIN THE COUNTY.

Thomas C. Sublett 5/5/00 DATE
THOMAS C. SUBLETT, L.S. #1886

CERTIFICATE OF APPROVAL

THIS SUBDIVISION IS APPROVED BY THE UNDERSIGNED IN ACCORDANCE WITH EXISTING SUBDIVISION REGULATIONS AND MAY BE ADMITTED TO RECORD.

John F. Hagan 5/9/00 DATE
Virginia Department of Transportation
Theresa Cohen 5-10-00 DATE
Virginia Department of Health
Subdivision Agent of the County of James City 6/12/00 DATE

STATE OF VIRGINIA
COUNTY OF JAMES CITY

IN THE CLERK'S OFFICE OF THE CIRCUIT COURT OF THE COUNTY OF JAMES CITY, THIS 15th DAY OF MAY, 2000. THE MAP SHOWN HEREON WAS PRESENTED AND ADMITTED TO THE RECORD AS THE LAW DIRECTS.

TESTE: Clerk

PLAT BOOK 77, PAGE 53

Recorded 15th day of May, 2000
DOCUMENT # 00002877 9:30

GRAPHIC SCALE
100' 0' 100' 200'
SCALE: 1" = 100'

TXMP(14-1)(6-15)
GLENWOOD ACRES
LOT 15
(PB44 P 53)

TXMP(14-1)(6-15A)
JAMES CITY CO.
WELL LOT

TXMP(14-1)(1-18)
N/F
THELMA INEZ MILHALCOE
(DB 494 P 423)

TXMP(14-1)(1-17)
N/F
JOHN L. & PHYLLIS J CODY
INSTR. #0000001011

TXMP(14-1)(2-13,14,15)
ELMWOOD
SECTION ONE
(PB 31 P.31)

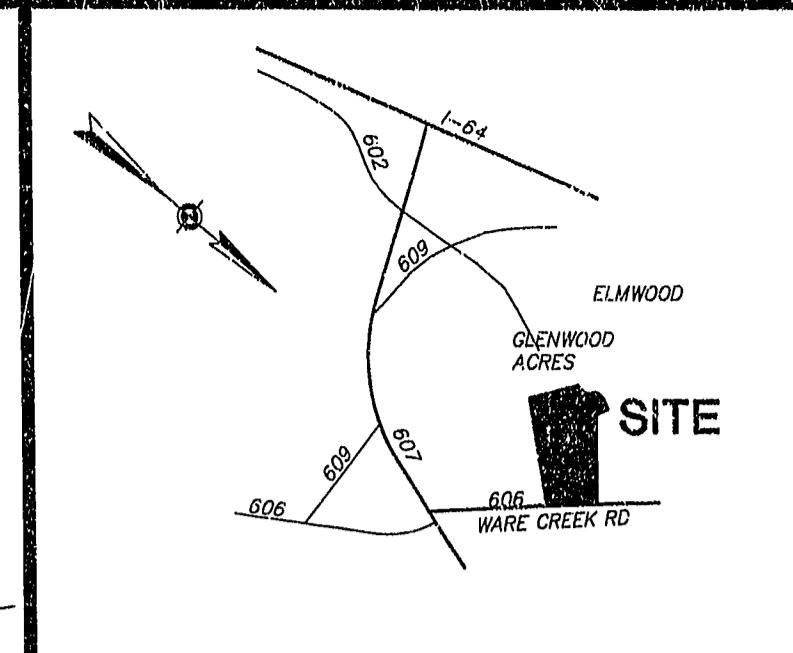

GENERAL NOTES

- 1. TOTAL AREA = 1,033,046 S.F. OR 23.7± ACRES
2. PROPERTY SHOWN HEREON IS ALL OF TAX MAP PARCEL NO. (14-1)(1-16)
3. PROPERTY IS CURRENTLY ZONED "A-1" GENERAL AGRICULTURAL.
4. LOT IS SERVED BY PRIVATE WATER AND SEWER.
5. ALL NEW UTILITIES ARE TO BE PLACED UNDERGROUND.

SYMBOLS DENOTE

- PIPE FOUND
PIPE SET
ROD FOUND/SET
CONC. MONUMENT

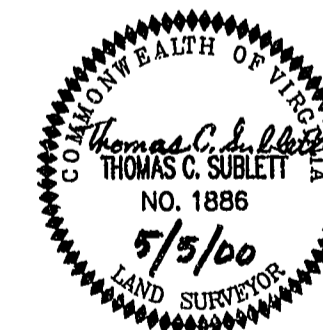

Thomas C. Sublett
HEREBY CERTIFY THAT THE SURVEY REPRESENTED BY THIS PLAT WAS MADE ON THIS DATE AND IS CORRECT TO THE BEST OF MY KNOWLEDGE AND BELIEF. THERE ARE NO ENCROACHMENTS OF OTHER BUILDINGS UNLESS SHOWN HEREON.

FLOOD INSURANCE RATE MAP
ZONE X
COMMUNITY NO. 510201
PANEL NO. 0010B
DATE OF FIRM 02-06-91

TAX PARCEL (14-1) (1-16)
ADDRESS: 4567 WARE CREEK ROAD

SUBDIVISION OF THE PROPERTY OF:
JAMES L. AND MARLENE J. SIMMONS

PARCEL NO. 4
M.A. ROULAND ESTATE
"SAW PIT TRACT"
STONEHOUSE DISTRICT
JAMES CITY COUNTY, VIRGINIA

THOMAS LAND SURVEYING, P.C.
3402 ACORN STREET, SUITE 204
WILLIAMSBURG, VIRGINIA 23188
TEL. 258-1410