

- DOORS**
- ① 3'0" x 6'0" x 1 3/4" PAN. EXT. PLANK - FULL PLATE CLOSERS SINGLE CYLINDER DEADBOLT BUMPETS. AS INDICATED, VENERED/4.
 - ② 3'0" x 6'0" x 1 3/8" FRENCH TULANE LEVER SETS
 - ③ 3'0" x 6'0" x 1 3/8" S.C. BIRCH TULANE LEVER SETS
 - ④ 2'0" x 6'0" x 1 3/8" PAN W/O BIFOLD FULL HANDLE
 - ⑤ 3'2" x 6'0" S.C. BIRCH

NOTE: TULANE H.W. BY KWIK-SET (TITAN SERIES)

HANDICAP TOILET FAC.
 SIGNS - TO READ "RESTROOM" AND INCLUDE PICT. GRAPHIC SYMBOLS. SIGNS ALSO TO INCLUDE BRAIL.

RAILS & TOILET
 36" RAIL BEHIND W.C.
 42" RAIL BESIDE W.C. 10" FR. WALL

TOILET LOCATION
 @ 10' FR. WALL

LAVS - APPROVED REDESTAL LAV W/ SHIELD FROM H/W LINE

HANDICAP DRINKING FOUNTAIN
 BARRIER-FREE WATER COOLER BY GUNROC, LOC. AS NOTED. 34 1/2" A.F.F. PER BOCA 110.6

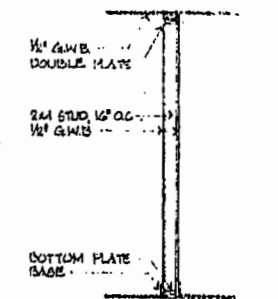

FLOOR PLAN

| | | |
|--------|------------------------|--------------------|
| AREA | LEFT SUITE: 1834 S.F. | 1284 S.F. (INSIDE) |
| | RIGHT SUITE: 1186 S.F. | 1074 S.F. (INSIDE) |
| TOTAL: | 2710 S.F. | 2378 S.F. (INSIDE) |

PLAT RECORDED IN P.B. NO. 76 PAGE 33

10:10 AM
 Recorded 19 day of Jan 2000
 DOCUMENT # 100001278
John A. Belandier clerk

BUILDING #3 - QUARTERLAND COMMONS, PHASE B
 JAMES CITY COUNTY, VA
 JIM GRIFFITH, BUILDER, INC.

| | |
|-------|---|
| Date | |
| Scale | |
| Drawn | |
| Job | |
| Sheet | 2 |