

COPYRIGHT ADC (THE MAP PEOPLE) PERMITTED USE NO. 20299652
VICINITY MAP SCALE: 1" = 2000'

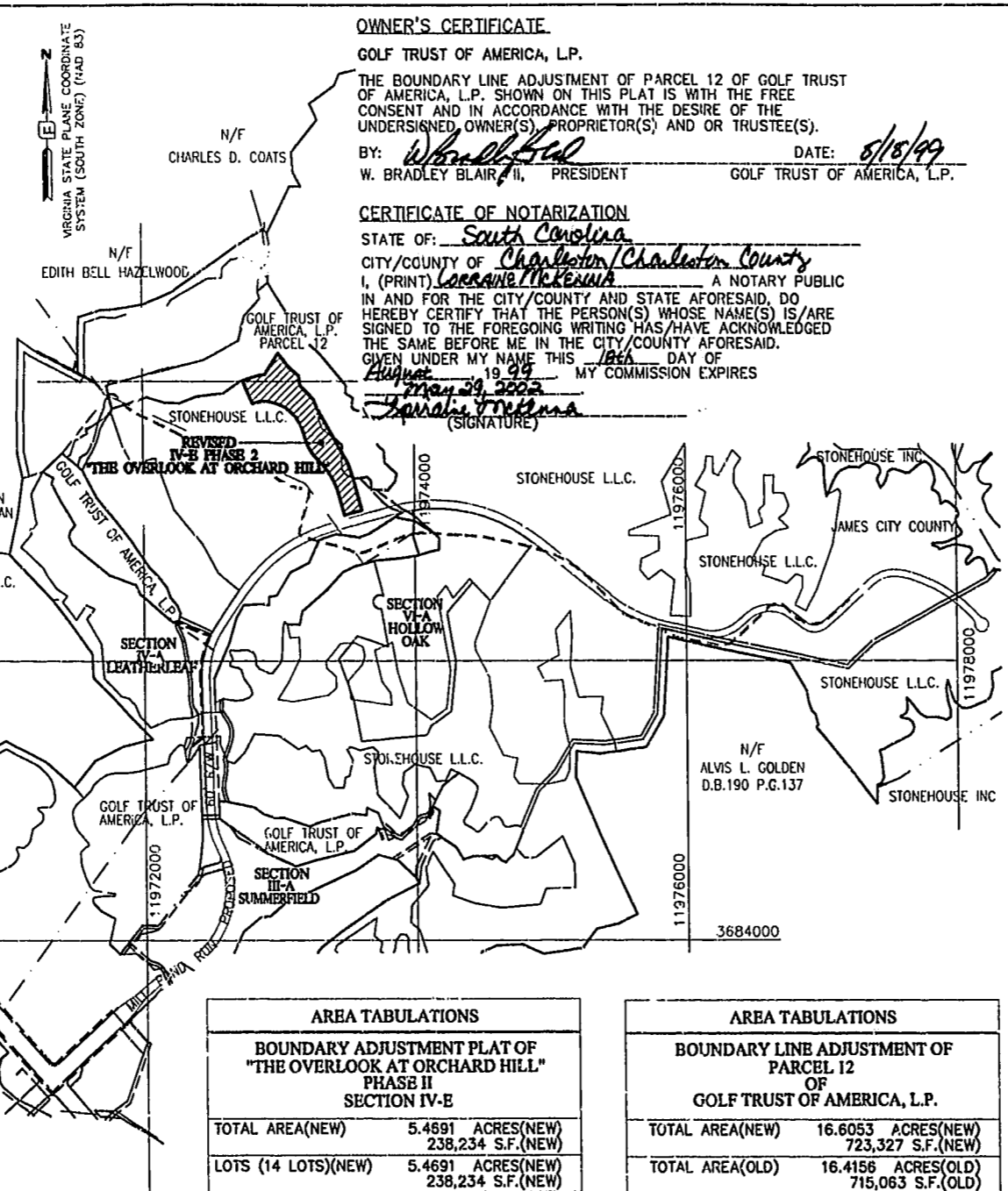

AREA TABULATIONS	
BOUNDARY ADJUSTMENT PLAT OF "THE OVERLOOK AT ORCHARD HILL" PHASE II SECTION IV-E	
TOTAL AREA(NEW)	5.4691 ACRES(NEW) 238,234 S.F.(NEW)
LOTS (14 LOTS)(NEW)	5.4691 ACRES(NEW) 238,234 S.F.(NEW)
TOTAL AREA(OLD)	4.6529 ACRES(OLD) 202,680 S.F.(OLD)
LOTS (18 LOTS)(OLD)	4.6529 ACRES(OLD) 202,680 S.F.(OLD)

AREA TABULATIONS	
BOUNDARY LINE ADJUSTMENT OF PARCEL 12 OF GOLF TRUST OF AMERICA, L.P.	
TOTAL AREA(NEW)	16.6053 ACRES(NEW) 723,327 S.F.(NEW)
TOTAL AREA(OLD)	16.4156 ACRES(OLD) 715,063 S.F.(OLD)

- NOTES :**
- THIS PLAT WAS BASED ON INFORMATION OF RECORD, INFORMATION PROVIDED BY THE OWNER AND INFORMATION PURSUANT TO AN ACTUAL SURVEY.
 - THIS PROPERTY IS REFERENCED TO THE VIRGINIA STATE PLANE COORDINATE SYSTEM (SOUTH ZONE) "NAD 83".
 - THIS PROPERTY IS ZONED PUD-R WITH PROFFERS.
 - THIS BOUNDARY ADJUSTMENT PLAT COMPLIES WITH THE PROFFERS APPLICABLE TO THE PROPERTY, RECORDED IN JAMES CITY COUNTY D.B. 747, PG. 476.
 - SETBACK REQUIREMENTS FOR THE "THE OVERLOOK AT ORCHARD HILL" PHASE II SUBDIVISION ARE SPECIFIED IN THE DESIGN CRITERIA STANDARDS AND GUIDELINES FOR STONEHOUSE, VIRGINIA AS PREPARED BY STONEHOUSE LIMITED LIABILITY COMPANY, PUBLISHED BY THE ENVIRONMENTAL REVIEW COMMITTEE.
 - UTILITY AND OTHER EASEMENTS ARE RESERVED PURSUANT TO THE DECLARATION RECORDED IN DOCUMENT NO. 97-0015414, IN THE CLERK'S OFFICE OF THE CIRCUIT COURT OF JAMES CITY COUNTY AS THE SAME MAY BE AMENDED OR SUPPLEMENTED FROM TIME TO TIME.
 - ALL UTILITY EASEMENTS SHOWN ON THIS PLAT ARE HEREBY DEDICATED TO THE JAMES CITY SERVICE AUTHORITY.
 - ALL DRAINAGE EASEMENTS SHOWN ON THIS PLAT ARE HEREBY DEDICATED TO STONEHOUSE, L.L.C.
 - THE VIRGINIA DEPARTMENT OF TRANSPORTATION IS HELD HARMLESS FROM ALL RESPONSIBILITY OF STORMWATER MANAGEMENT FACILITIES.
 - ALL ROADS ARE HEREBY DEDICATED FOR PUBLIC STREET PURPOSES.
 - ALL LOTS ARE SERVED BY PUBLIC WATER AND SANITARY SEWER.
 - ALL OTHER UTILITIES, ELECTRIC POWER, TELEPHONE, NATURAL GAS, ETC. SHALL BE PLACED UNDERGROUND.
 - ALL IRRIGATION EASEMENTS SHOWN ON THIS PLAT WERE DEDICATED TO GOLF TRUST OF AMERICA, L.P. BY DOCUMENT NO. 97-0009626, RECORDED IN CIRCUIT COURT, WILLIAMSBURG / JAMES CITY COUNTY.
 - ALL UTILITY EASEMENTS SHALL BE SUBJECT TO AN EXCLUSIVE 5 FT. WIDE JAMES CITY SERVICE AUTHORITY EASEMENT BASED ON 2.5 FT. EACH SIDE OF THE JAMES CITY SERVICE AUTHORITY WATER AND SEWER LINE. OTHER UTILITIES MAY CROSS THE EXCLUSIVE EASEMENT FOR ACCESS ONLY. (TYP.)

OWNER'S CERTIFICATE.
GOLF TRUST OF AMERICA, L.P.
THE BOUNDARY LINE ADJUSTMENT OF PARCEL 12 OF GOLF TRUST OF AMERICA, L.P. SHOWN ON THIS PLAT IS WITH THE FREE CONSENT AND IN ACCORDANCE WITH THE DESIRE OF THE UNDERSIGNED OWNER(S), PROPRIETOR(S) AND OR TRUSTEE(S).
BY: W. Bradley Blair II DATE: 8/18/99
W. BRADLEY BLAIR II, PRESIDENT GOLF TRUST OF AMERICA, L.P.

CERTIFICATE OF NOTARIZATION
STATE OF: South Carolina
CITY/COUNTY OF: Charleston/Charleston County
I, (PRINT) Corraine McKenna A NOTARY PUBLIC IN AND FOR THE CITY/COUNTY AND STATE AFORESAID, DO HEREBY CERTIFY THAT THE PERSON(S) WHOSE NAME(S) IS/ARE SIGNED TO THE FOREGOING WRITING HAS/HAVE ACKNOWLEDGED THE SAME BEFORE ME IN THE CITY/COUNTY AFORESAID.
GIVEN UNDER MY NAME THIS 18th DAY OF August, 1999 MY COMMISSION EXPIRES March 29, 2002
Corraine McKenna (SIGNATURE)

OWNER'S CERTIFICATE Book 75 Page 74
THE BOUNDARY ADJUSTMENT AS SHOWN ON THIS PLAT IS WITH THE FREE CONSENT AND IN ACCORDANCE WITH THE DESIRE OF THE UNDERSIGNED OWNER(S), PROPRIETOR(S) AND OR TRUSTEE(S).
STONEHOUSE LIMITED LIABILITY COMPANY,
BY: Ralph R. DeRosa DATE: 8/4/99
TITLE: RALPH R. DeROSA, PRESIDENT STONEHOUSE L.L.C.

CERTIFICATE OF NOTARIZATION
COMMONWEALTH OF VIRGINIA:
CITY/COUNTY OF: James City County
THE FOREGOING INSTRUMENT WAS ACKNOWLEDGE, SUBSCRIBED AND SWORN BEFORE ME, THIS 4th DAY OF August, 1999.
BY: Ralph R. DeRosa AS President OF STONEHOUSE LIMITED LIABILITY COMPANY, A VIRGINIA LIMITED LIABILITY COMPANY.
MY COMMISSION EXPIRES: 9/30/2002
Ralph R. DeRosa (SIGNATURE) NOTARY PUBLIC

CERTIFICATE OF SOURCE OF TITLE
THE PROPERTY SHOWN ON THIS PLAT WAS CONVEYED TO STONEHOUSE LIMITED LIABILITY COMPANY, A VIRGINIA LIMITED LIABILITY COMPANY BY THE FOLLOWING DEEDS:
FROM STONEHOUSE INC., A VIRGINIA CORPORATION BY DEED DATED MARCH 12, 1996 AND RECORDED MARCH 20, 1996 IN THE OFFICE OF THE CLERK OF THE CIRCUIT COURT OF THE COUNTY OF JAMES CITY IN DEED BOOK 778, PAGE 810 AND FROM GOLF TRUST OF AMERICA, L.P., A DELAWARE LIMITED PARTNERSHIP BY DEED DATED JUNE 6, 1997 AND RECORDED JUNE 20th, 1997 IN THE OFFICE OF THE CLERK OF THE CIRCUIT COURT OF THE COUNTY OF JAMES CITY AS DOCUMENT NO. 97-0009626 PLAT BOOK 66, PAGE. 80-88.

CERTIFICATE OF APPROVAL
THIS BOUNDARY ADJUSTMENT PLAT IS APPROVED BY THE UNDERSIGNED IN ACCORDANCE WITH EXISTING SUBDIVISION REGULATIONS AND MAY BE ADMITTED TO RECORD.
DATE: 8/31/99 John S. Hayes
DATE: 11/4/99 [Signature]
VIRGINIA DEPARTMENT OF TRANSPORTATION
SUBDIVISION AGENT OF JAMES CITY COUNTY

STATE OF VIRGINIA, COUNTY OF JAMES CITY
IN THE CLERK'S OFFICE OF THE CIRCUIT COURT
PLAT SHOWN HEREON WAS PRESENTED AND ADMITTED TO
RECORD THIS 14 DAY OF December, 1999
AS THE LAW DIRECTS.
CLERK: Hilary S. Wood By Claudia A. Berkeley Dep. Clerk
PLAT BOOK, 75 PAGE NO. 74-76



SURVEYOR'S CERTIFICATE
I HEREBY CERTIFY THAT TO THE BEST OF MY KNOWLEDGE OR BELIEF, THIS PLAT COMPLIES WITH ALL OF THE REQUIREMENTS OF THE BOARD OF SUPERVISORS AND ORDINANCES OF THE COUNTY OF JAMES CITY, VIRGINIA, REGARDING THE PLATING OF SUBDIVISIONS WITHIN THE COUNTY.
DATE: 7/28/99 NAME: [Signature]

10:26 AM 14 Dec 1999
DOCUMENT # 99-0009626
By Hilary S. Wood
By Claudia A. Berkeley Dep. Clerk

STONEHOUSE
BOUNDARY ADJUSTMENT PLAT OF "THE OVERLOOK AT ORCHARD HILL" PHASE 2 AND BOUNDARY LINE ADJUSTMENT OF PARCEL 12 OF GOLF TRUST OF AMERICA, L.P. BEING A SUBDIVISION OF STONEHOUSE LIMITED LIABILITY COMPANY
STONEHOUSE DISTRICT, JAMES CITY COUNTY
DATE: 07/12/99 REVISED 07/27/99 SCALE: 1"=700'
SHEET 1 OF 3



Langley and McDonald, P.C.
Engineers - Surveyors - Planners
Landscape Architects - Environmental Consultants
VIRGINIA BEACH WILLIAMSBURG