

FIRST FLOOR BUILDING 20

SCALE: 1" = 10'

**EXHIBIT B
CONDOMINIUM PLATS AND PLANS
FOR
WYNDHAM PLANTATION
CONDOMINIUM**

WILLIAMSBURG, VIRGINIA

DATE: SEPTEMBER 27, 1999 SCALE: 1"=10'

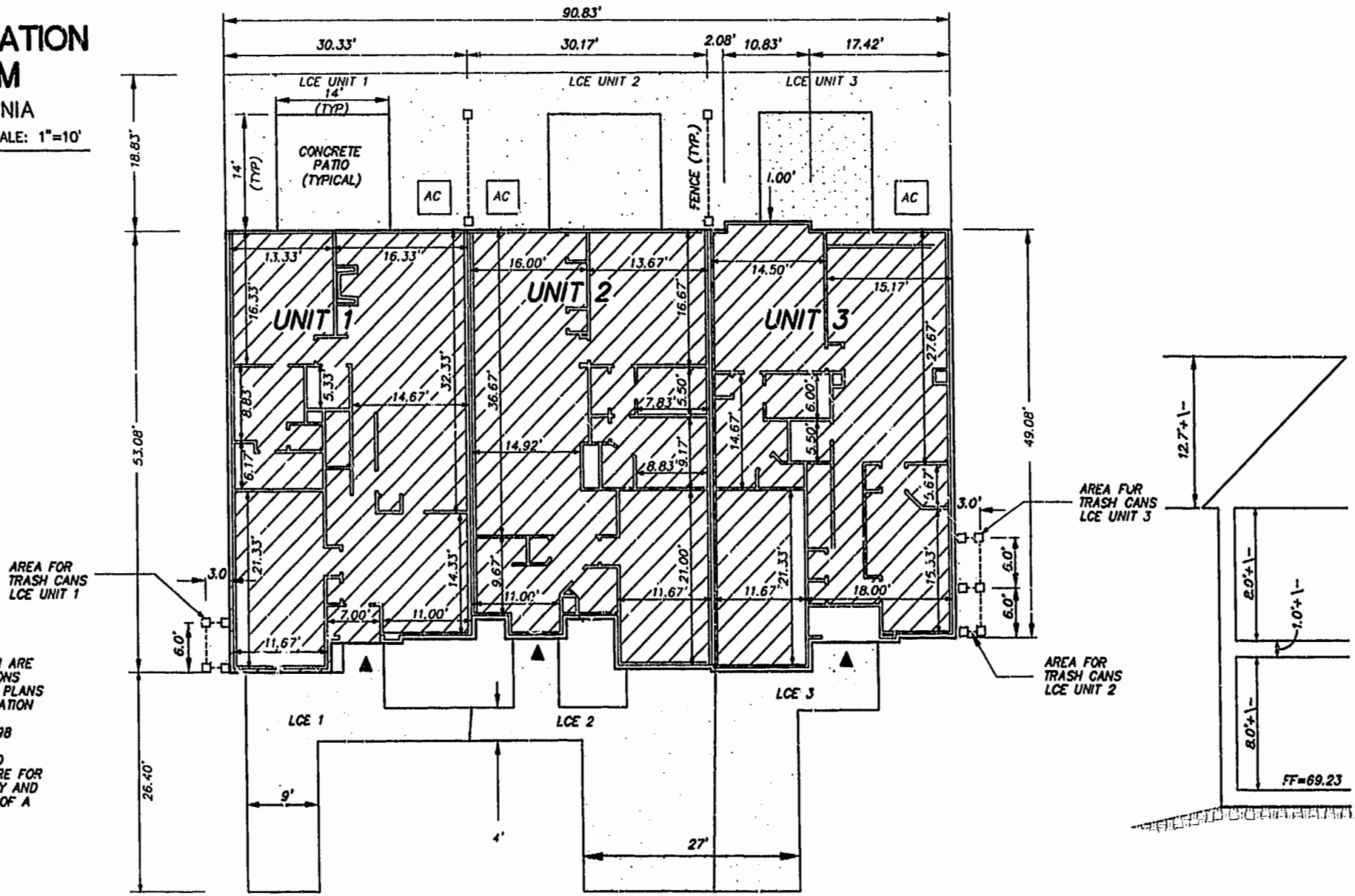

- NOTES:**
- 1) BUILDING DIMENSIONS SHOWN HEREON ARE INTERIOR DIMENSIONS. THESE DIMENSIONS ARE IN FEET AND WERE TAKEN FROM PLANS SUPPLIED ENTITLED "WYNDHAM PLANTATION AT WILLIAMSBURG, FLOOR PLANS" BY PROGRESSIVE DESIGNS DATED 11/19/98
 - 2) INTERIOR UNIT CONFIGURATIONS AND PARTITIONS AS DEPICTED HEREON ARE FOR THE PURPOSE OF ILLUSTRATION ONLY AND MAY NOT REPRESENT THE INTERIOR OF A UNIT AS ACTUALLY CONSTRUCTED.

I HEREBY CERTIFY THAT THIS PLAN IS ACCURATE AND THAT IT COMPLIES WITH SECTION 55-79.58(b) OF THE VIRGINIA CONDOMINIUM ACT AS AMENDED AND THAT ALL UNITS OR PORTION THEREOF DEPICTED HEREON HAVE BEEN SUBSTANTIALLY COMPLETED EXCEPT AS OTHERWISE NOTED.

SIGNED: _____ DATE 9/27/99

*1:31 PM
Recorded 29 day of Oct. 1999
DOCUMENT # 991322
Heather S. Wood Clerk
By Claudia H. Smith, Esq. Attorney*

UNIT AREA

LIMITED COMMON ELEMENT TO THE UNIT INDICATED (LCE)

INDICATES FRONT ENTRANCE TO UNIT

| PHASE | UNIT No. | UNIT ADDRESS | UNIT AREA |
|-------|----------|-------------------|------------|
| 2 | 1 | 465 ZELKOVA DRIVE | 1,853 S.F. |
| 2 | 2 | 469 ZELKOVA DRIVE | 1,957 S.F. |
| 2 | 3 | 473 ZELKOVA DRIVE | 1,799 S.F. |

Rickmond Engineering, Inc.

1643 Merrimac Trail
Williamsburg VA 23185
Voice: (757) 229-1776
Fax No. (757) 229-4683

Engineering
Surveying
Land Planning
www.rickmond.com

197142 PLAT PHASE 1 97142C02 F1 Oct 08 15:29:13 1999