

FIRST FLOOR BUILDING 18

(NOT YET COMPLETE)
SCALE: 1" = 10'

EXHIBIT B CONDOMINIUM PLATS AND PLANS FOR WYNDHAM PLANTATION CONDOMINIUM

WILLIAMSBURG, VIRGINIA

DATE: SEPTEMBER 27, 1999 SCALE: 1"=10'

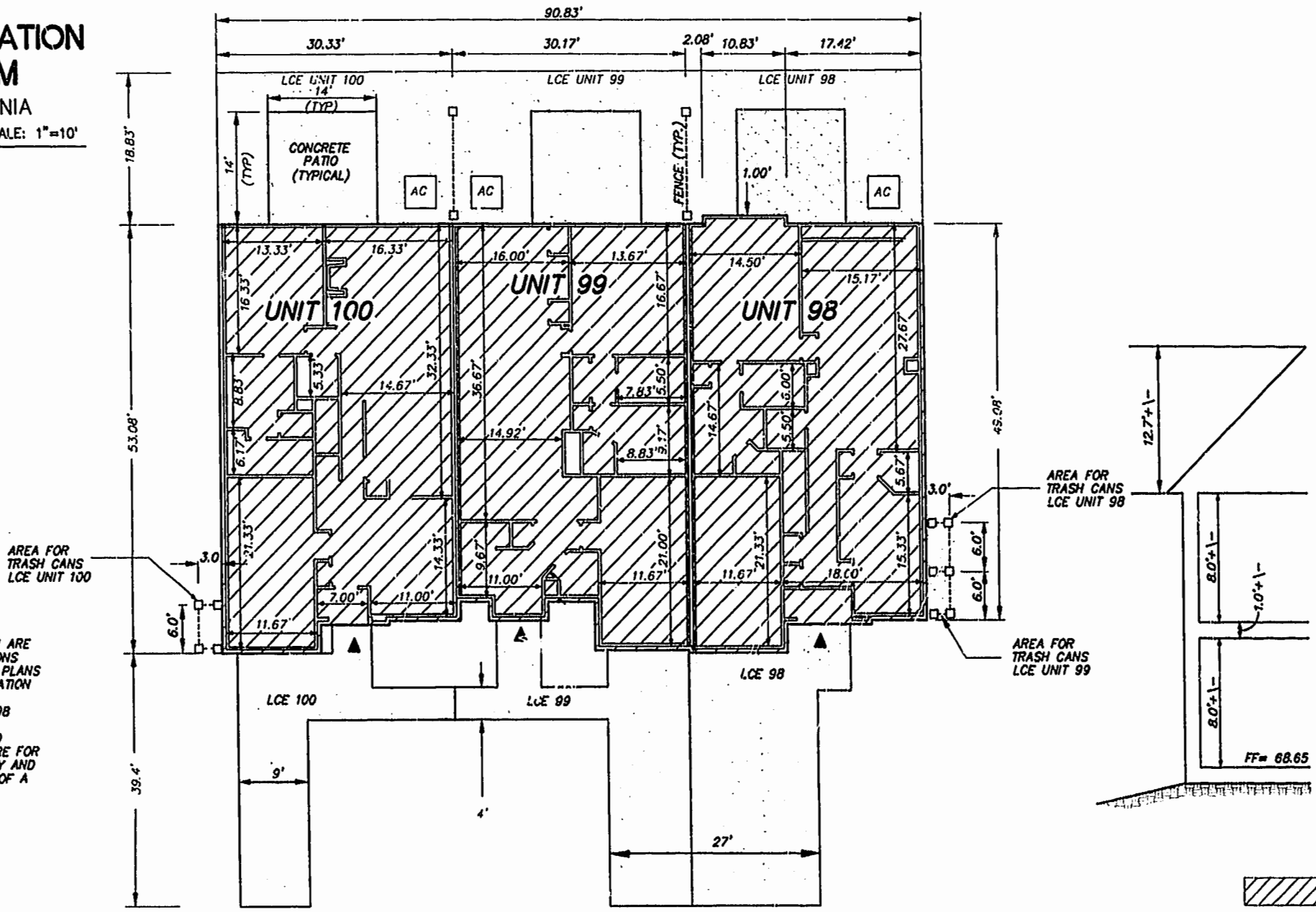

NOTES:

- 1) BUILDING DIMENSIONS SHOWN HEREON ARE INTERIOR DIMENSIONS. THESE DIMENSIONS ARE IN FEET AND WERE TAKEN FROM PLANS SUPPLIED ENTITLED "WYNDHAM PLANTATION AT WILLIAMSBURG, FLOOR PLANS" BY PROGRESSIVE DESIGNS DATED 11/19/98
- 2) INTERIOR UNIT CONFIGURATIONS AND PARTITIONS AS DEPICTED HEREON ARE FOR THE PURPOSE OF ILLUSTRATION ONLY AND MAY NOT REPRESENT THE INTERIOR OF A UNIT AS ACTUALLY CONSTRUCTED.

I HEREBY CERTIFY THAT THIS PLAN IS ACCURATE AND THAT IT COMPLIES WITH SECTION 55-79.58(B) OF THE VIRGINIA CONDOMINIUM ACT AS AMENDED AND THAT ALL UNITS OR PORTION THEREOF DEPICTED HEREON HAVE BEEN SUBSTANTIALLY COMPLETED EXCEPT AS OTHERWISE NOTED.

PHASE	UNIT No.	UNIT ADDRESS	UNIT AREA
1	98	436 ZELKOVA DRIVE	1,799 S.F.
1	99	440 ZELKOVA DRIVE	1,957 S.F.
1	100	444 ZELKOVA DRIVE	1,853 S.F.

SIGNED: _____ DATE: 9/21/99

*1:31 PM
Recorded 29 days of Oct. 1999
DOCUMENT # 991382
The State of Virginia
by Charles H. ...*



Rickmond Engineering, Inc.

1643 Merrimac Trail
Williamsburg VA 23185
Voice: (757) 229-1776
Fax No. (757) 229-4683

Engineering
Surveying
Land Planning
www.rickmond.com

17142 PLAT PHASE 1 971 42012 F1 Oct 08 15:28:36 1999