

PLAT OF SUBDIVISION  
WATERFORD  
AT  
POWHATAN SECONDARY  
PHASE FOURTEEN  
BERKELEY DISTRICT  
JAMES CITY COUNTY, VIRGINIA

DATE: 10/21/98 SHEET 2 OF 3 SCALE: 1"=100'  
PROJECT NO: 97-008 DRAWN BY: CADD

**SA** SLEDD & ASSOCIATES, P.C.  
ENGINEERS PLANNERS SURVEYORS  
11832 ROCK LANDING DRIVE, SUITE 203  
NEWPORT NEWS, VIRGINIA 23606  
(757) 873-3388

00°32'24"  
JAMES CITY COUNTY  
GROUND CONTROL  
MEMORANDUM  
PLAT BOOK: 66, PAGE 70

NOW OR FORMERLY  
POWHATAN ENTERPRISES, INC.

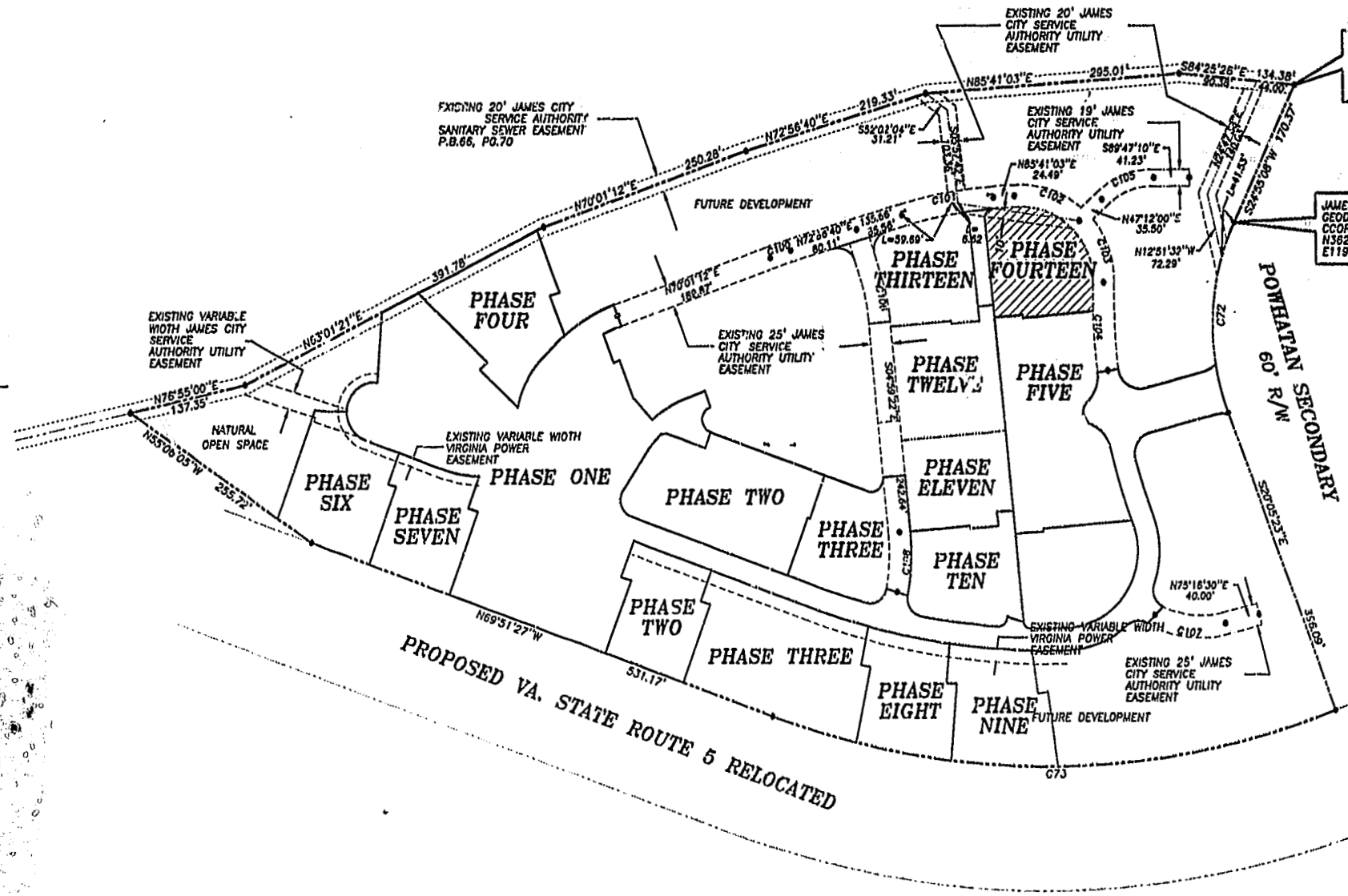

JAMES CITY COUNTY  
GEODETIC GROUND CONTROL  
COORDINATE  
N1325011.25  
E11987128.39

JAMES CITY COUNTY  
GEODETIC GROUND CONTROL  
COORDINATE  
N3825851.21  
E11987000.00

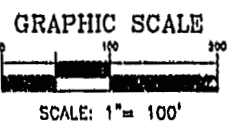
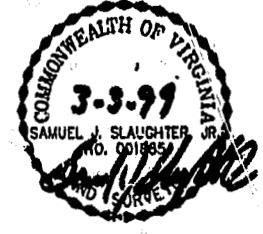

PLAT RECORDED IN  
P.B. NO. 74 PAGE 1-3

Recorded 26 day of JULY 1999  
DOCUMENT # 9700 07825 1045  
James S. Slaughter

CURVE DATA