

SECOND FLOOR

SURVEYOR'S CERTIFICATE

I CERTIFY THAT THIS PLAT IS ACCURATE AND COMPLIES WITH THE PROVISIONS OF SECTION 55-79.58(A) AND (B) OF THE CODE OF VIRGINIA 1950 AS AMENDED AND THAT ALL UNITS DEPICTED HEREON HAVE BEEN SUBSTANTIALLY COMPLETED.

Stephen Romeo 10-7-97
STATE CERTIFIED LAND SURVEYOR DATE

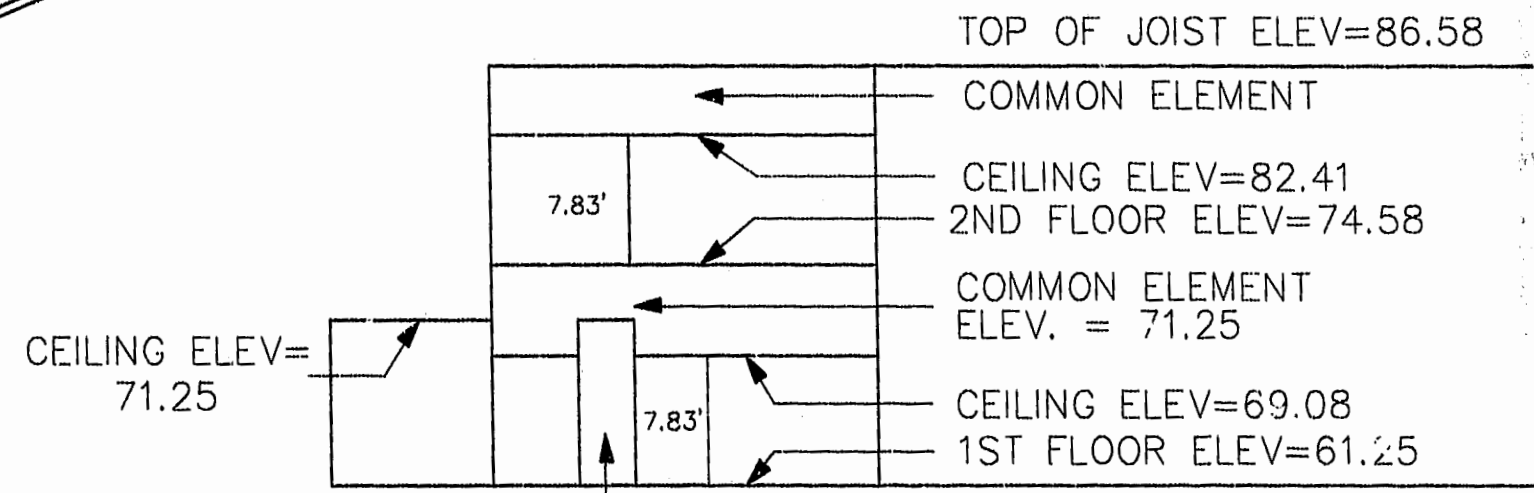

FLOOR ELEVATIONS
N.T.S.
SECTION AA

WMM UNIT

SUITE	SQUARE FOOTAGE
SUITE 100	6266 sq.ft.
SUITE 101	2510 sq.ft.
SUITE 200	5983 sq.ft.
SUITE 201	6891 sq.ft.
WMM LIMITED COMMON ELEMENT	4,176 sq.ft.
COMMON ELEMENT	794 sq.ft.

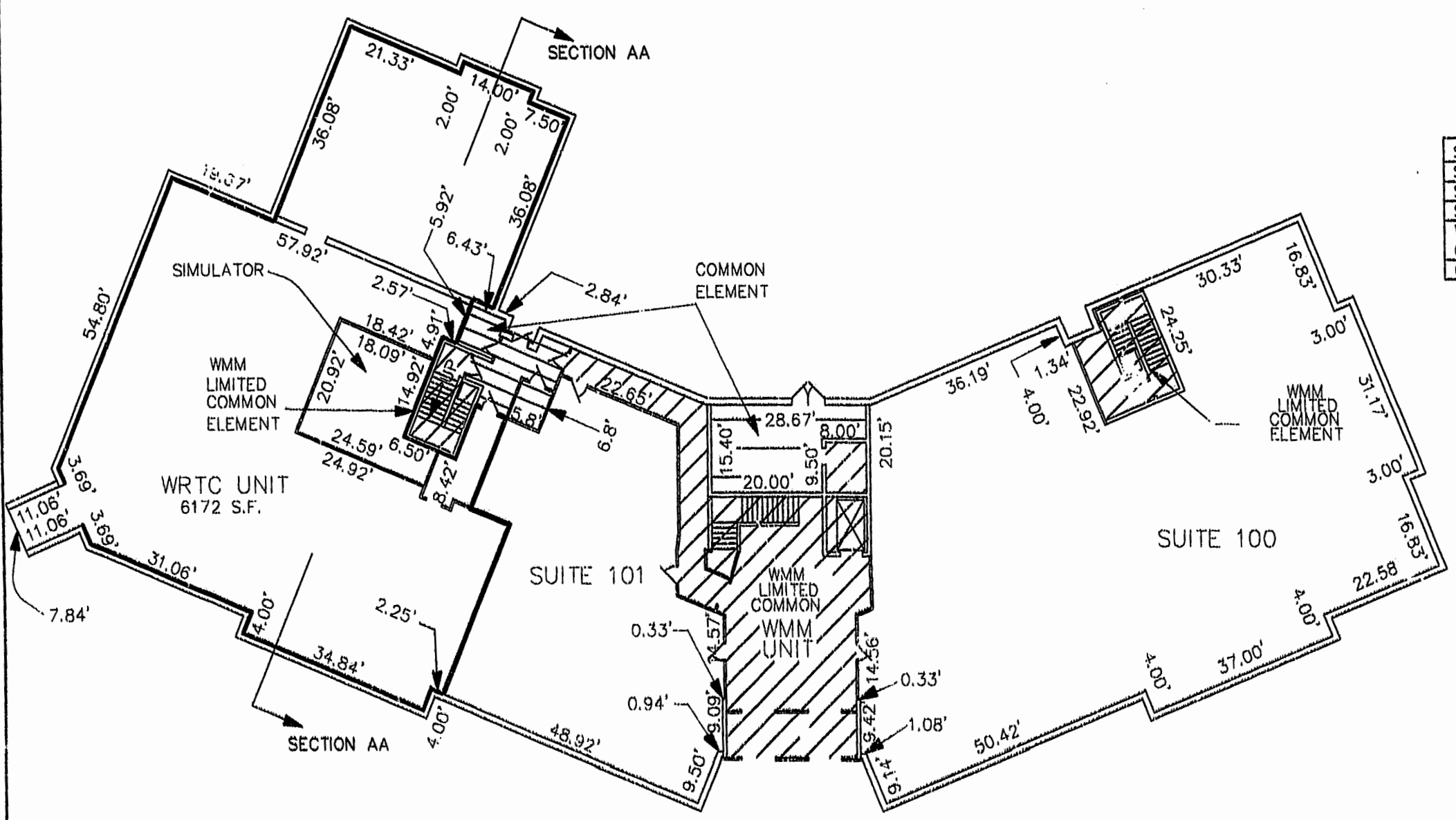
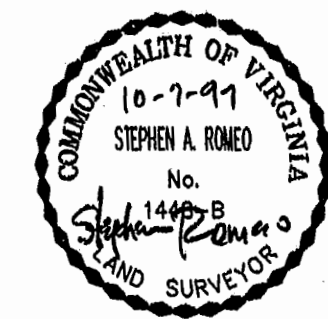

FIRST FLOOR

PLAT OF
WILLIAMSBURG PHYSICIANS' CENTER CONDOMINIUM
JAMES CITY COUNTY, VIRGINIA

SCALE: 1"=20' DATE: 5/7/97

SHEET 2 OF 2



Langley and McDonald, P.C.

Engineers - Surveyors - Planners
Landscape Architects - Environmental Consultants
VIRGINIA BEACH WILLIAMSBURG

GRAPHIC SCALE

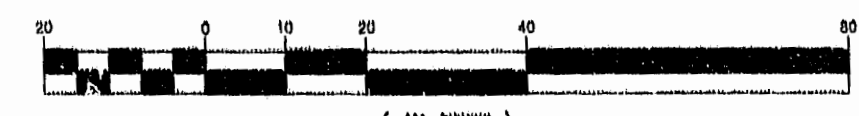

10:09 AM
Recorded 22 day of 21 1999
DOCUMENT: 990003573

Down & M... [Signature]

PLAT RECORDED IN
P.B. NO. 25 PAGE 12 + 13