

PARCEL 8  
(P.B. 52, PG. 78)  
AREA = 1.23 ACRES

PARCEL 9  
(P.B. 52, PG. 78)

EASEMENT FOR  
INGRESS/EGRESS  
(D.B. 53, PG. 46)

JOHN TYLER HIGHWAY  
STATE ROUTE NO. 5

CAROLINA BLVD.  
(60' R/W)

N/F  
LOT 1  
JAMES CITY COUNTY  
(D.B. 216, PG. 268)  
(P.B. 36, PG. 63)



Recorded 23rd April 1998  
DOCUMENT # 980007388  
Ralf Simon

PLAT RECORDED IN  
BB 69 PAGE 2629

N/F  
JAMES CITY COUNTY  
(D.B. 180, PG. 465)

Hassell & Folkes, P.C. Engineers Surveyors Planners Chesapeake, VA. 23320 (757)547-9531	SIZE C	CONTRACT NO	DISK/BOX 49B/15	FILENAME LF-P12.DWH	REV.
SCALE: 1" = 50'		DATE: 04/06/98		SHEET 2 of 4	

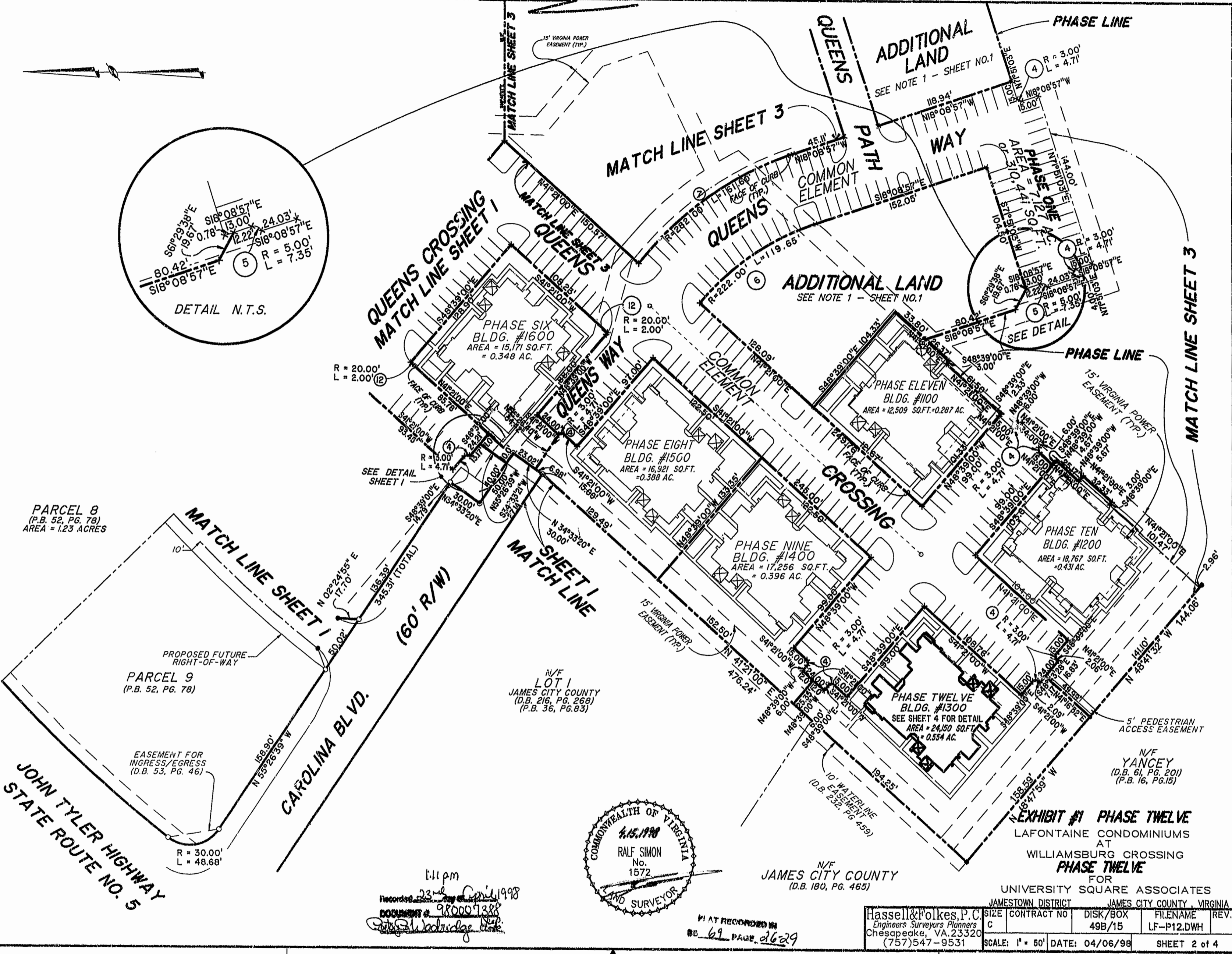
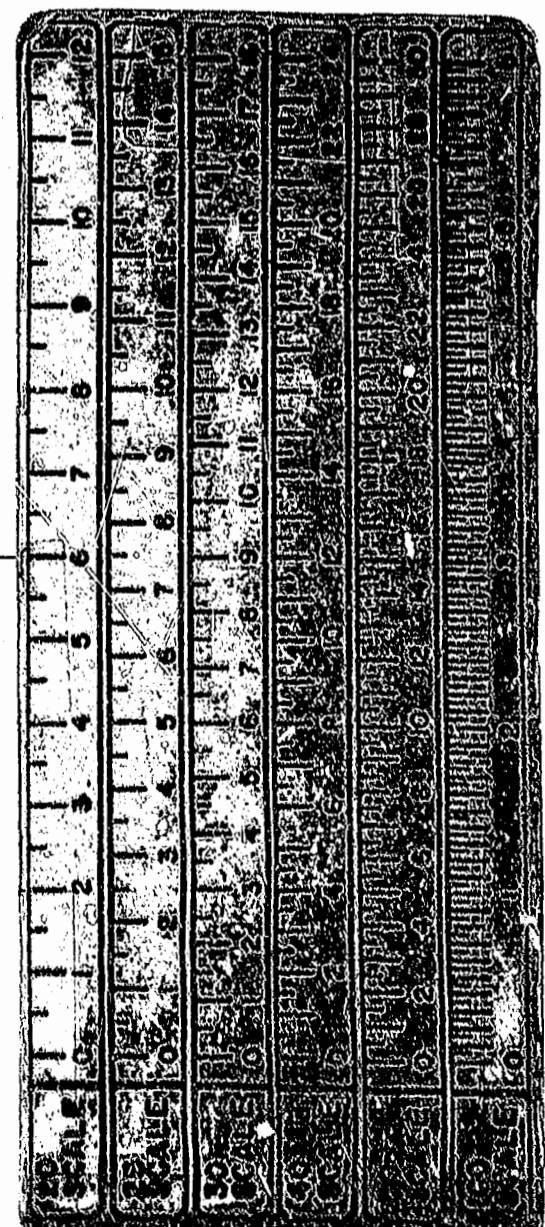

**EXHIBIT #1 PHASE TWELVE**  
LAFONTAINE CONDOMINIUMS  
AT  
WILLIAMSBURG CROSSING  
**PHASE TWELVE**  
FOR  
UNIVERSITY SQUARE ASSOCIATES  
JAMESTOWN DISTRICT JAMES CITY COUNTY, VIRGINIA