

NOTE:  
**BOLD DIMENSIONS BASED ON ACTUAL FIELD MEASUREMENTS.**  
 OTHER DATA TAKEN FROM PLANS PER NICHOLS CARTER GRANT ARCHITECTS.

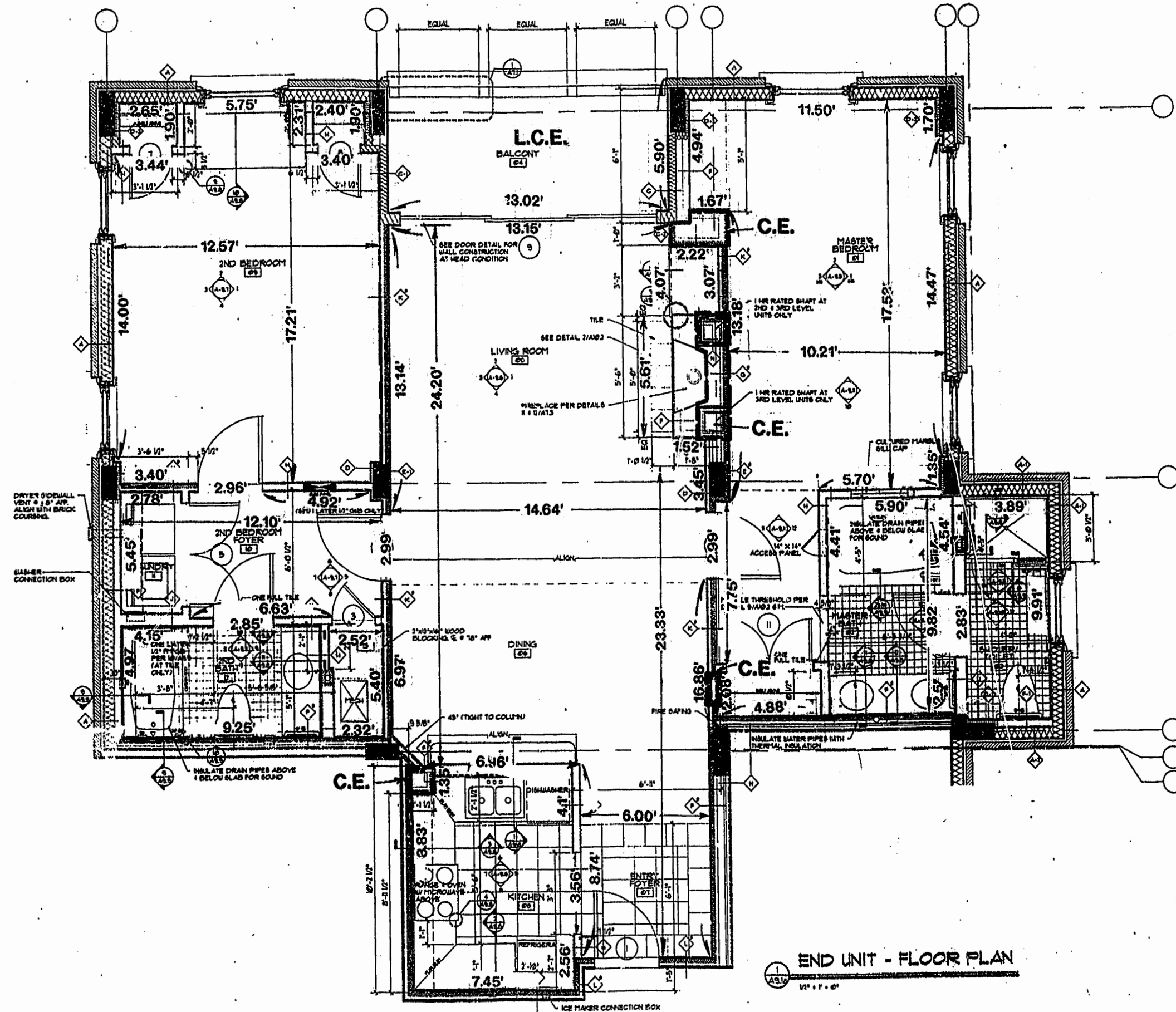

END UNIT FLOOR PLAN

UNIT NO.	ORIENTATION
1811	FLIPPED
1816	SAME
1821	FLIPPED
1826	SAME
1831	FLIPPED
1836	SAME

**BOLD DIMENSIONS SHOWN ARE TYPICAL AND BASED ON ACTUAL FIELD MEASUREMENTS OF UNIT #1815.**

Recorded 21 day of April 1998  
 DOCUMENT # 980007172 317  
*Patricia A. Woodbridge, Clerk*

PLAT RECORDED IN  
 P.B. NO. 67 PAGE 6 of 24



**SURVEYOR'S CERTIFICATE**

I, HEREBY CERTIFY THAT TO THE BEST OF MY KNOWLEDGE AND BELIEF, THIS IS A CORRECT AND ACCURATE PLAN AND THAT THIS PLAN IS IN COMPLIANCE WITH THE VIRGINIA CODE ANNOTATED SUBSECTIONS 55-79.58B AND E. I FURTHER CERTIFY THAT ALL UNITS OR PORTIONS THEREOF DEPICTED HEREON HAVE BEEN SUBSTANTIALLY COMPLETED.

*G. T. Wilson, Jr.*  
 G. T. WILSON, JR., C.L.S. DATE 8-1-97

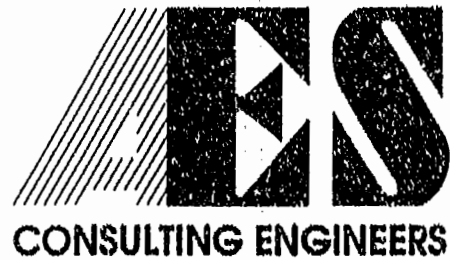
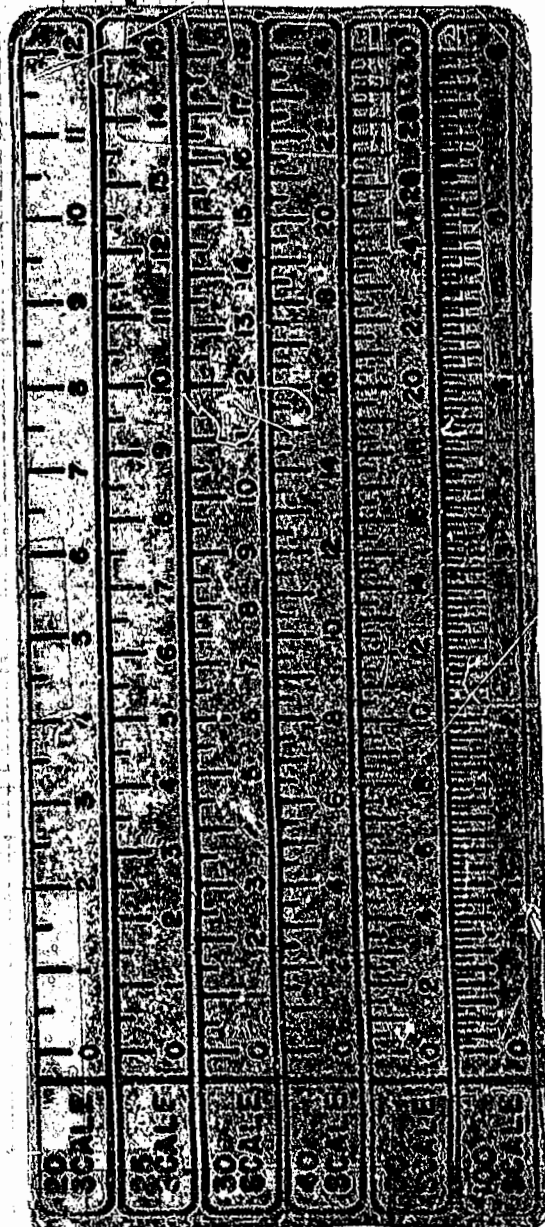

5248 Olde Towne Road, Suite 1  
 Williamsburg, Virginia 23188  
 (804) 253-0040  
 Fax (804) 220-8994

EXHIBIT A-3  
**PLAT OF CONDOMINIUM  
 MANOR CLUB  
 AT FORD'S COLONY  
 PHASE VII**  
 OWNER/DEVELOPER: MARRIOTT OWNERSHIP RESORTS, INC.  
 POWHATAN DISTRICT JAMES CITY COUNTY VIRGINIA

No.	DATE	REVISION / COMMENT / NOTE	BY

Designed ADS	Drawn RMJ
Scale NONE	Date 8/1/97
Project No. <b>7739-CE</b>	
Drawing No. <b>9 of 9</b>	