

NOTES:

1. THE LOWER (HORIZONTAL) BOUNDARY OF EACH UNIT IN BUILDING "G" SHOWN ON THE PLAT AS LOCATED ON PHASE VII IS THE HORIZONTAL PLANE OF THE UPPER SURFACE OF THE FLOOR SLAB OF THE UNIT.
2. THE UPPER (HORIZONTAL) BOUNDARY OF EACH OF THE UNITS IN BUILDING "G" SHOWN ON THE PLAT AS LOCATED ON PHASE VII IS THE HORIZONTAL PLANE (S) OF THE LOWER SURFACE OF THE FLOOR SLAB CONSTITUTING THE CEILING OF THE UNIT; IT BEING UNDERSTOOD THAT THE TEXTURED CEILING COATING IS PART OF THE UNIT.

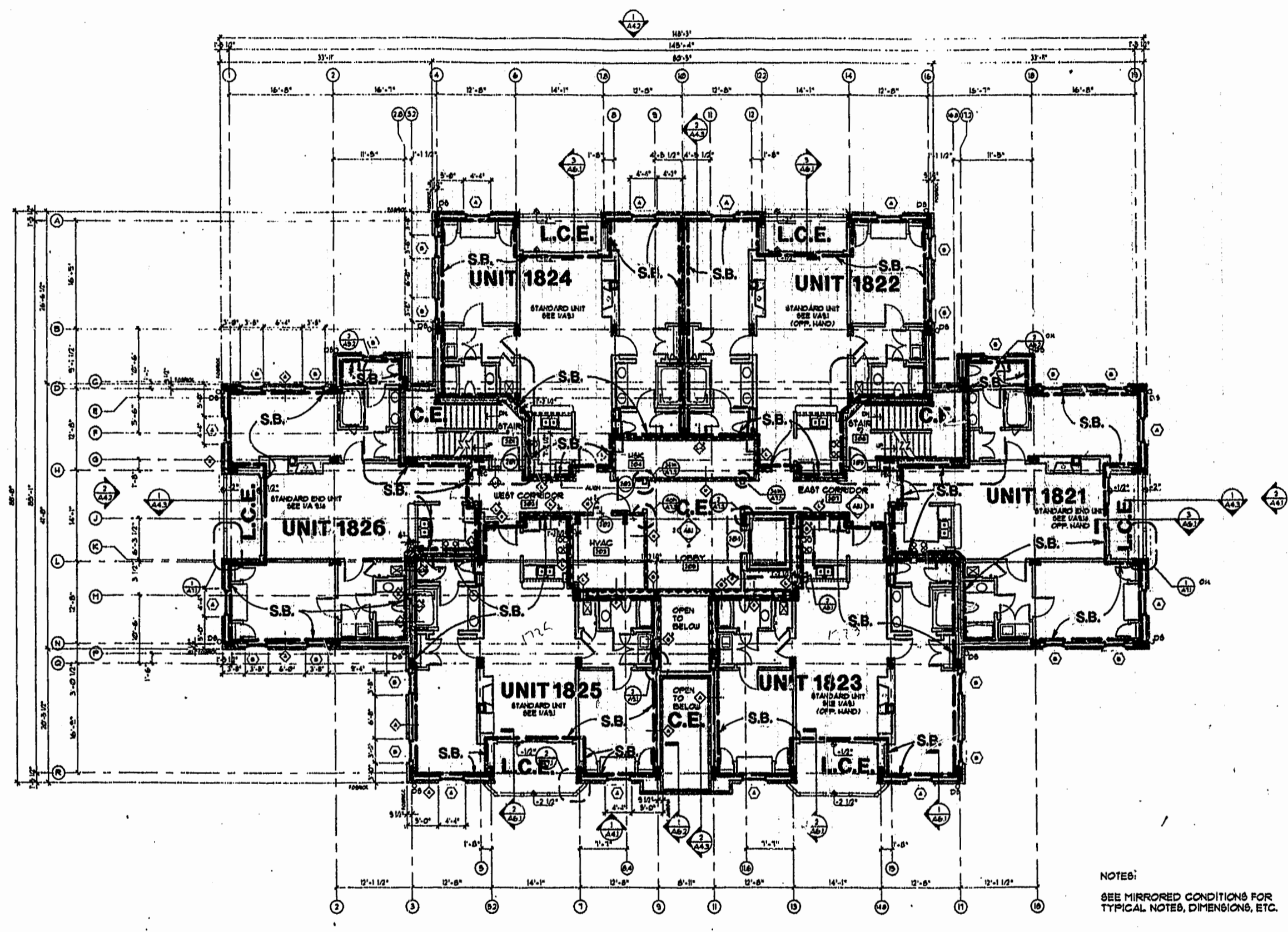

SECOND LEVEL FLOOR PLAN
UNITS 1821 THRU 1826

LEGEND:
 S.B. - SIDE (PERIMETRIC) BOUNDARY
 C.E. - COMMON ELEMENT
 L.C.E. - LIMITED COMMON ELEMENT

NOTE:
 BOLD DIMENSIONS BASED ON ACTUAL FIELD MEASUREMENTS.
 OTHER DATA TAKEN FROM PLANS PER NICHOLS CARTER GRANT ARCHITECTS.

NOTES:
 SEE MIRRORED CONDITIONS FOR TYPICAL NOTES, DIMENSIONS, ETC.

Recorded 21 day of April 1998
 DOCUMENT # 98001112 3:17 PM
 John P. Woodbridge, Clerk

PLAT RECORDED IN
 P.B. NO. 69 PAGE 24



SURVEYOR'S CERTIFICATE

I, HEREBY CERTIFY THAT TO THE BEST OF MY KNOWLEDGE AND BELIEF, THIS IS A CORRECT AND ACCURATE PLAN AND THAT THIS PLAN IS IN COMPLIANCE WITH THE VIRGINIA CODE ANNOTATED SUBSECTIONS 55-79.58B AND E. I FURTHER CERTIFY THAT ALL UNITS OR PORTIONS THEREOF DEPICTED HEREON HAVE BEEN SUBSTANTIALLY COMPLETED.

G. T. Wilson, Jr., C.L.S. DATE 8-1-97

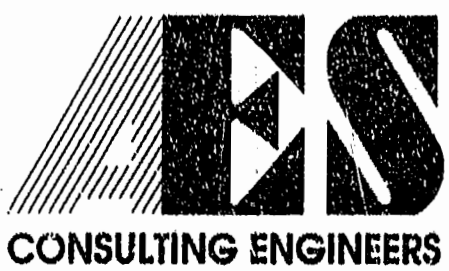

5248 Old Towne Road, Suite 1
 Williamsburg, Virginia 23188
 (804) 253-0040
 Fax (804) 220-8994

EXHIBIT A-3
PLAT OF CONDOMINIUM
MANOR CLUB
AT FORD'S COLONY
PHASE VII
 OWNER/DEVELOPER: MARRIOTT OWNERSHIP RESORTS, INC.
 POWHATAN DISTRICT JAMES CITY COUNTY VIRGINIA

No.	DATE	REVISION / COMMENT / NOTE	BY

Designed ADS	Drawn RMJ
Scale NONE	Date 8/1/97
Project No. 7739-CE	
Drawing No.	
3 of 9	