

NOTES:

1. THE LOWER (HORIZONTAL) BOUNDARY OF EACH UNIT IN BUILDING "G" SHOWN ON THE PLAT AS LOCATED ON PHASE VII IS THE HORIZONTAL PLANE OF THE UPPER SURFACE OF THE FLOOR SLAB OF THE UNIT.
2. THE UPPER (HORIZONTAL) BOUNDARY OF EACH OF THE UNITS IN BUILDING "G" SHOWN ON THE PLAT AS LOCATED ON PHASE VII IS THE HORIZONTAL PLANE (S) OF THE LOWER SURFACE OF THE FLOOR SLAB CONSTITUTING THE CEILING OF THE UNIT; IT BEING UNDERSTOOD THAT THE TEXTURED CEILING COATING IS PART OF THE UNIT.

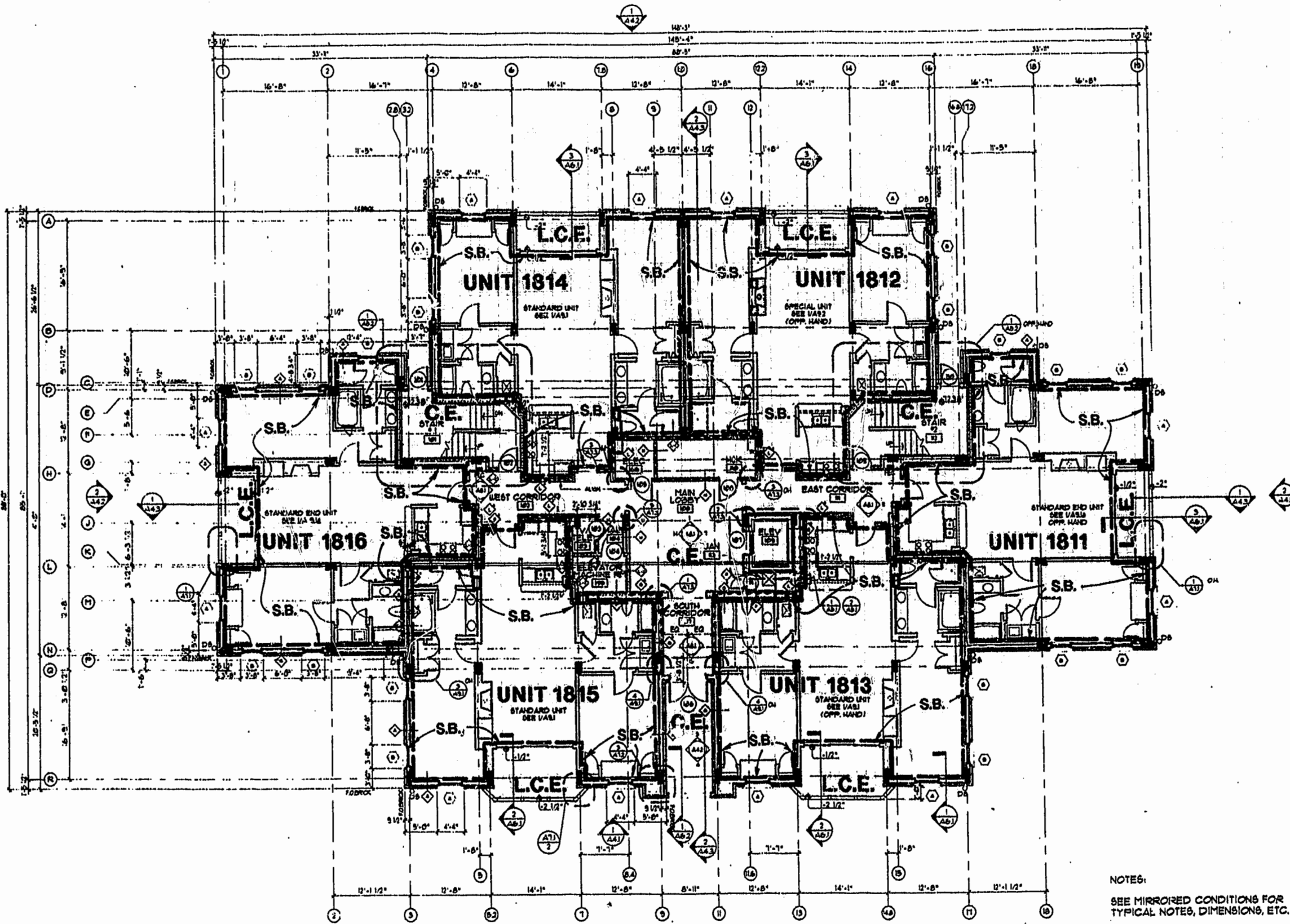

**FIRST LEVEL FLOOR PLAN**  
UNITS 1811 THRU 1816

**LEGEND:**  
 S.B. - SIDE (PERIMETRIC) BOUNDARY  
 C.E. - COMMON ELEMENT  
 L.C.E. - LIMITED COMMON ELEMENT

**NOTE:**  
 BOLD DIMENSIONS BASED ON ACTUAL FIELD MEASUREMENTS.  
 OTHER DATA TAKEN FROM PLANS PER NICHOLS CARTER GRANT ARCHITECTS.

NOTES:  
 SEE MIRRORED CONDITIONS FOR TYPICAL NOTES, DIMENSIONS, ETC.

Recorded 21 day of April 1995  
 DOCUMENT # 9900 7102 3:17 PM  
 [Signature]

PLAT RECORDED IN  
 P.B. NO. 69 PAGE 17 of 24



**SURVEYOR'S CERTIFICATE**

I, HEREBY CERTIFY THAT TO THE BEST OF MY KNOWLEDGE AND BELIEF, THIS IS A CORRECT AND ACCURATE PLAN AND THAT THIS PLAN IS IN COMPLIANCE WITH THE VIRGINIA CODE ANNOTATED SUBSECTIONS 55-79.58B AND E. I FURTHER CERTIFY THAT ALL UNITS OR PORTIONS THEREOF DEPICTED HEREON HAVE BEEN SUBSTANTIALLY COMPLETED.

[Signature]  
 G. T. WILSON, JR., C.L.S.      8-1-97  
 DATE

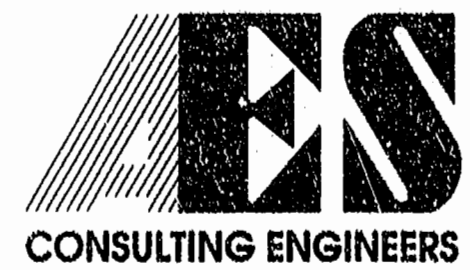
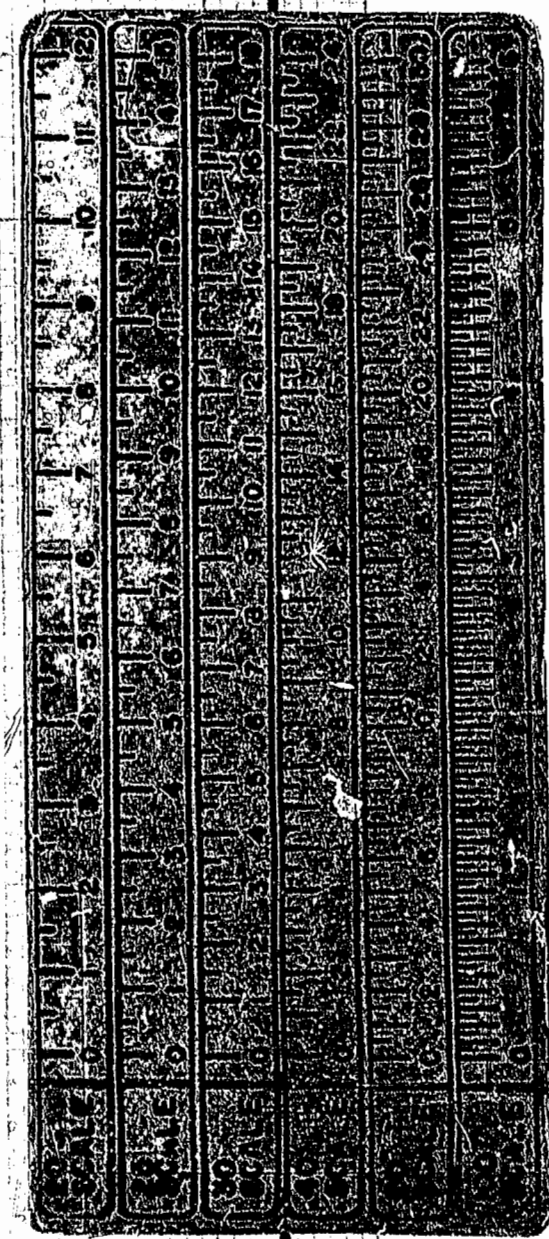

5248 Olde Towne Road, Suite 1  
 Williamsburg, Virginia 23188  
 (804) 253-0040  
 Fax (804) 220-8994

**EXHIBIT A-3**  
**PLAT OF CONDOMINIUM**  
**MANOR CLUB**  
**AT FORD'S COLONY**  
 PHASE VII  
 OWNER/DEVELOPER: MARRIOTT OWNERSHIP RESORTS, INC.  
 POWHATAN DISTRICT, JAMES CITY COUNTY, VIRGINIA

No.	DATE	REVISION / COMMENT / NOTE	BY

Designed ADS	Drawn RMJ
Scale NOTED	Date 8/1/97
Project No. 7739-CE	
Drawing No. 2 of 9	