

BUILDING NUMBER	UNIT NUMBER	UNIT TYPE	STREET ADDRESS
20	20-214	D-1	214 SHOAL CREEK
20	20-216	C	216 SHOAL CREEK
20	20-218	B	218 BUNKER ARCH
20	20-220	A	220 BUNKER ARCH

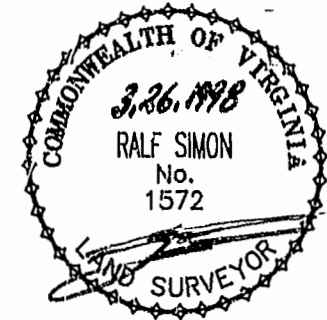

EXIST. 20' DRAINAGE EASMT.  
M.B. 65 - PG. 2

LEGACY VARIABLER DRIVE WIDJH

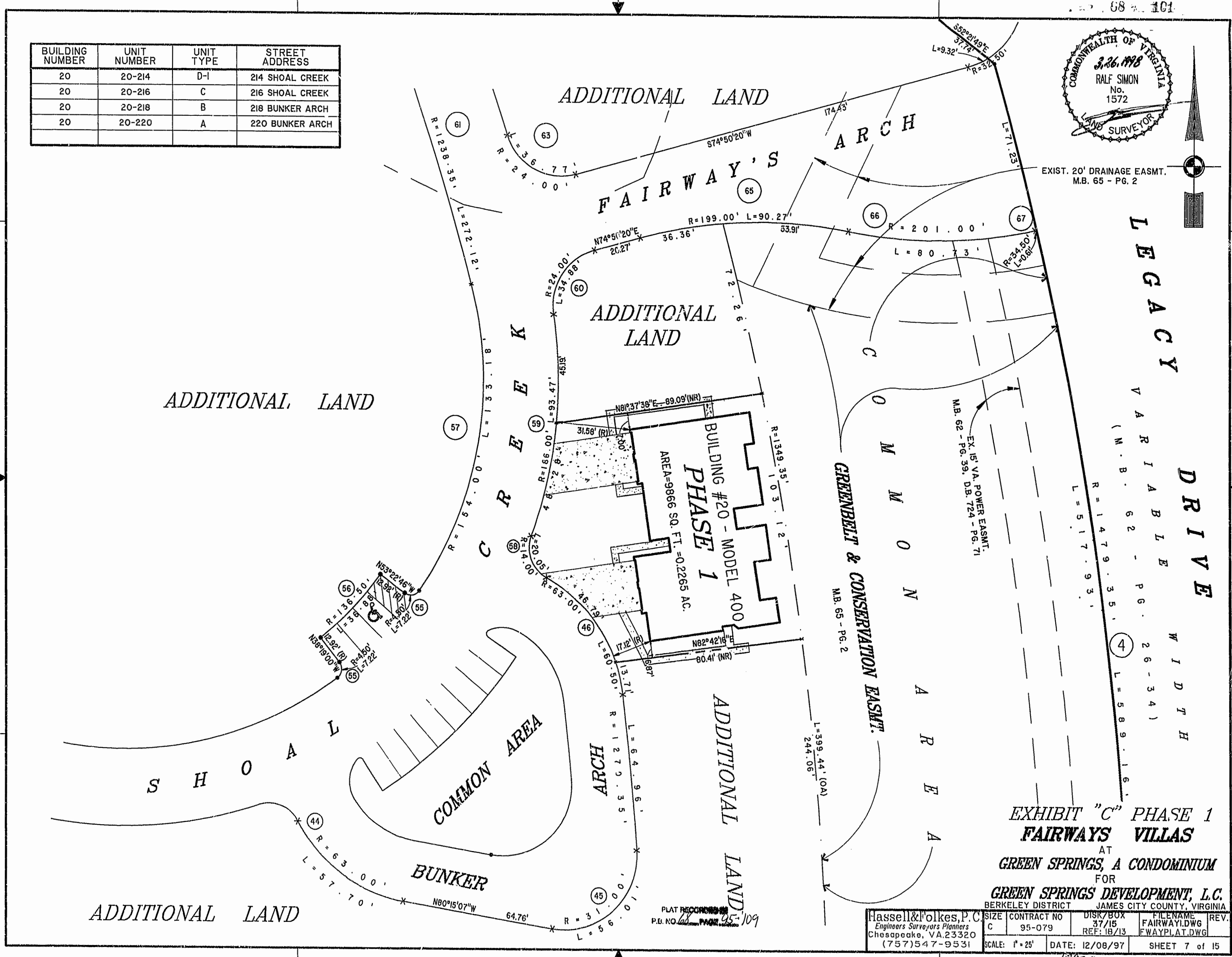

**EXHIBIT "C" PHASE 1  
FAIRWAYS VILLAS**  
AT  
**GREEN SPRINGS, A CONDOMINIUM**  
FOR  
**GREEN SPRINGS DEVELOPMENT, L.C.**  
BERKELEY DISTRICT JAMES CITY COUNTY, VIRGINIA

Hassell & Folkes, P.C. Engineers Surveyors Planners Chesapeake, VA 23320 (757) 547-9531	CONTRACT NO. 95-079	DISK/BOX 37/15 REF: 18/13	FILENAME FAIRWAY1.DWG FWAYPLAT.DWG	REV.
SCALE: 1"=25'	DATE: 12/08/97	SHEET 7 of 15		

Recorded 1st day of April 1998  
DOCUMENT # 980005806  
Hassell & Folkes, P.C.

