

**NOTE:**  
**BOLD DIMENSIONS** BASED ON ACTUAL FIELD MEASUREMENTS.  
 OTHER DATA TAKEN FROM PLANS PER NICHOLS CARTER GRANT ARCHITECTS.

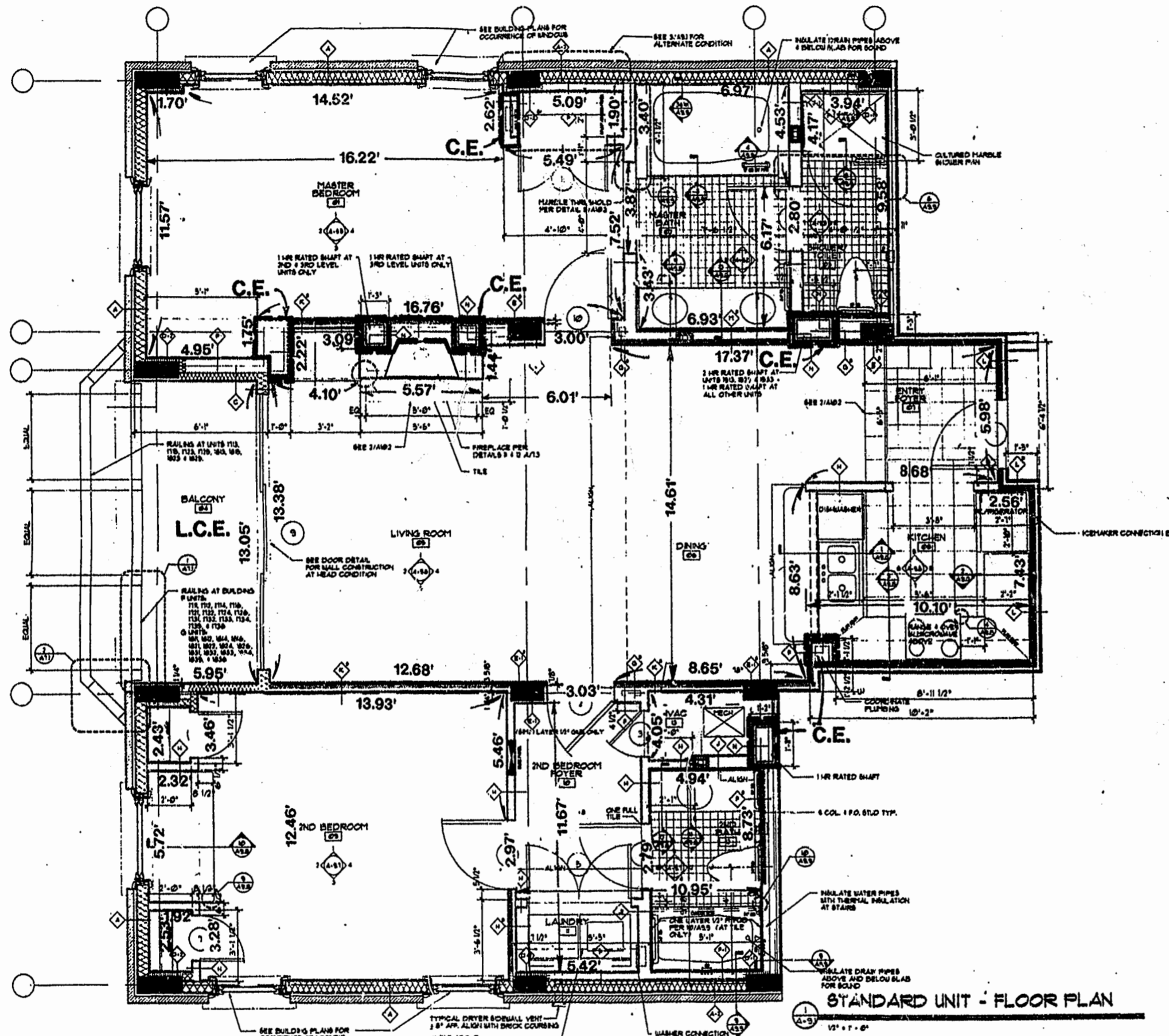

STANDARD UNIT FLOOR PLAN

UNIT NO.	ORIENTATION
1713	FLIPPED
1714	SAME
1715	SAME
1722	FLIPPED
1723	FLIPPED
1724	SAME
1725	SAME
1732	FLIPPED
1733	FLIPPED
1734	SAME
1735	SAME

**BOLD DIMENSIONS SHOWN ARE TYPICAL AND BASED ON ACTUAL FIELD MEASUREMENTS OF UNITS.**

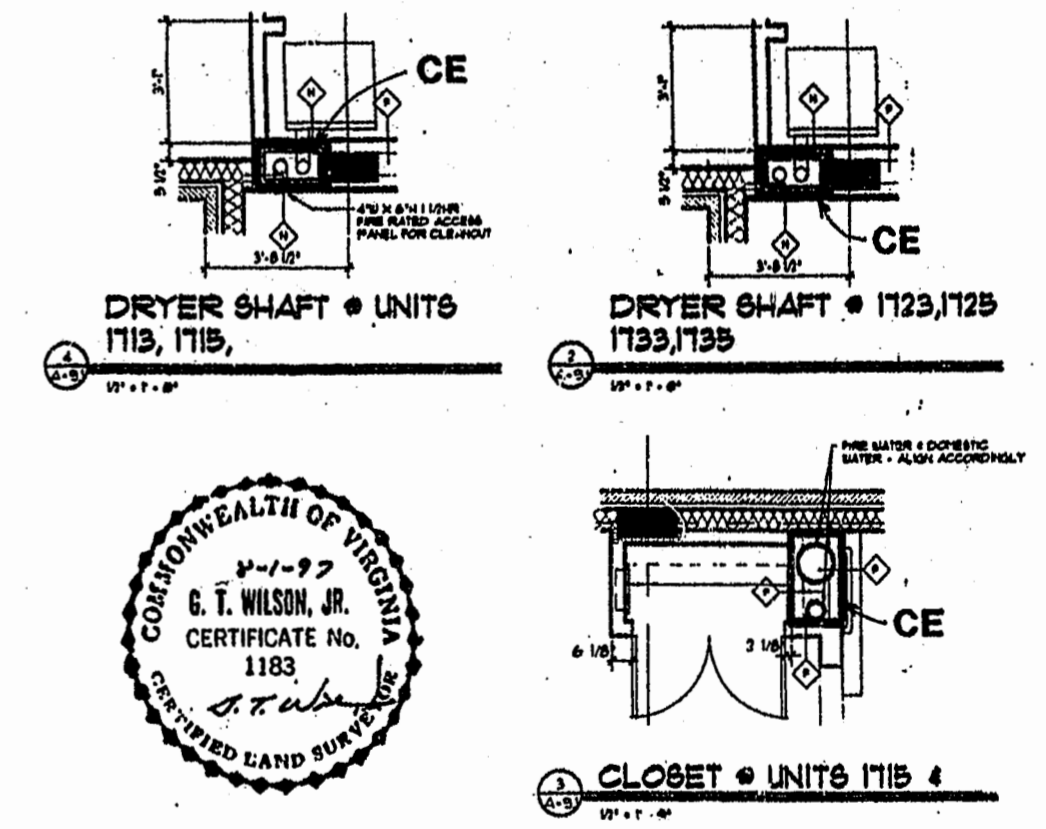

**SURVEYOR'S CERTIFICATE**

I, HEREBY CERTIFY THAT TO THE BEST OF MY KNOWLEDGE AND BELIEF, THIS IS A CORRECT AND ACCURATE PLAN AND THAT THIS PLAN IS IN COMPLIANCE WITH THE VIRGINIA CODE ANNOTATED SUBSECTIONS 55-79.58B AND E. I FURTHER CERTIFY THAT ALL UNITS OR PORTIONS THEREOF DEPICTED HEREON HAVE BEEN SUBSTANTIALLY COMPLETED.

1:51 PM  
 Recorded 12 day of Dec 1999  
 DOCUMENT # 99-19646  
*Richard S. Wood* Clerk  
*Charles H. Burkhardt* Esq. Clerk  
 G. T. WILSON, JR., C.L.S.

8-1-99  
 DATE

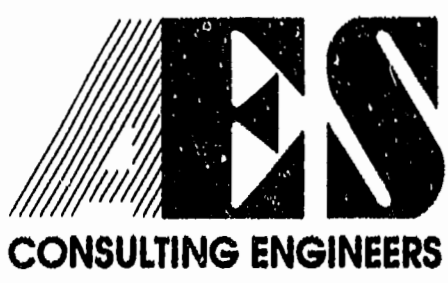

5248 Olde Towne Road, Suite 1  
 Williamsburg, Virginia 23188  
 (804) 253-0040  
 Fax (804) 220-8994

**EXHIBIT A-3**  
**PLAT OF CONDOMINIUM**  
**MANOR CLUB**  
**AT FORD'S COLONY**  
 PHASE VI  
 OWNER/DEVELOPER: MARRIOTT OWNERSHIP RESORTS, INC.  
 POWHATAN DISTRICT JAMES CITY COUNTY VIRGINIA

No.	DATE	REVISION / COMMENT / NOTE	BY

Designed ADS	Drawn RMJ
Scale NONE	Date 8/1/97
Project No. 7739-CE	
Drawing No. 8 of 10	