

PARCEL 8  
(P.B. 52, PG. 78)  
AREA = 1.23 ACRES

PARCEL 9  
(P.B. 52, PG. 78)

JOHN TYLER HIGHWAY  
STATE ROUTE NO. 5

EASEMENT FOR  
INGRESS/EGRESS  
(D.B. 53, PG. 46)

CAROLINA BLVD.  
(60' R/W)

N/F  
LOT 1  
JAMES CITY COUNTY  
(D.B. 216, PG. 268)  
(P.B. 36, PG. 83)



N/F  
JAMES CITY COUNTY  
(D.B. 130, PG. 465)

|  |        |                   |                |                    |      |
|--|--------|-------------------|----------------|--------------------|------|
| Hassell & Folkes, P.C.<br>Engineers Surveyors Planners<br>Chesapeake, VA. 23320<br>(757)547-9531 | SIZE C | CONTRACT NO 18/15 | DISK/BOX 18/15 | FILENAME LF-P8.DWG | REV. |
| SCALE: 1" = 50'  |        | DATE: 10/16/97    |                | SHEET 2 of 4       |      |

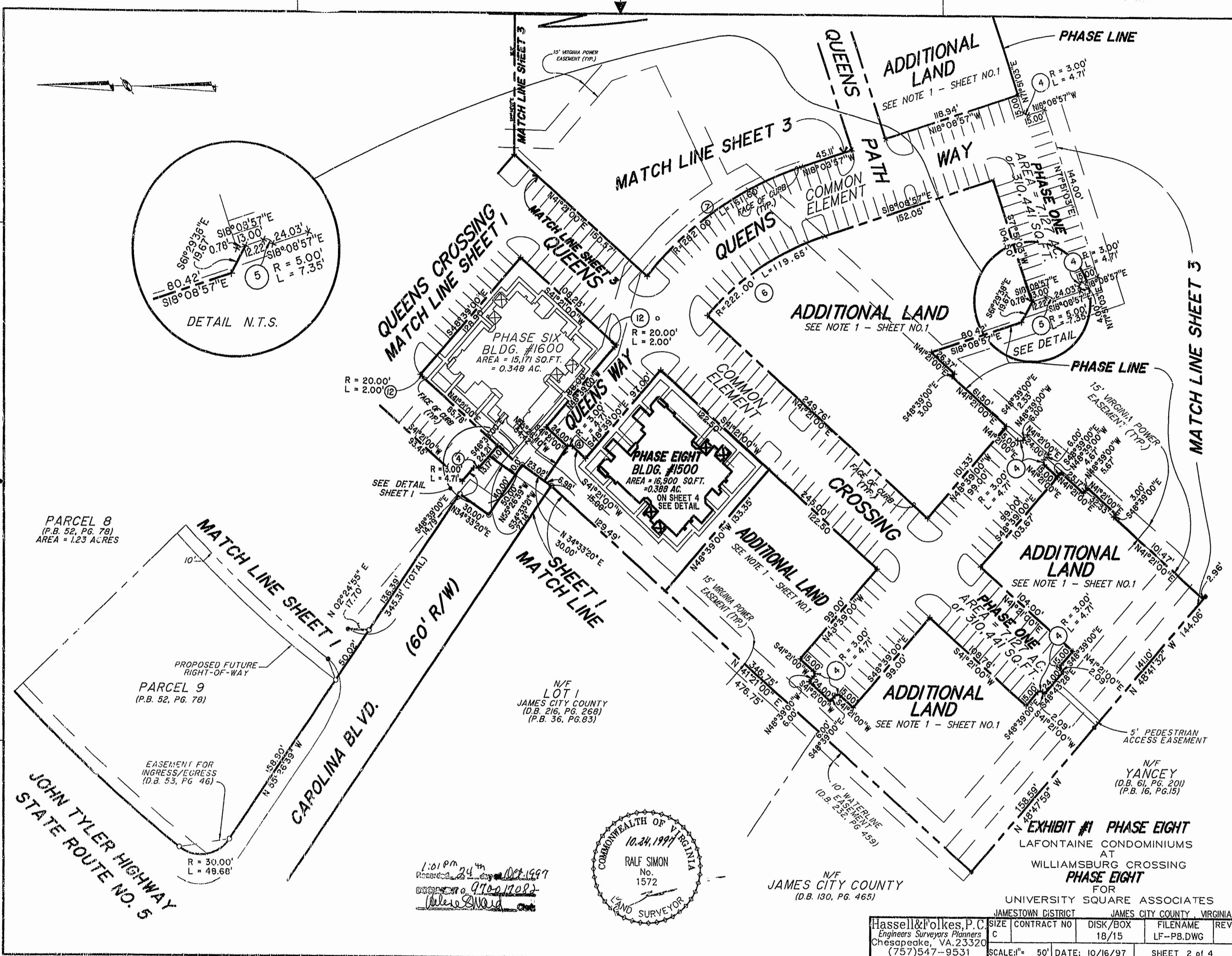
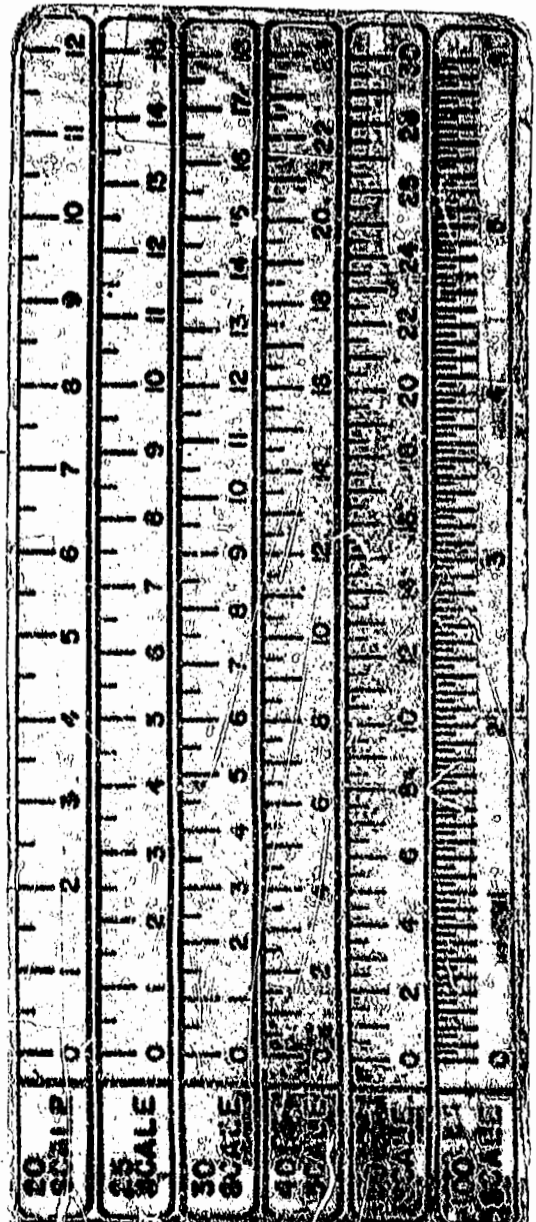

**EXHIBIT #1 PHASE EIGHT**  
LAFONTAINE CONDOMINIUMS  
AT  
WILLIAMSBURG CROSSING  
**PHASE EIGHT**  
FOR  
UNIVERSITY SQUARE ASSOCIATES  
JAMESTOWN DISTRICT JAMES CITY COUNTY, VIRGINIA

1:01 PM  
Revised 24th day Oct 1997  
Checked by 970017087  
Ralf Simon