

# KINGS WAY (60' R/W)

(P.B. 51, PG. 27)

EASEMENT RESERVED FOR  
RIGHT-OF-WAY IMPROVEMENTS  
(P.B. 53, PG. 46)

BLDG. NUMBER	UNIT NUMBER	UNIT TYPE	ADDRESS	PARKING SPACE NO.
500	5-501	AR	501 QUEENS CROSSING	89
500	5-502	B	502 QUEENS CROSSING	87
500	5-503	A	503 QUEENS CROSSING	85
500	5-504	E	504 QUEENS CRESCENT	83
500	5-505	C	505 QUEENS CRESCENT	81
500	5-506	D	506 QUEENS CRESCENT	79
500	5-507	F	507 QUEENS CRESCENT	77
500	5-508	DR	508 QUEENS CRESCENT	75
500	5-509	CR	509 QUEENS CROSSING	73
500	5-510	ER	510 QUEENS CROSSING	71

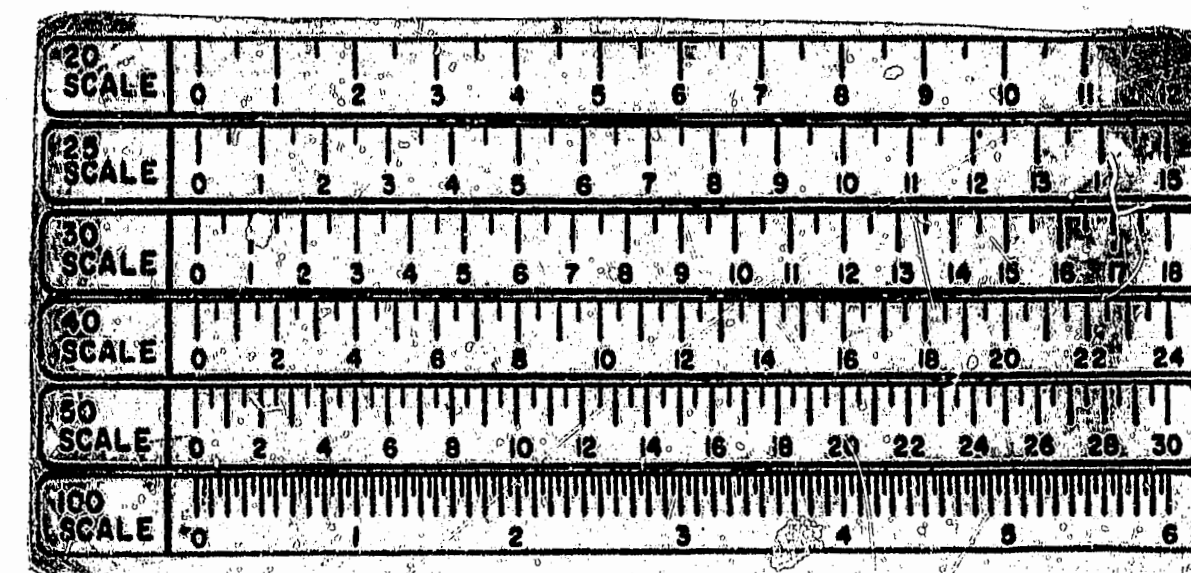
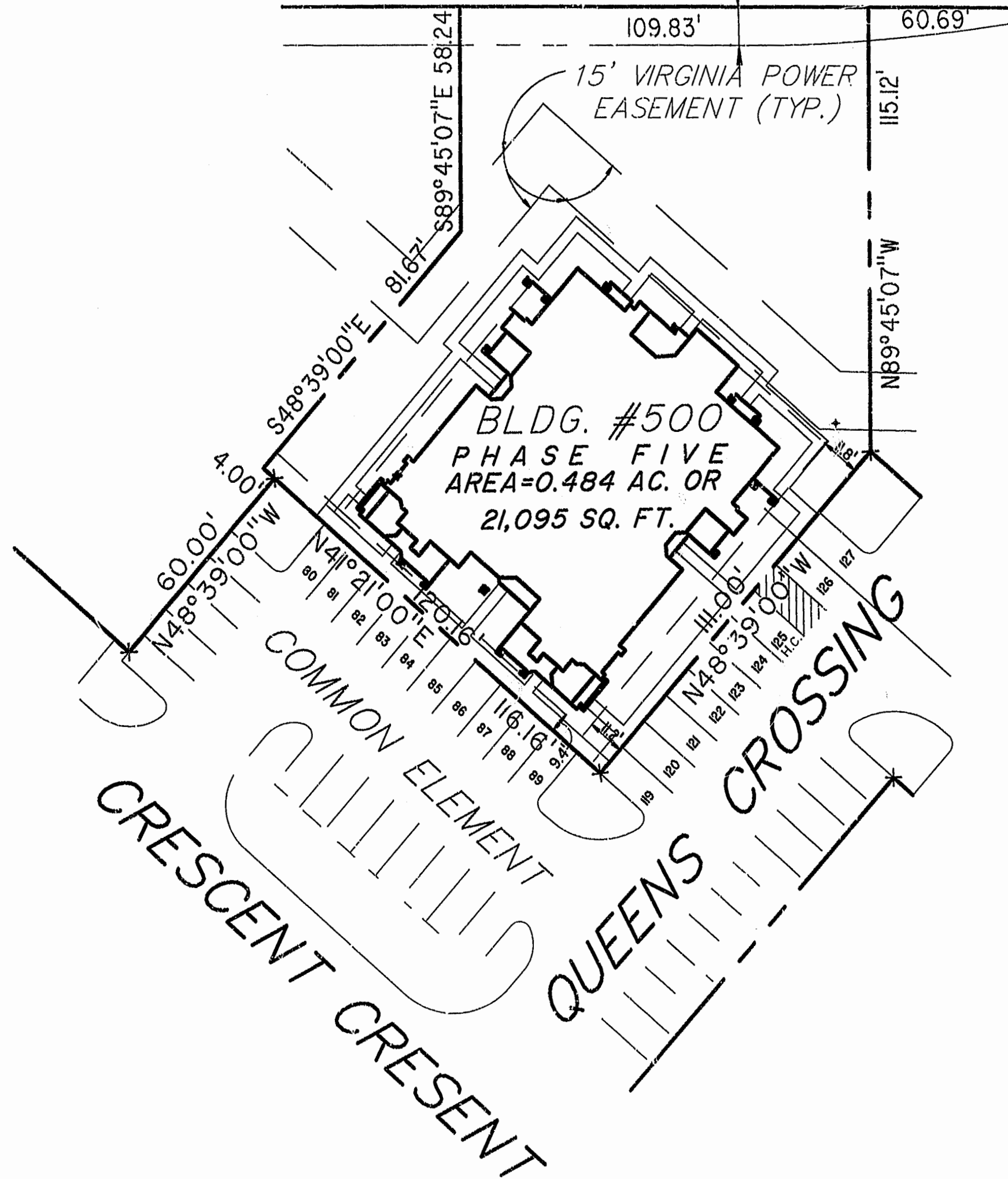

**EXHIBIT # 1 PHASE FIVE**  
LAFONTAINE CONDOMINIUMS  
AT  
WILLIAMSBURG CROSSING  
**PHASE FIVE**

FOR  
WILLIAMSBURG SQUARE ASSOCIATES  
JAMESTOWN DISTRICT JAMES CITY COUNTY, VIRGINIA

Hassell & Folkes, P.C. Engineers Surveyors Planners Chesapeake, VA. 23320 (757) 547-9531	SIZE C	CONTRACT NO. 29/14	DISK/BOX 29/14	FILENAME LF-P5.DWG	REV.
SCALE: 1"=25'	DATE 02/17/97	SHEET 4 of 4			

12:25 PM  
Recorded 24 May 1997  
DOCUMENT # 97-004368  
WILLIAMSBURG CROSSING

PLAT RECORDED  
P.B. NO. 66 PAGE 26-29