

SECOND FLOOR

SURVEYOR'S CERTIFICATE

I CERTIFY THAT THIS PLAT IS ACCURATE AND COMPLIES WITH THE PROVISIONS OF SECTION 55-79.58(A) AND (B) OF THE CODE OF VIRGINIA 1950 AS AMENDED AND THAT ALL UNITS DEPICTED HEREON HAVE BEEN SUBSTANTIALLY COMPLETED.

Stephen Romeo 7-24-96
STATE CERTIFIED LAND SURVEYOR DATE

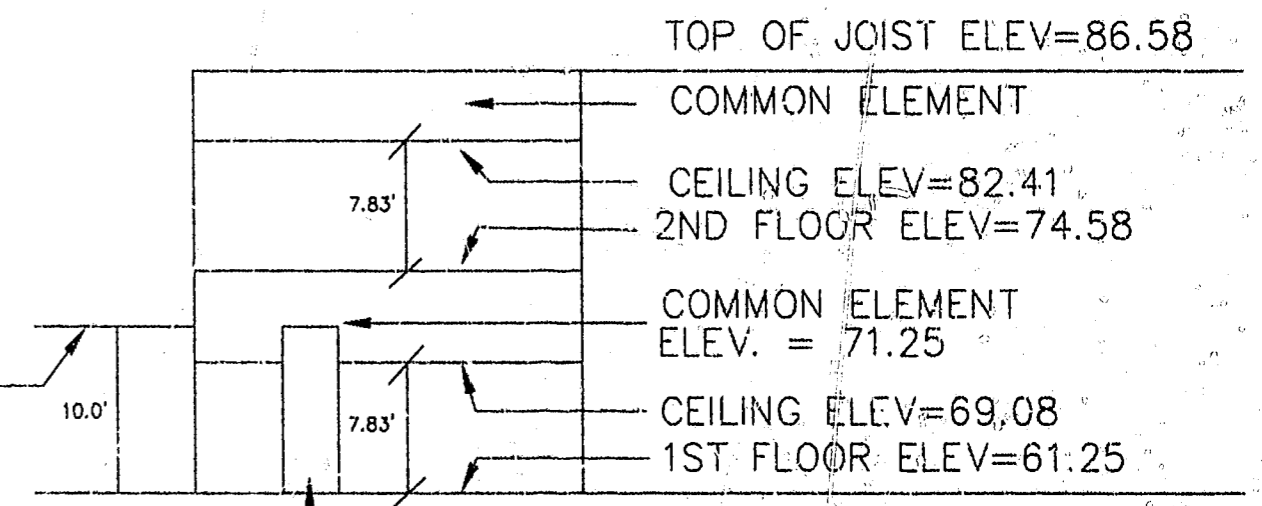

FLOOR ELEVATIONS
N.T.S.
SECTION AA

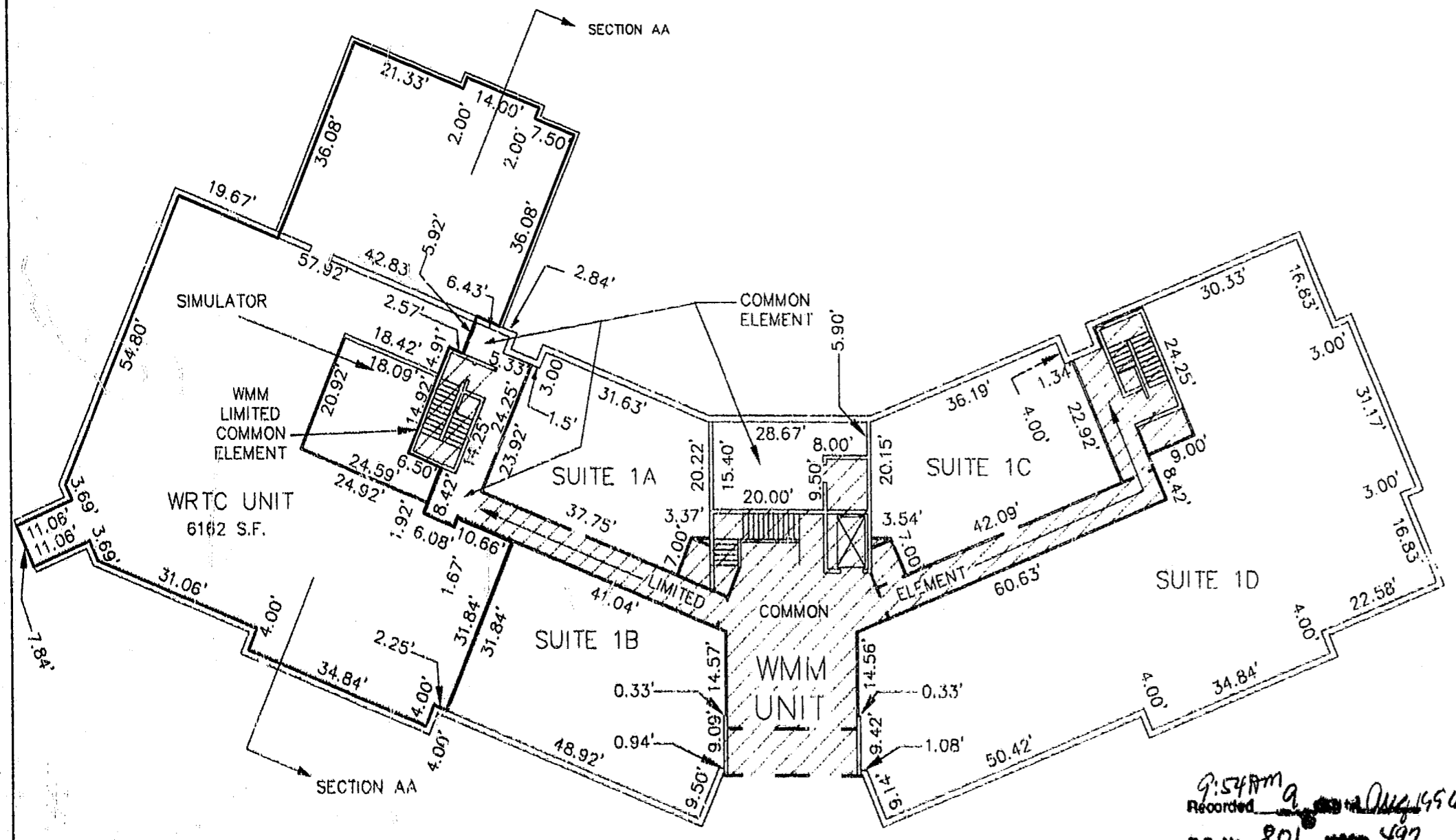

FIRST FLOOR

WMM UNIT

SUITE	SQUARE FOOTAGE
1A	1001
1B	1478
1C	1119
1D	4666
2A	5876
2B	1410
2C	5621

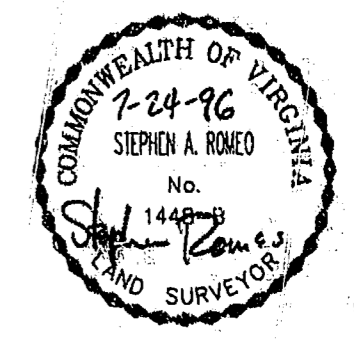

PLAT OF
WILLIAMSBURG PHYSICIANS' CENTER CONDOMINIUM
JAMES CITY COUNTY, VIRGINIA
SCALE: 1"=20' DATE: 7/2/96
SHEET 2 OF 2

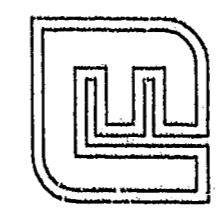

Langley and McDonald, P.C.
Engineers - Surveyors - Planners
Landscape Architects - Environmental Consultants
VIRGINIA BEACH WILLIAMSBURG

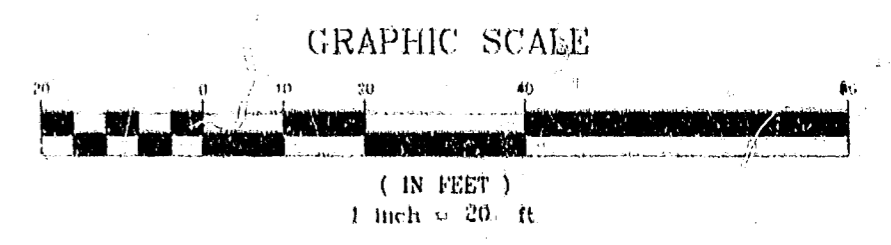

Recorded 9:54 AM 9 AUG 1996
D.B. No. 801 497
By *Charles H. Burkhardt, Reg. Clerk*