

# GREENSPRINGS PLANTATION RESORT PHASE II

BERKELEY DISTRICT  
JAMES CITY COUNTY, VIRGINIA  
DATE: OCTOBER 18, 1995 SCALE: 1"=200'

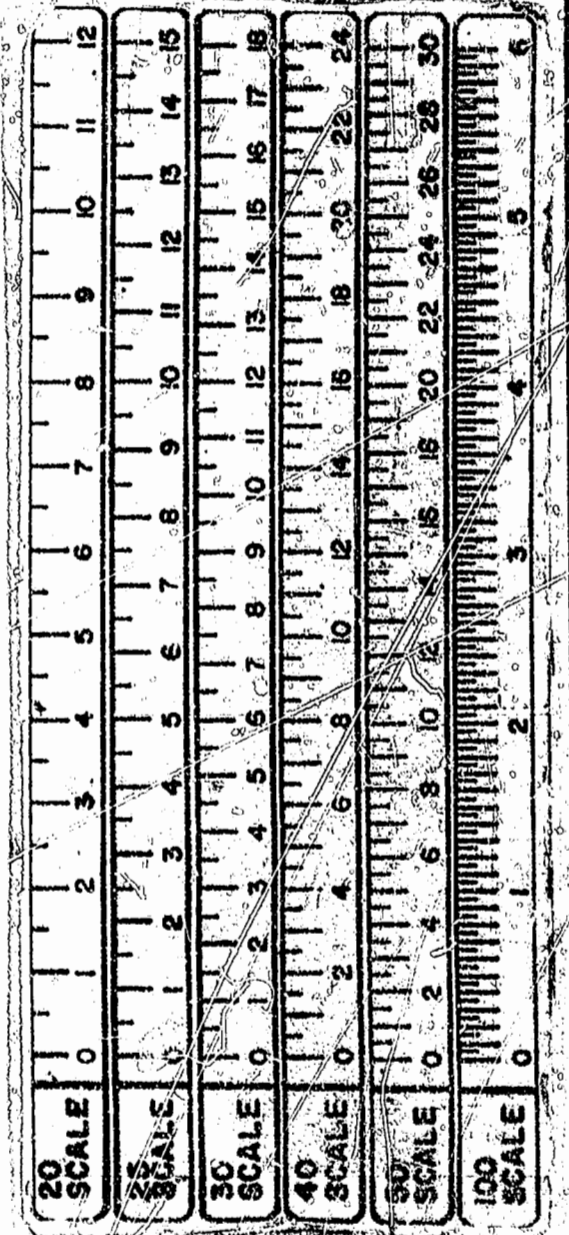

- NOTES:
- 1) BUILDINGS AND ROADS ARE SHOWN FOR CONCEPTUAL PURPOSES ONLY AND DO NOT REPRESENT PHYSICAL IMPROVEMENTS.
  - 2) LINES "A"-"B"-"C" PER PLAT RECORDED IN PB 54, PGS 69-76.
  - 3) LINES "D"-"E"-"F"-"G" PER PLAT RECORDED IN PB 58, PGS 96-102.
  - 4) LINES "H"-"I"-"J" PER PLAT TITLED "PLAT OF RIGHT-OF-WAY FOR RELOCATED STATE ROUTE 614 BEING A SUBDIVISION OF PROPERTY OF GREENSPRINGS PLANTATION, INC." BY LANGLEY AND MCDONALD, P.C. DATED 6/26/95.

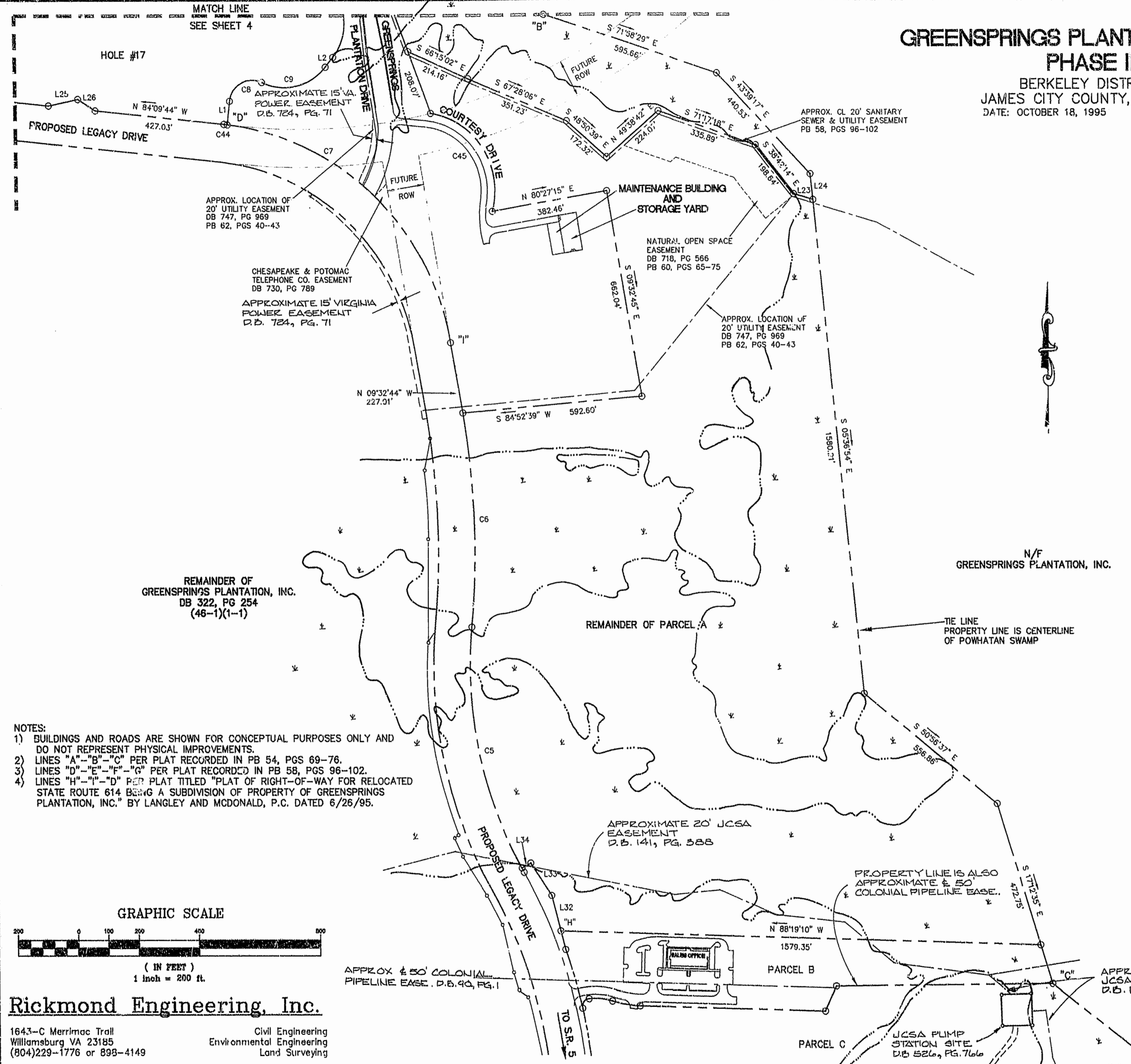
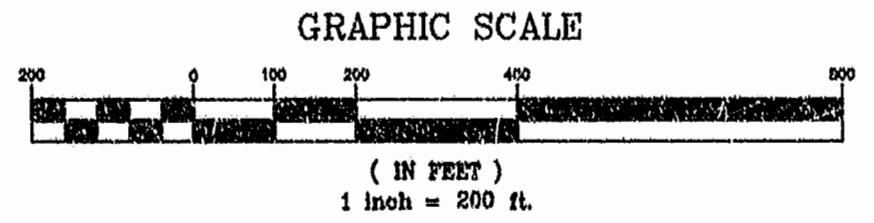

### Rickmond Engineering, Inc.

1643-C Merrimac Trail  
Williamsburg VA 23185  
(804)229-1776 or 898-4149

Civil Engineering  
Environmental Engineering  
Land Surveying

Recorded 2/24/96  
D.B. No. 725  
DB 141, PG. 388

