

GREENSPRINGS PLANTATION RESORT PHASE I

BERKELEY DISTRICT
JAMES CITY COUNTY, VIRGINIA
DATE: JUNE 1, 1995 SCALE: 1"=200'

REMAINDER OF
GREENSPRINGS PLANTATION, INC
DB 322, PG 254
(46-1)(1-1)

- NOTES:
1. BUILDINGS AND ROADS ARE SHOWN FOR CONCEPTUAL PURPOSE ONLY AND DO NOT REPRESENT PHYSICAL IMPROVEMENTS.
 2. LINES "A"-"F" PER PLAT RECORDED IN PD 54, PGS. 67-76.
 3. LINES "D"-"G" PER PLAT RECORDED IN PD 54, PGS. 96-102.
 4. LINES "H"-"I"-"J" PER PLAT TITLED "PLAT OF RIGHT-OF-WAY FOR RELOCATED STATE ROUTE 164 BEING A SUBDIVISION OF PROPERTY OF GREENSPRINGS PLANTATION, INC. BY LANGLEY AND McDONALD, P.C. DATED 11/26/95"

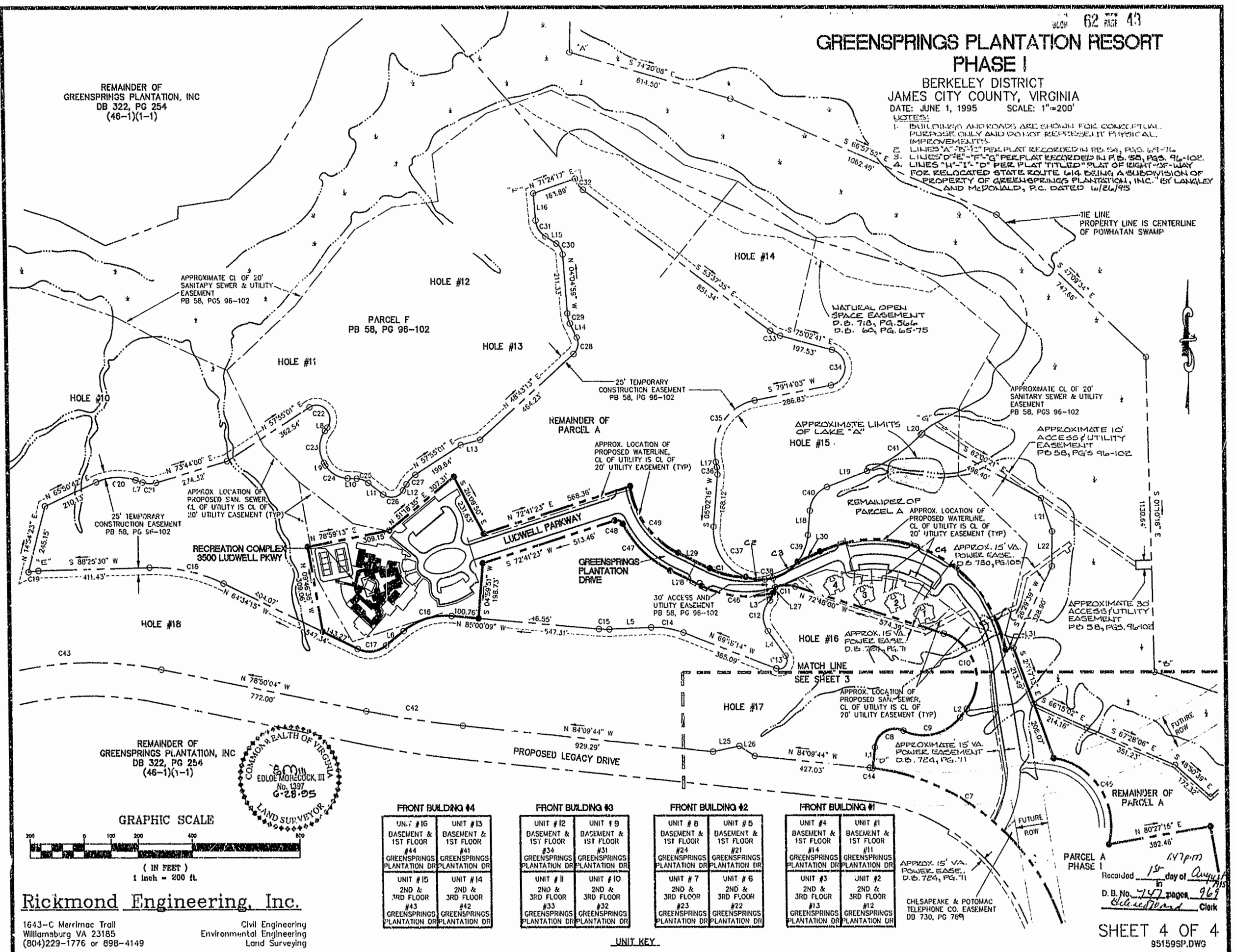

REMAINDER OF
GREENSPRINGS PLANTATION, INC
DB 322, PG 254
(46-1)(1-1)

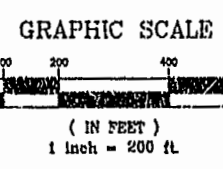

FRONT BUILDING #4		FRONT BUILDING #3		FRONT BUILDING #2		FRONT BUILDING #1	
UNIT #16	UNIT #13	UNIT #12	UNIT #9	UNIT #8	UNIT #5	UNIT #4	UNIT #1
BASEMENT & 1ST FLOOR	BASEMENT & 1ST FLOOR	BASEMENT & 1ST FLOOR	BASEMENT & 1ST FLOOR	BASEMENT & 1ST FLOOR	BASEMENT & 1ST FLOOR	BASEMENT & 1ST FLOOR	BASEMENT & 1ST FLOOR
#44	#41	#34	#31	#24	#21	#14	#11
GREENSPRINGS PLANTATION DR	GREENSPRINGS PLANTATION DR	GREENSPRINGS PLANTATION DR	GREENSPRINGS PLANTATION DR	GREENSPRINGS PLANTATION DR	GREENSPRINGS PLANTATION DR	GREENSPRINGS PLANTATION DR	GREENSPRINGS PLANTATION DR
UNIT #15	UNIT #14	UNIT #11	UNIT #10	UNIT #7	UNIT #6	UNIT #3	UNIT #2
2ND & 3RD FLOOR	2ND & 3RD FLOOR	2ND & 3RD FLOOR	2ND & 3RD FLOOR	2ND & 3RD FLOOR	2ND & 3RD FLOOR	2ND & 3RD FLOOR	2ND & 3RD FLOOR
#43	#42	#33	#32	#23	#22	#13	#12
GREENSPRINGS PLANTATION DR	GREENSPRINGS PLANTATION DR	GREENSPRINGS PLANTATION DR	GREENSPRINGS PLANTATION DR	GREENSPRINGS PLANTATION DR	GREENSPRINGS PLANTATION DR	GREENSPRINGS PLANTATION DR	GREENSPRINGS PLANTATION DR

UNIT KEY

Rickmond Engineering, Inc.

1643-C Merrimac Trail
Williamsburg VA 23185
(804)229-1776 or 898-4149

Civil Engineering
Environmental Engineering
Land Surveying

PARCEL A
PHASE I
Recorded 15th day of August 1995
D.B. No. 747 pages 967
Clerk

SHEET 4 OF 4
95159SP.DWG

