

PLAT OF
RIGHT OF WAY
FOR
RELOCATED STATE ROUTE 614
BEING A SUBDIVISION OF
PROPERTY OF
GREENSPRINGS PLANTATION, INC.
BERKELEY DISTRICT
JAMES CITY COUNTY, VIRGINIA
DATE: 8/26/95 SCALE: 1"=100'
SHEET 1 OF 9



Langleys and McDonald, P.C.

Engineers - Surveyors - Planners
Landscape Architects - Environmental Consultants
VIRGINIA BEACH WILLIAMSBURG

GRAPHIC SCALE IN FEET

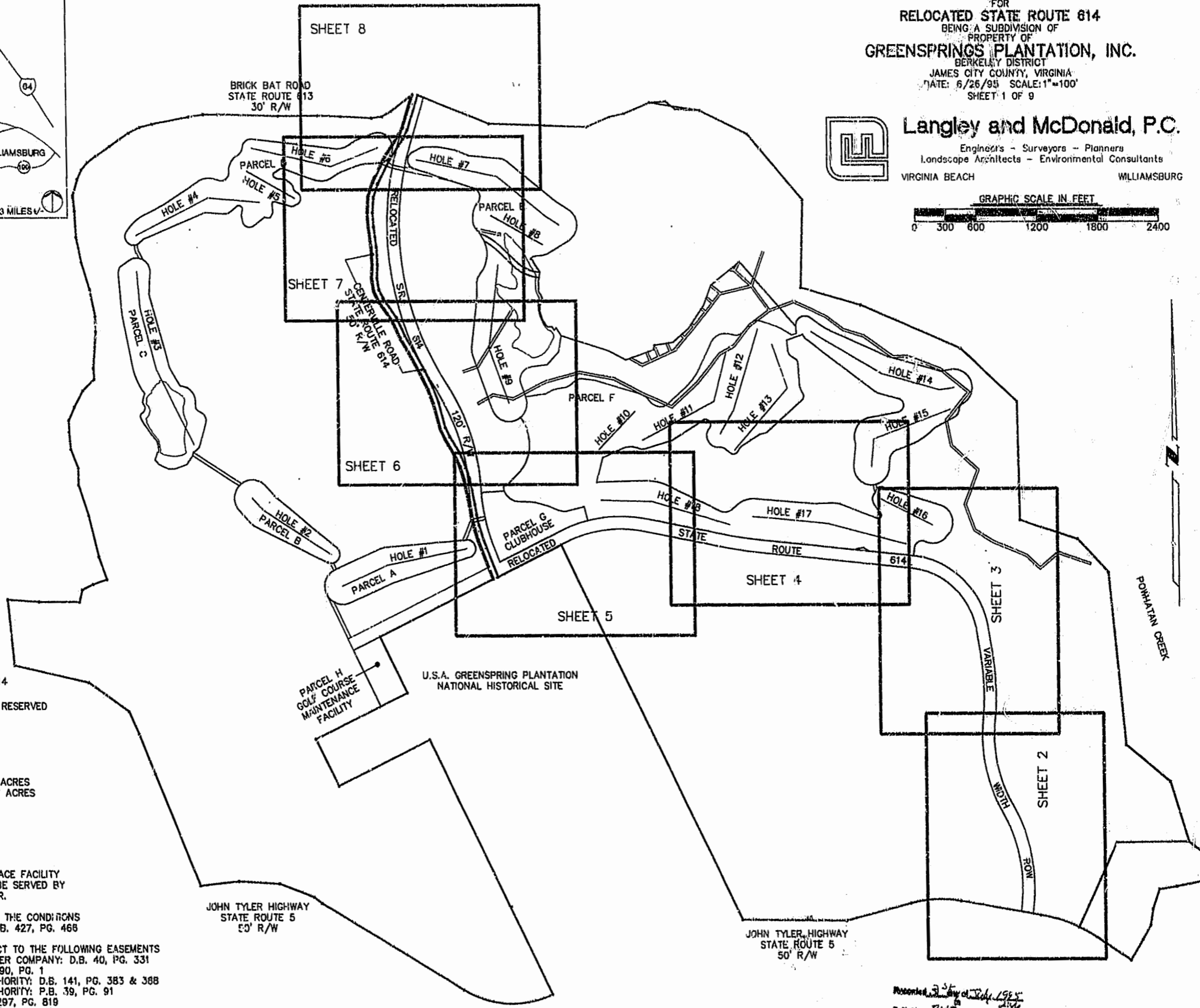
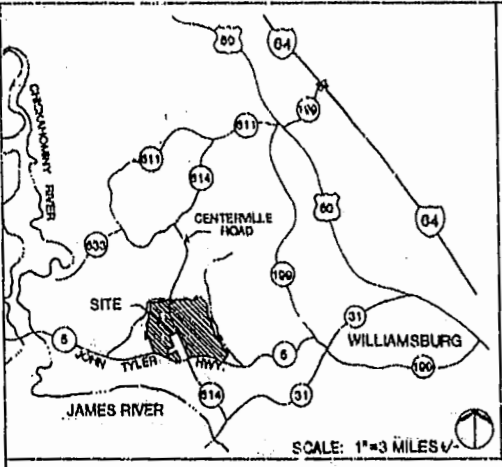
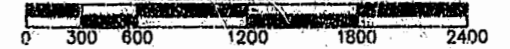

TOTAL RIGHT OF WAY AREA
39.6332 ACRES
TOTAL ROW AREA - EXISTING RTE. 614
5.6958 ACRES
TOTAL ROW EXISTING RTE 614 TO BE RESERVED
4.0003 ACRES
ADDITIONAL ROW TO BE RESERVED
1.8934 ACRES
PARCEL 1(WEST) 506.3450 ACRES
PARCEL 1(EAST) 874.9648± ACRES
ROW WITHIN PARCEL 1(WEST) 0.5035 ACRES
ROW WITHIN PARCEL 1(EAST) 37.3327 ACRES
TOTAL REMAINDER
PARCEL 1(WEST) 505.8415 ACRES
PARCEL 1(EAST) 637.6321± ACRES

- NOTES:
- 1) CLUBHOUSE AND MAINTENANCE FACILITY (PARCELS G AND H) TO BE SERVED BY PUBLIC WATER AND SEWER.
 - 2) PROPERTY IS SUBJECT TO THE CONDITIONS IN PROFER AGREEMENT D.B. 427, PG. 468
 - 3) THIS PROPERTY IS SUBJECT TO THE FOLLOWING EASEMENTS
VIRGINIA ELECTRIC & POWER COMPANY: D.B. 40, PG. 331
COLONIAL PIPELINE: D.B. 90, PG. 1
JAMES CITY SERVICE AUTHORITY: D.B. 141, PG. 383 & 388
JAMES CITY SERVICE AUTHORITY: P.B. 39, PG. 91
DAVID M. MURRAY: P.B. 297, PG. 819
SANITARY SEWER: P.B. 450, PG. 721

PLAT RECORDED IN
P.B. NO. 62, PAGE 26, 34

Presented by City of York 1995
B. B. No. 747
W. B. McDonald
W. B. McDonald
W. B. McDonald
W. B. McDonald