

I DO HEREBY CERTIFY THAT I HAVE SURVEYED THE SUBMITTED LAND AND DO FURTHER CERTIFY THAT, TO THE BEST OF MY KNOWLEDGE AND BELIEF, THIS PLAT SHOWING LOCATION AND DIMENSIONS OF THE SUBMITTED LAND IS ACCURATE AND THE PLAT COMPLIES WITH THE PROVISIONS OF SECTION 55-79.5B (A) OF THE CODE OF VIRGINIA AS AMENDED. ALL UNITS HAVE BEEN SUBSTANTIALLY COMPLETED.

AES, a professional corporation

BY: Ronald W. Eads
RONALD W. EADS, L.S. #1948

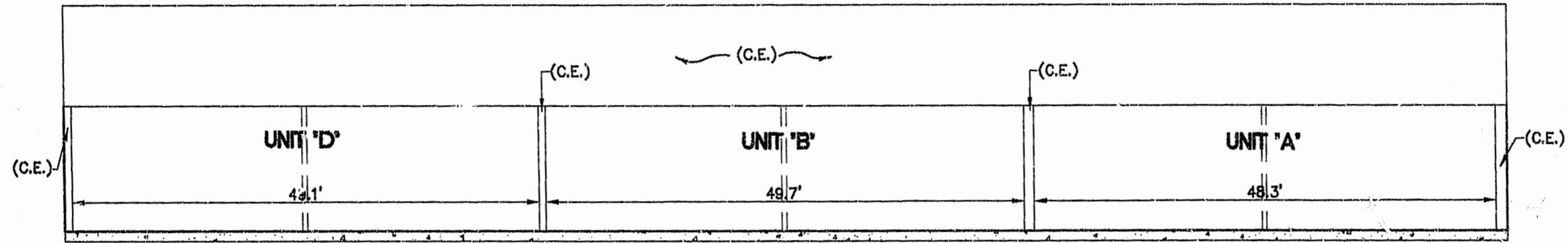
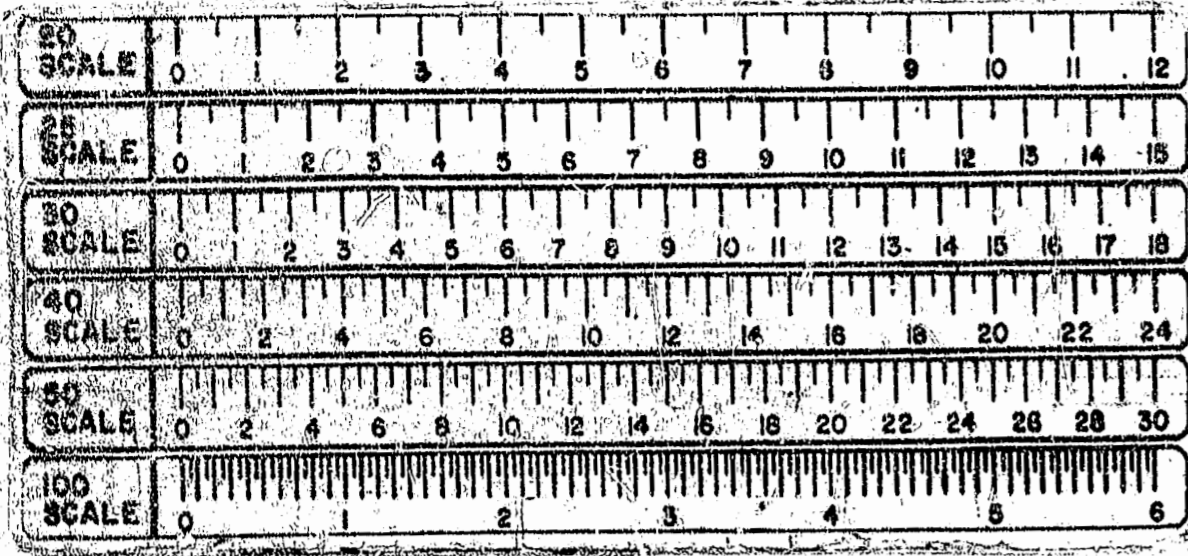

SECTION 2
SCALE: 1"=5'

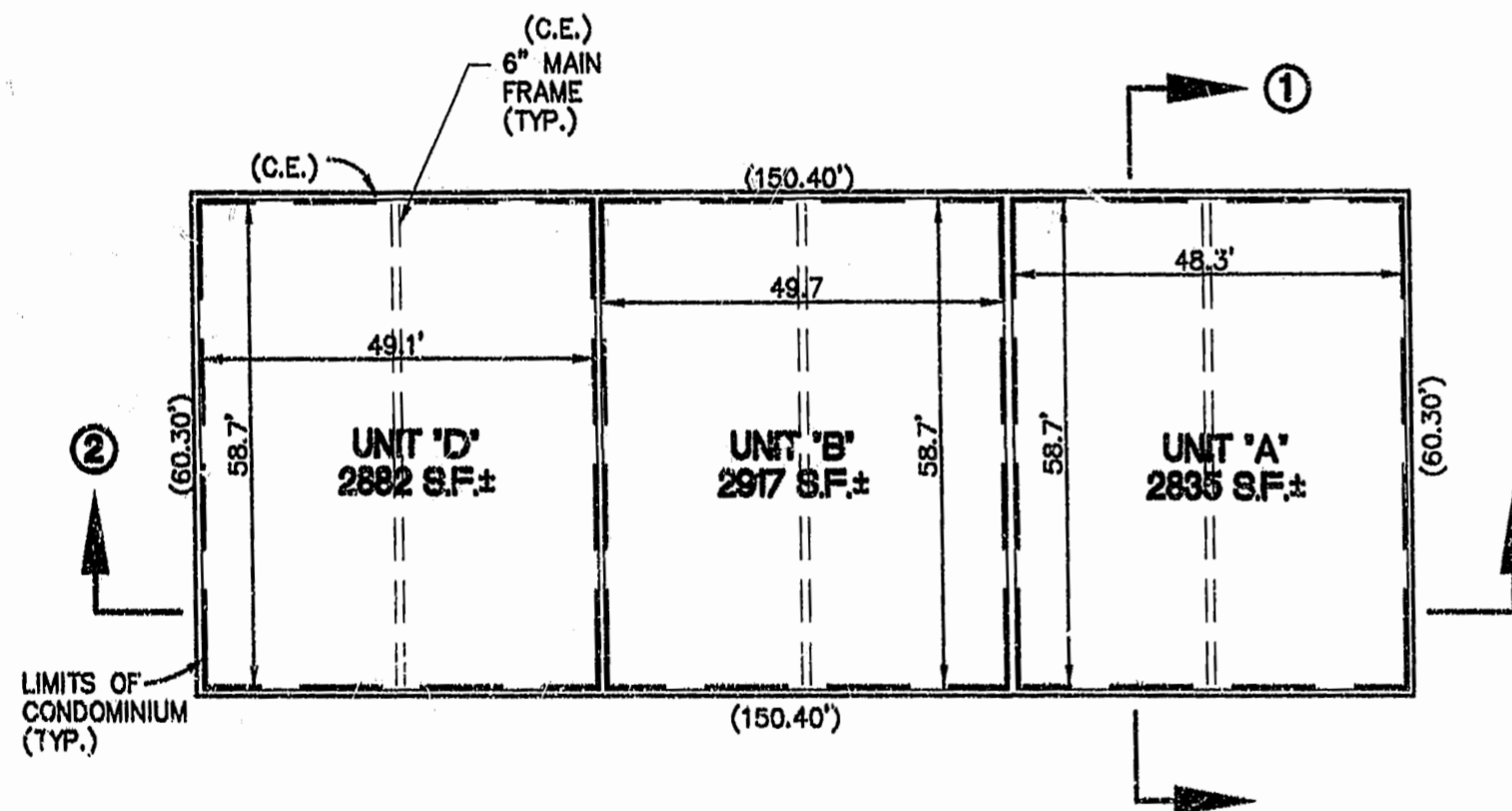

PLAN VIEW
SCALE: 1"=5'

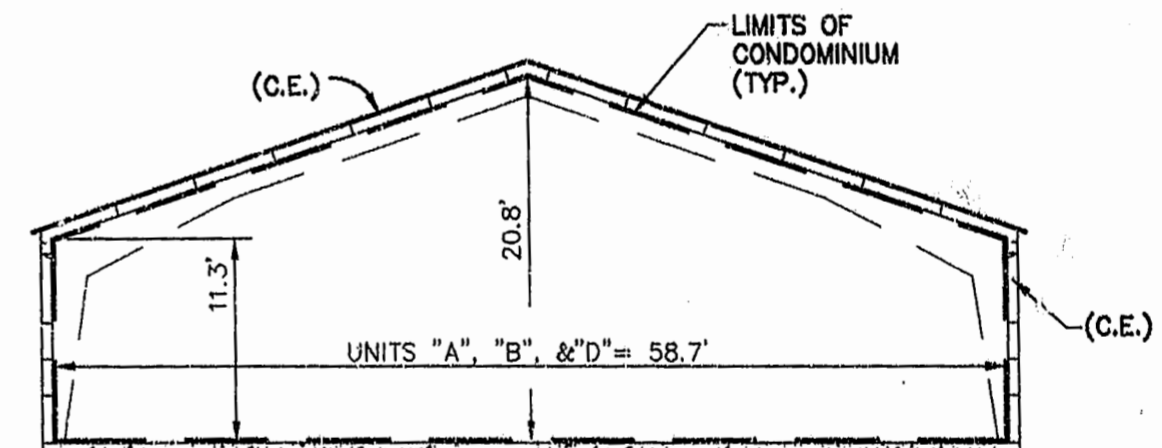

SECTION 1
SCALE: 1"=5'

11:36 AM
Recorded 7 day of June, 1995
P.B. No. 740 pages 8/2
Richard Moore Clerk

PLAT RECORDED IN
P.B. NO. 601 PAGE 98, 99

05.24.95-10-24 7459CPG MLP

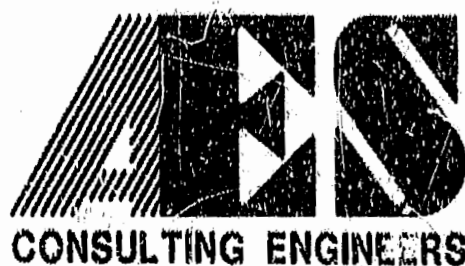

5248 Olde Towne Road, Suite 1
Williamsburg, Virginia 23188
(804) 253-0040
Fax (804) 220-8994

EXHIBIT 'B'
PLAT OF
TEWNING BUSINESS CENTER CONDOMINIUM
UNITS A, B, & D
OWNER/DEVELOPER: ROBERT F. & CATHERINE J. RIPLEY
BERKELEY DISTRICT JAMES CITY COUNTY VIRGINIA

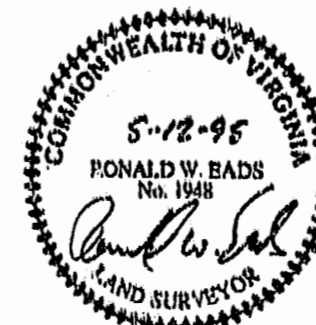

No.	DATE	REVISION / COMMENT / NOTE	BY

Designed	Drawn
Scale	Date
AS NOTED	5/12/95
Project No.	
7459-C	
Drawing No.	
2 OF 2	