

# OWNER'S CERTIFICATE

THE SUBDIVISION OF LAND SHOWN ON THIS PLAT AND KNOWN AS CHADWICKE ESTATES IS WITH FREE CONSENT AND IN ACCORDANCE WITH THE DEEDS OF THE UNDERSIGNED OWNERS, PROPRIETORS AND OR TRUSTEES.

DATE 5/31/94  
DATE 5/31/94  
DATE \_\_\_\_\_  
DATE \_\_\_\_\_

# CERTIFICATE OF NOTARIZATION

STATE OF VIRGINIA

CITY/COUNTY OF James City, Mary S. Cashen  
A NOTARY PUBLIC IN AND FOR THE CITY/COUNTY AND STATE AFORESAID, DO HEREBY CERTIFY THAT THE PERSON(S) WHOSE NAMES ARE SIGNED TO THE FOREGOING WRITING HAVE ACKNOWLEDGED THE SAME BEFORE ME IN THE CITY/COUNTY AFORESAID, GIVEN UNDER MY HAND THIS 31 DAY OF May, 1994. MY COMMISSION EXPIRES 8-31-96

Mary S. Cashen  
NOTARY PUBLIC

# CERTIFICATE OF SOURCE OF TITLE

THE PROPERTY SHOWN ON THIS PLAT WAS CONVEYED BY ANN MARTIN HOBSON TO MICHAEL L. & WENDY T. BROWN BY DEED DATED 04-21-94 AND RECORDED IN THE OFFICE OF THE CLERK OF CIRCUIT COURT OF THE COUNTY OF JAMES CITY IN DEED BOOK 682 PAGE 188.

# ENGINEERS OR SURVEYOR'S CERTIFICATE

I HEREBY CERTIFY THAT TO THE BEST OF MY KNOWLEDGE OR BELIEF, THIS PLAT COMPLIES WITH ALL OF THE REQUIREMENTS OF THE BOARD OF SUPERVISORS AND ORDINANCES OF THE COUNTY OF JAMES CITY, VIRGINIA, REGARDING THE PLATTING OF SUBDIVISIONS WITHIN THE COUNTY.

DATE 4/24/94 Thomas C. Sublett  
THOMAS C. SUBLETT L.S.#1886

# CERTIFICATE OF APPROVAL

THIS SUBDIVISION IS APPROVED BY THE UNDERSIGNED IN ACCORDANCE WITH WITH EXISTING SUBDIVISION REGULATIONS AND MAY BE ADMITTED TO RECORD.

DATE 4/27/94 Michael B. Taylor  
VIRGINIA DEPARTMENT OF TRANSPORTATION  
DATE 5/31/94 Colin Lee  
VIRGINIA DEPARTMENT OF HEALTH  
DATE 6/1/94 [Signature]  
SUBDIVISION AGENT OF JAMES CITY COUNTY

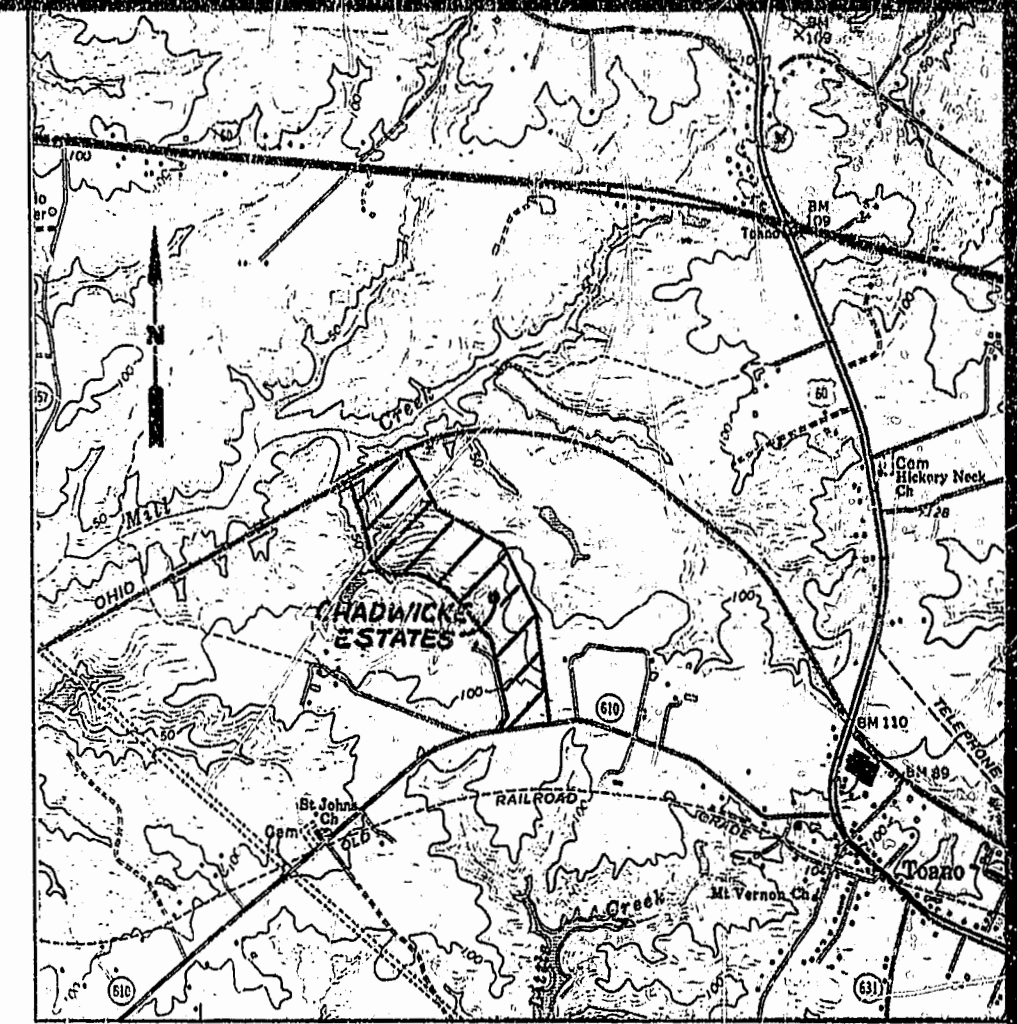

LOCATION MAP

SCALE: = 1" = 2000'

# GENERAL NOTES:

TOTAL AREA = 2,919,802 SQ. FT./ 67.0 AC.  
LOT AREA = 2,910,087 SQ. FT./ 66.8 AC.  
R/W DEDICATION = 9,715 SQ. FT./ 00.2 AC.  
ZONING: A-1  
TM 12-3 ; PARCEL 1-20

# STATE OF VIRGINIA, JAMES CITY COUNTY

IN THE CLERK'S OFFICE OF THE CIRCUIT COURT FOR THE COUNTY OF JAMES CITY THE 7th DAY OF June, 1994. THIS MAP WAS PRESENTED AND ADMITTED TO RECORD AS THE LAW DIRECTS IN PLAT BOOK 59, PAGE 50 & 51.  
TESTE [Signature] CLERK

Recorded: 7th June, 1994  
11:22 AM  
DB No. 690 PAGES 59  
[Signature] Clerk

PLAT RECORDED IN  
DB NO. 59 PAGE 50 & 51

COMMISSION NO. **5496**



ENGINEERS • ARCHITECTS • SURVEYORS  
INTERIOR DESIGNERS • PLANNERS  
P.O. BOX 3505 WILLIAMSBURG, VIRGINIA 23187  
(804)253-0673 (804)874-5015

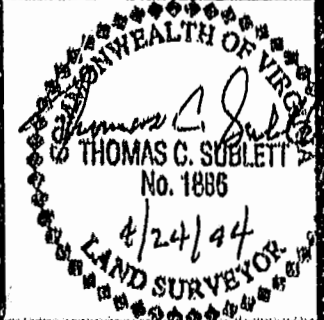

REF. DB 66/539-541  
DB 28/210  
WB 8/368  
VEPCO EASEMENT  
DB 99/582  
PB 3/22  
DB 682/188

SUBDIVISION PLAT  
OF  
CHADWICKE ESTATES  
STONEHOUSE DISTRICT

JAMES CITY COUNTY VIRGINIA

DATE APRIL 22, 1994 DESIGNED TCS DRAWN LBA SCALE AS SHOWN