

**LEGACY GOLF LINKS  
AT GREENSPRINGS** BOOK 58 PAGE 96  
BEING A  
SUBDIVISION OF PROPERTY OF  
**GREENSPRINGS PLANTATION, INC.**  
BERKELEY DISTRICT  
JAMES CITY COUNTY, VIRGINIA  
FEBRUARY 18, 1994  
SCALE: 1"=600'  
SHEET 1 OF 7

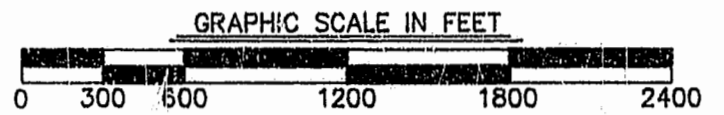

**Langley and McDonald, P.C.**  
Engineers - Surveyors - Planners  
Landscape Architects - Environmental Consultants  
VIRGINIA BEACH WILLIAMSBURG



**SPECIAL FLOOD HAZARD AREAS INUNDATED BY 100-YEAR FLOOD**  
 ZONE A: NO BASE FLOOD ELEVATIONS DETERMINED  
 ZONE AE: BASE FLOOD ELEVATIONS DETERMINED  
**OTHER FLOOD AREAS**  
 ZONE X: AREAS OF 500-YEAR FLOOD, AREAS OF 100-YEAR FLOOD WITH AVERAGE DEPTHS OF LESS THAN 1 FOOT OR WITH DRAINAGE AREAS LESS THAN 1 SQUARE MILE; AND AREAS PROTECTED BY LEVEES FROM 100-YEAR FLOOD.  
 ZONE X: AREAS DETERMINED TO BE OUTSIDE 500-YEAR FLOOD-PLAIN.

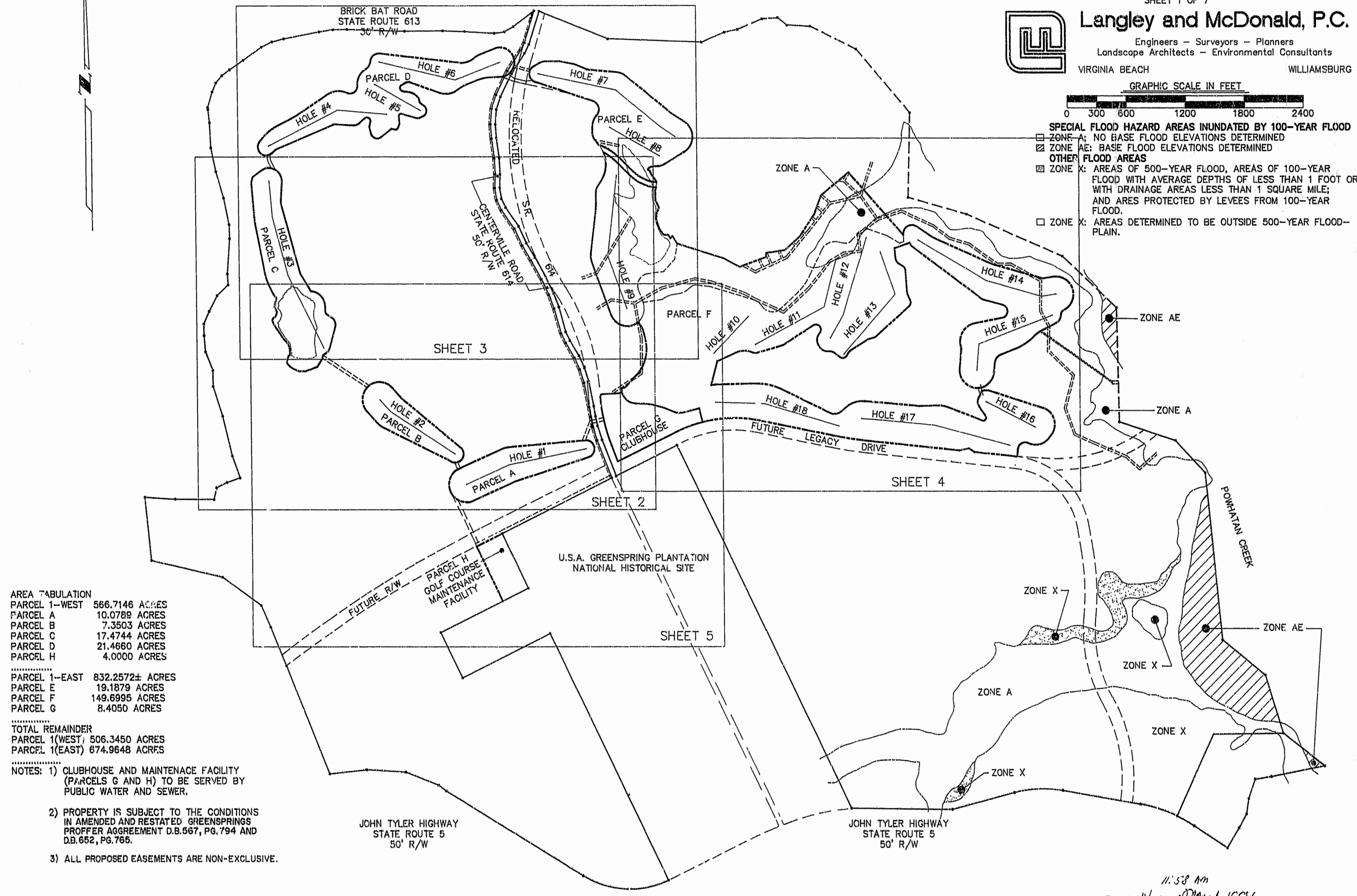

**AREA TABULATION**

PARCEL 1--WEST	566.7146 ACRES
PARCEL A	10.0789 ACRES
PARCEL B	7.3503 ACRES
PARCEL C	17.4744 ACRES
PARCEL D	21.4660 ACRES
PARCEL H	4.0000 ACRES

PARCEL 1--EAST	832.2572± ACRES
PARCEL E	19.1879 ACRES
PARCEL F	149.6995 ACRES
PARCEL G	8.4050 ACRES

**TOTAL REMAINDER**  
 PARCEL 1(WEST) 506.3450 ACRES  
 PARCEL 1(EAST) 674.9648 ACRES

- NOTES:**
- 1) CLUBHOUSE AND MAINTENANCE FACILITY (PARCELS G AND H) TO BE SERVED BY PUBLIC WATER AND SEWER.
  - 2) PROPERTY IS SUBJECT TO THE CONDITIONS IN AMENDED AND RESTATED GREENSPRINGS PROFFER AGREEMENT D.B.567, PG.794 AND D.B.652, PG.765.
  - 3) ALL PROPOSED EASEMENTS ARE NON-EXCLUSIVE.

FILED RECORDED IN  
P.B. NO. 58 PAGE 96-102

11:58 AM  
 Recorded 24 day of March 1994  
 D.B. No. 58-102-100000-100000  
 By *[Signature]* Clerk  
 By *[Signature]* Dep. Clerk