

WE HEREBY CERTIFY THAT THE ABOVE ADDED TO THE ORIGINAL PLAN OR PORTION THEREOF AND THAT THE SAME COMPLY WITH ALL CITY ORDINANCES AND ACCURATE AND THEY COMPLY WITH SECTION 45-75.18(B) OF THE CODE OF VIRGINIA, AS AMENDED. ALL STRUCTURE ARE COMPLETE.

AEB CONSULTING ENGINEERS  
 BY: *[Signature]*  
 G. T. WILSON, JR., C.E.N.

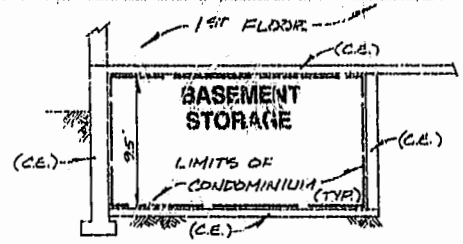

**SECTION 8**  
 SCALE: 1" = 8'

**AREA TABULATION - BASEMENT**

BASEMENT STORAGE	372.40 SQ. FT.±
COMMON ELEMENT (C.E.) - WALLS, CHIMNEY & UTILITY ROOMS	2928.00 SQ. FT.±
CRAWL SPACE	3107.16 SQ. FT.±
<b>TOTAL AREA BASEMENT</b>	<b>7505.56 SQ. FT.±</b>

(C.E.) = COMMON ELEMENT

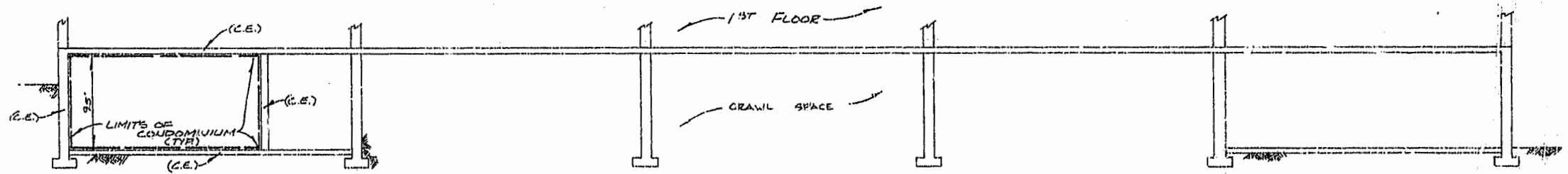

**SECTION 7**  
 SCALE: 1" = 8'

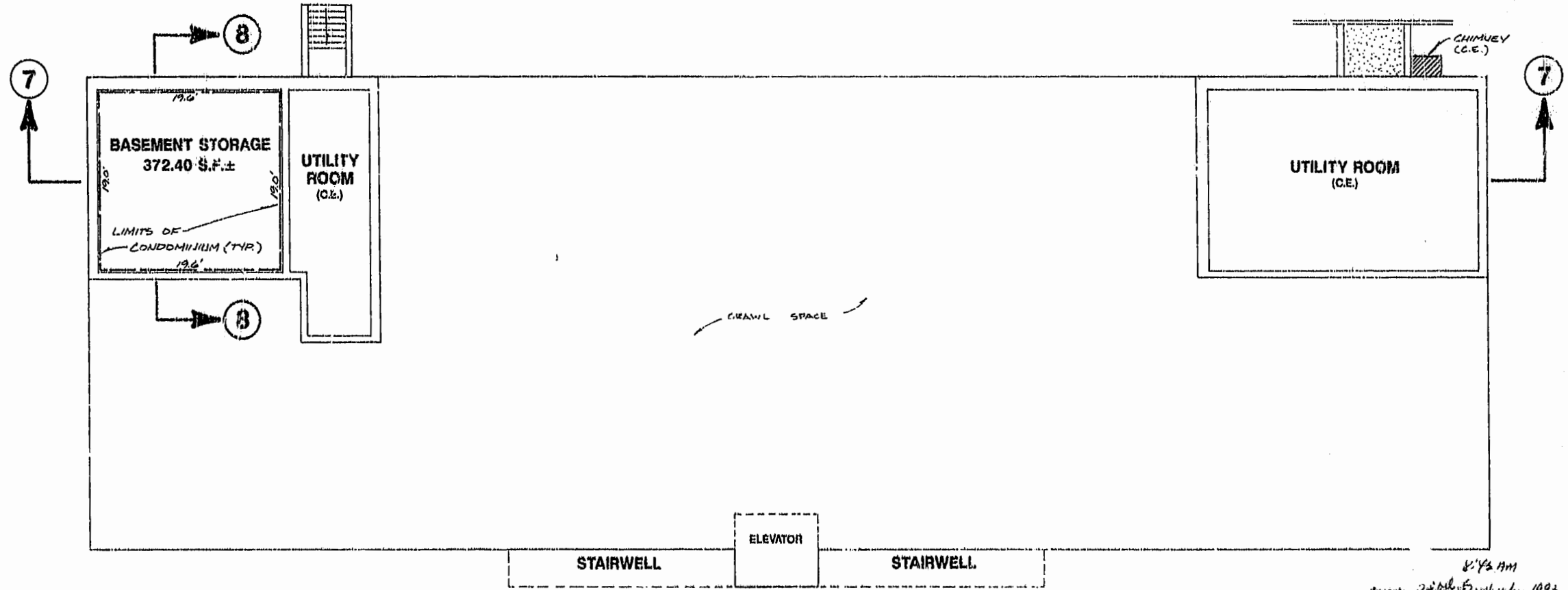

**PLAN VIEW - BASEMENT**  
 SCALE: 1" = 8'

8/12 AM  
 Revision of 11/23/91  
 Drawing No. 105  
 11/23/91  
 G. T. Wilson, Jr., C.E.N.

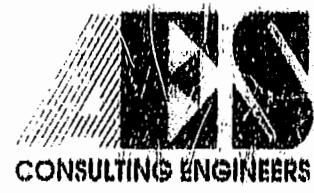

5248 Old Towne Road, Suite 1  
 Williamsburg, Virginia 23188  
 (804) 253-0040  
 Fax (804) 220-8004

EXHIBIT B  
**WILLIAMSBURG PROFESSIONAL CENTRE CONDOMINIUMS**  
 OWNER/ DEVELOPER: ALVIN P. ANDERSON, TRUSTEE  
 CITY OF WILLIAMSBURG, VIRGINIA



NO.	DATE	REVISION / COMMENT / NOTE	BY

Designed AEB	Drawn RWE
Scale NOTED	Date 11/23/91
Project No. 7240	
Drawing No. 4 OF 4	