

WE HEREBY CERTIFY THAT WE HAVE SURVEYED ALL OF THE UNITS OR PORTIONS THEREOF AND DO FURTHER CERTIFY THAT THESE PLANS ARE ACCURATE AND THEY COMPLY WITH SECTION 55-79.54(B) OF THE CODE OF VIRGINIA, AS AMENDED. ALL STRUCTURES ARE SUBSTANTIALLY COMPLETE.

ARCHITECTURAL ENGINEERS

BY: S. F. WILSON, JR.
S. F. WILSON, JR., C.E.I.

(C.E.) - COMMON ELEMENT

AREA TABULATION - 2ND LEVEL

SUITE 2-A	2670.33 SQ. FT.±
SUITE 2-B	1037.51 SQ. FT.±
SUITE 2-C	2573.96 SQ. FT.±
COMMON ELEMENTS (C.E.) - WALLS, LOBBY, STAIRS, JANITORS CLOSET, ELEVATOR, CHIMNEY	1223.76 SQ. FT.±
TOTAL AREA 2ND LEVEL	7605.56 SQ. FT.±

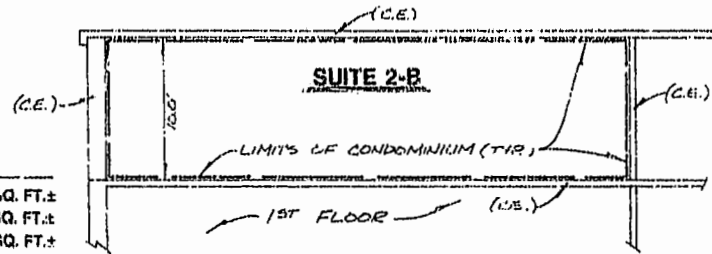

SECTION 5
SCALE: 1" = 8'

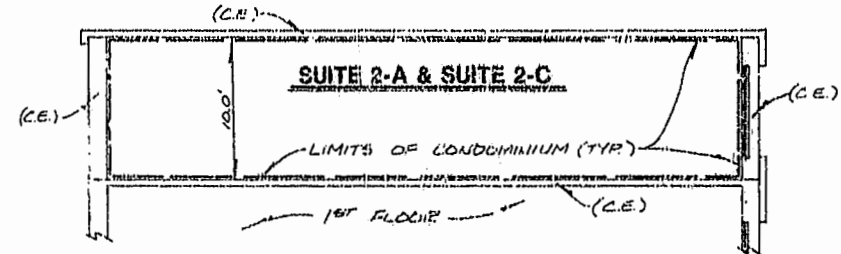

SECTION 6
SCALE: 1" = 8'

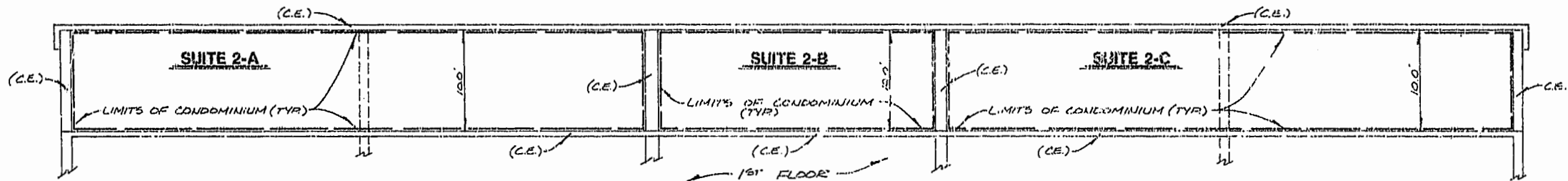

SECTION 4
SCALE: 1" = 8'

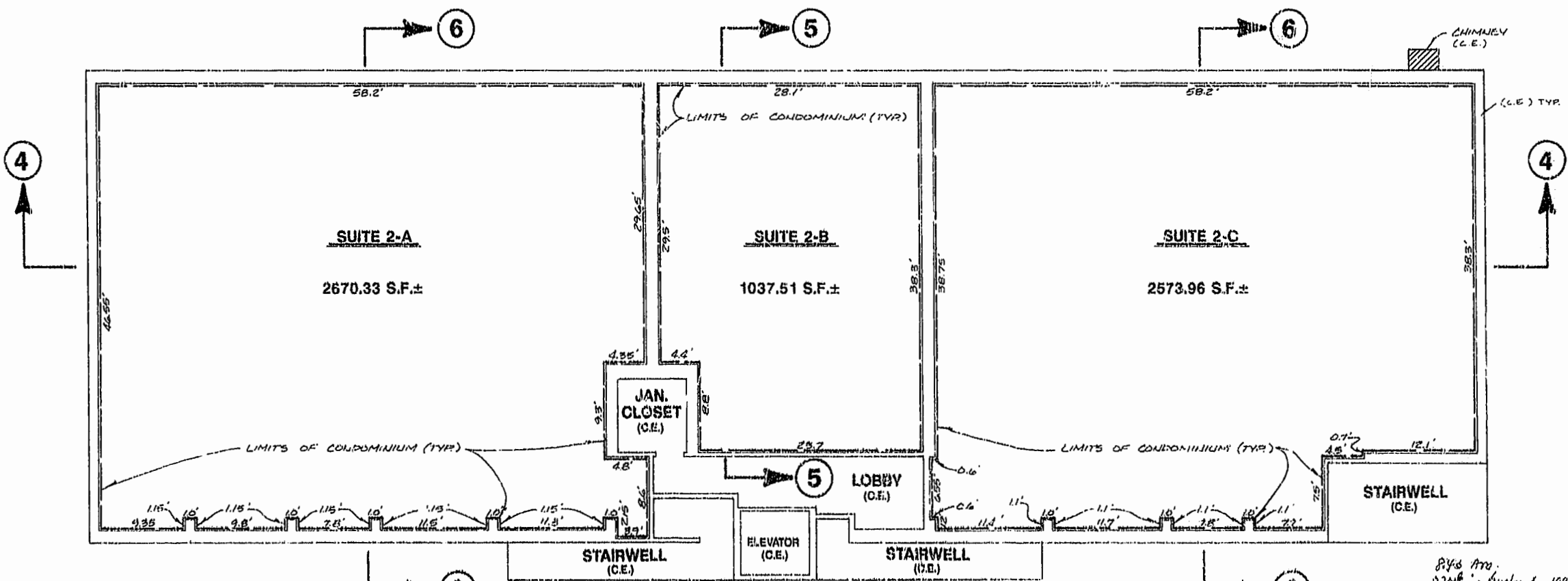

PLAN VIEW - 2ND FLOOR
SCALE: 1" = 8'

876 Ave.
Received 22nd day of September, 1993
D. 105.0000.617
S. F. WILSON, JR. C.E.I.

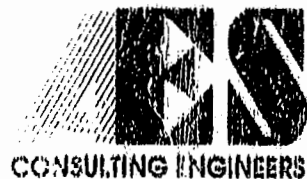

5248 Olde Towne Road, Suite 1
Williamsburg, Virginia 23188
(804) 253-0040
FAX (804) 220-8994

EXHIBIT B
WILLIAMSBURG PROFESSIONAL CENTRE CONDOMINIUMS
OWNER/DEVELOPER: ALVIN P. ANDERSON, TRUSTEE
CITY OF WILLIAMSBURG VIRGINIA

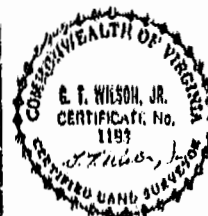

No.	DATE	REVISION / COMMENT / NOTE	BY

Designed AEG	Drawn RWL
Scale NOTED	Date 12/23/01
Project No. 7240	
Drawing No. 3 OF 4	