

# POWHATAN CROSSING - SECTION III

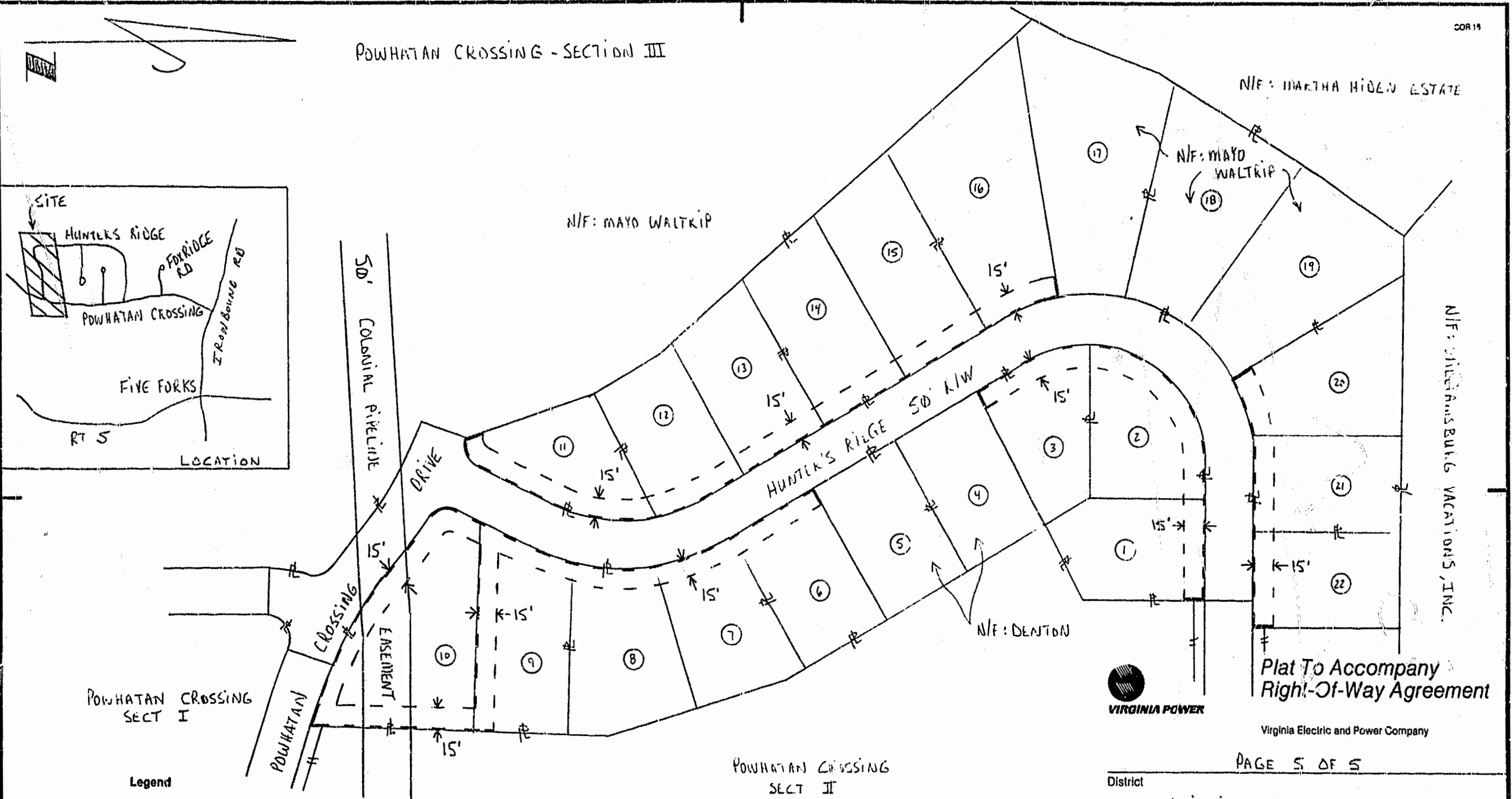

Plat To Accompany Right-Of-Way Agreement

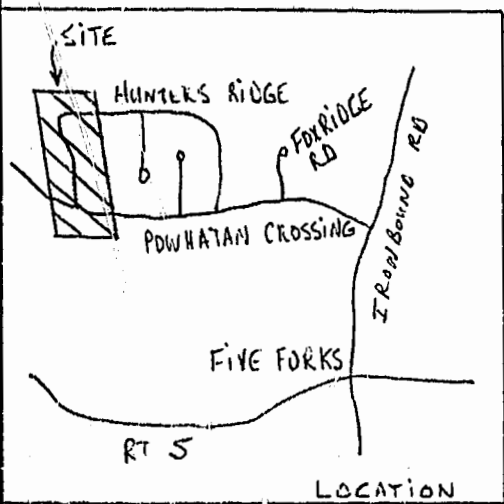

Virginia Electric and Power Company

PAGE 5 OF 5

### Legend

- Location Of Boundary Line Of Designated Right-of-Way 15' IN WIDTH.
- ||| EXISTING VA POWER EASEMENT

11:08 Am  
 Recorded 27th day of August, 1993  
 B & N No. 637 in pages 498  
*Debra M. ...* Clerk

RIGHT-OF-WAY ON PROPERTY OF:  
 POWHATAN CROSSING, INC.  
 C. LEWIS WALTRIP II, PRESIDENT  
 OWNER'S INITIALS \_\_\_\_\_

District	WILLIAMSBURG UNDERGROUND		
District-Township-Borough	County-City	State	
Office	BERKELEY	JAMES CITY	VA.
Estimate Number	WILLIAMSBURG	Plat Number 28-93-0121	
	78-308-00080	Grid Number M1736	
Date	8-9-93	By <i>Michael W. Jones</i>	