

NOTE:  
VDOT IS NOT RESPONSIBLE OR LIABLE  
FOR DETENTION BASINS OR THEIR STRUCTURES

WILLIAMSBURG-JAMES CITY COUNTY PUBLIC SCHOOLS  
DB 548 PG 582

OPEN SPACE/CONSERVATION EASEMENT

N/F DAVID H. & M. ELIZABETH JEFFREY  
TAX MAP (22-2)(1-23A)

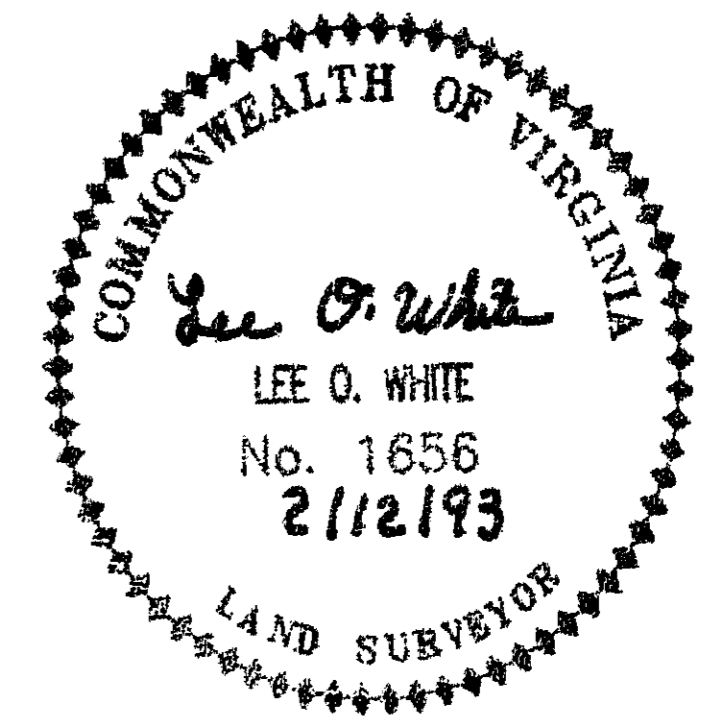

SEE SHEET 4 FOR LINE & CURVE TABLES

# TOANO TRACE

JAMES CITY COUNTY, VIRGINIA

SHEET 2 of 4

10:57 Am.  
Recorded 23rd day of April, 1993  
in  
D. J. No. 614, pages 646  
*Delores Clark* Clerk

SEE SHEET #3 FOR CONTINUATION

**Draper Aden Associates**  
CONSULTING ENGINEERS/SURVEYORS  
4136 INNSLAKE DRIVE  
GLEN ALLEN, VIRGINIA 23060

REVISIONS:	DATE: 6/31/1992	SCALE: 1" = 50'
	DRAWN: PCB	CHECKED: LLW
PROJECT No. P-20585		

